

Retractable Ramp System

01110-1, 01120-1, 01130-1

Installation Instructions



Questions, problems, missing parts?
DO NOT RETURN TO YOUR RETAILER.
Please call our customer service department at:

289-878-9520

Tools required:

- 1/2" or 3/8" electric drill
- 3/4" socket and ratchet drive
- masking tape (if assistant not available)
- 3/4" wrench
- measuring tape
- gloves, safety glasses

ATTENTION: wear gloves and safety glasses during installation

CAUTION: sharp edges

Bedliner? Depending on the design of your bedliner, you may have to fill the air space between the bedliner and the front of the bed (Step 2). We suggest using either pressure-treated wood or plastic-wood composite.

Ramp Parts List

ITEM NO.	PART NUMBER	DESCRIPTION	QTY.
1	BT5550	Main Tunnel	1
2	BT5540	Ramp Section	1
3	BT5560	Nut Channel	1
4	BT5555	Sliding Channel	2
5	BT1128	Mounting Ramp Plate	1
6	BT5545	Ramp Gate Pin	1
7	BT1116	Roller Axle	1
8	BT1118	Brass Roller	2
9	FW-0500-Z	1/2 Flat Washer	6
10	HH-0500-1500-Z	1/2 x 1-1/2 Bolt	2
11	HH-0500-1250-Z	1/2 x 1-1/4 Bolt	2
12	NIN-0500-Z	1/2 Nylon Insert Nut	2
13	RC-0125-2500-Z	R-Clip	1
14	HH-0250-1000-Z	1/4 x 1 Bolt	2
15	NIN-0250-Z	1/4 Nylon Insert Nut	2

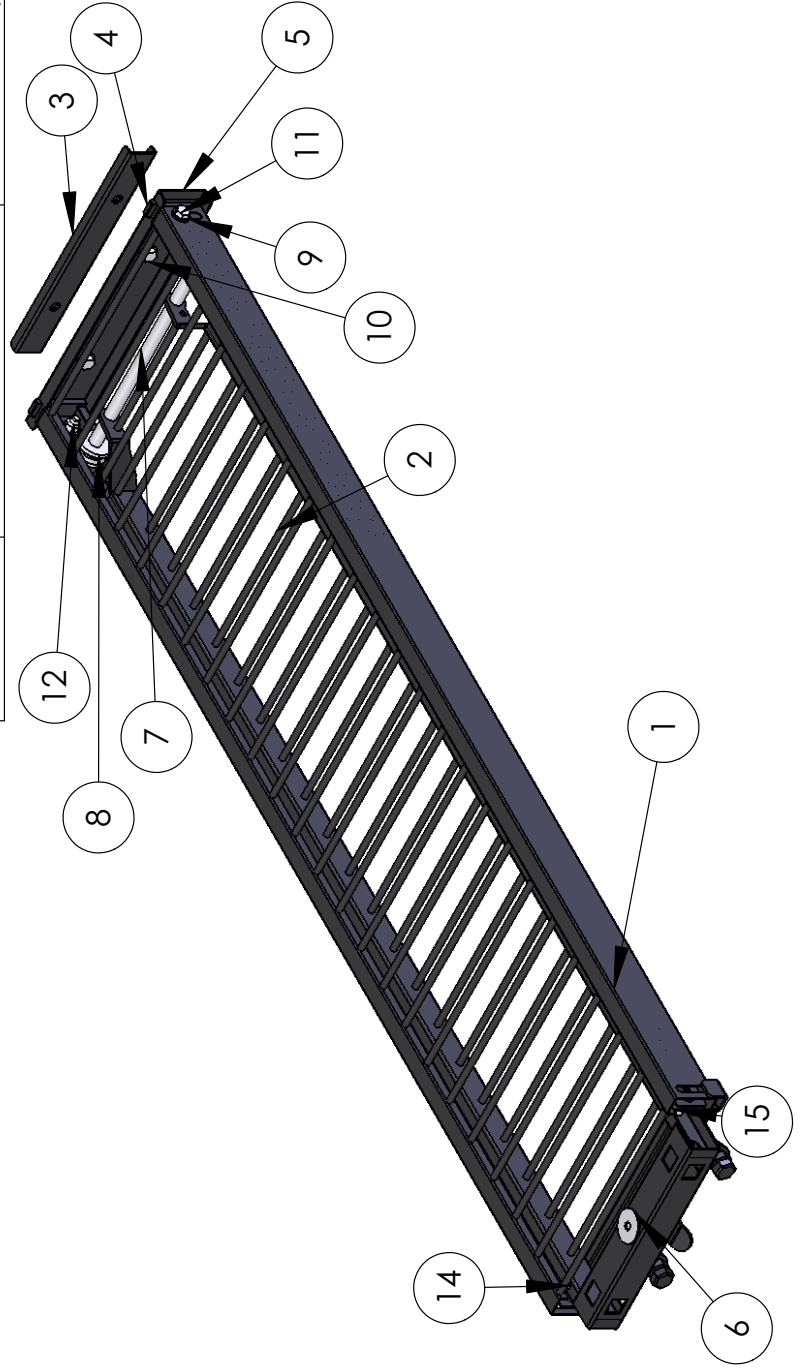

Full-Size System Tailgates Parts List

ITEM NO.	PART NUMBER	DESCRIPTION	QTY.
1	BT5530	Gate Insert	1
2	BT5515	Gate Side Tube	2
3	BT5535	Locking Bar	2
4	BT1109	Ramp Handle	1
5	BT1132	2" ABS Pipe	1
6	CS-1500-4500-SS	Tailgate Spring	2
7	RP-0250-2000-SS	1/4 x 2 SS Spring Roll Pin	2
8	HH-0500-1000-Z	1/2 x 1 Bolt	4
9	NIN-0500-Z	1/2 Nylon Insert Nut	4

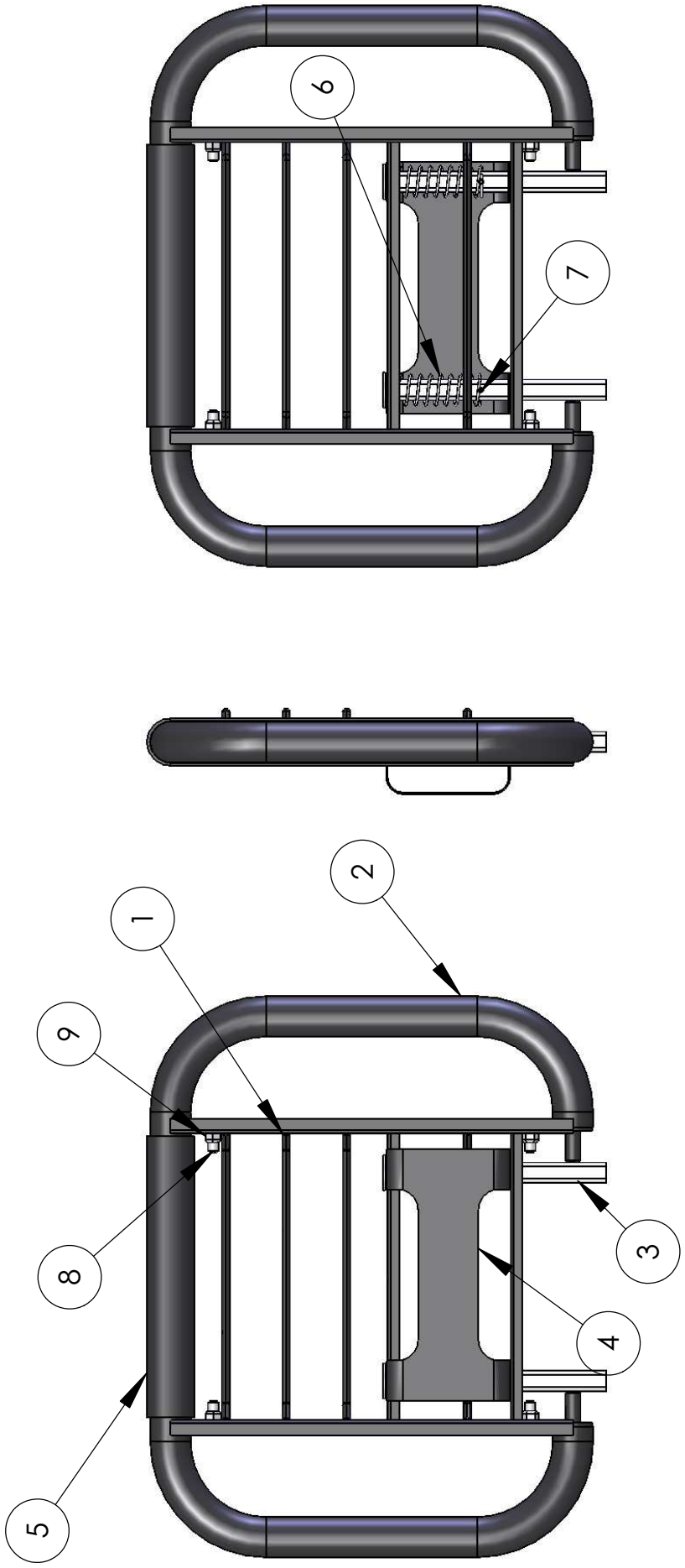

Step 1: Drill rear bed holes

Remove your stock tailgate. Place the drill template on the back ledge of the truck box as shown in **Figure 1**. CENTRE the template. The holes on the template MUST be **flush** against the back of the truck box. Hold template tightly and drill one of the $\frac{1}{4}$ " pilot holes. Insert the $\frac{1}{4}$ "x1" bolt into this hole - this bolt serves to hold the template in place to ease further drilling. Proceed to drill the next three holes using the template.

Figure 1

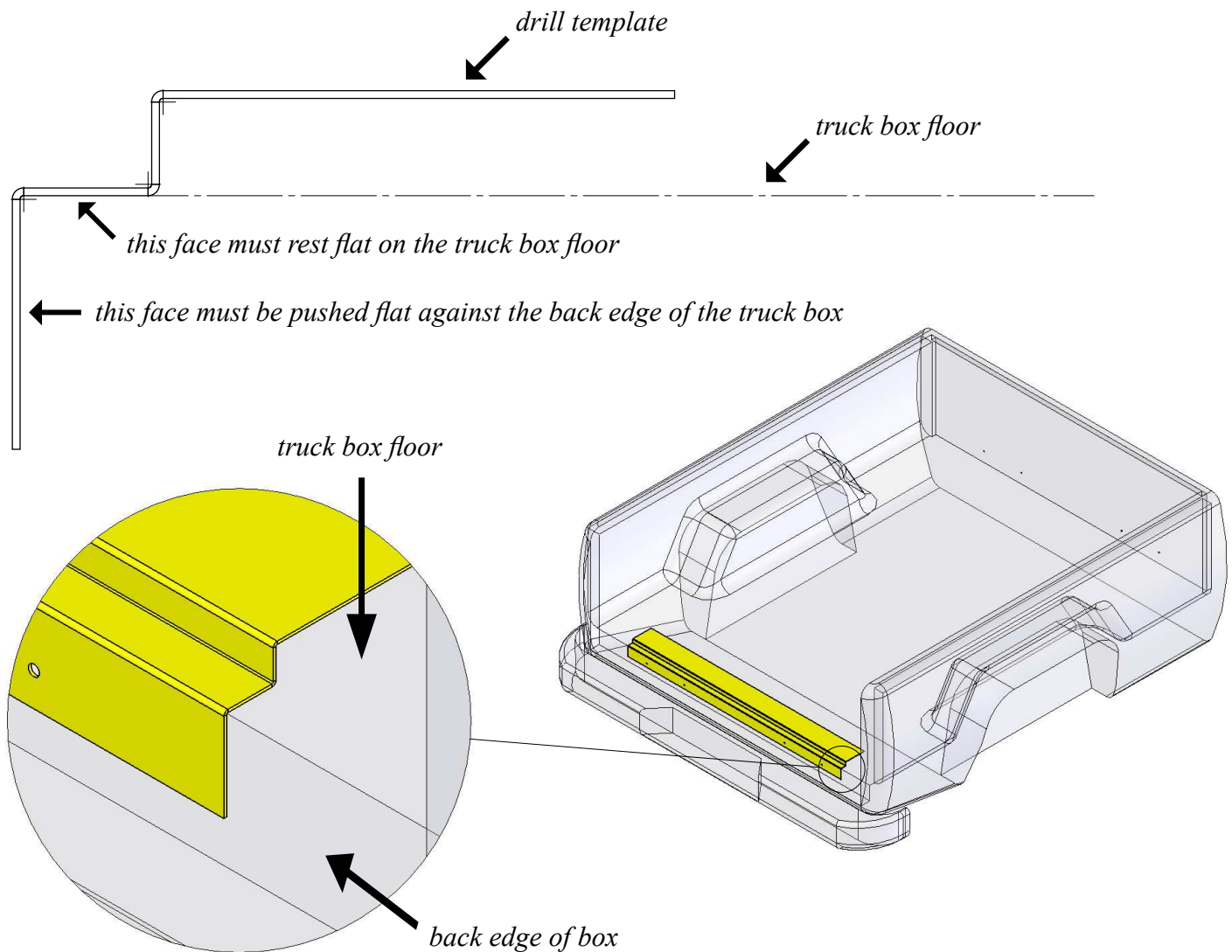

Step 2: Drilling front bed holes

Place the same template from Step 1 in the front of the truck box as shown in Figure 2. Using the same procedure from Step 1, drill the 4 required holes.

Figure 2

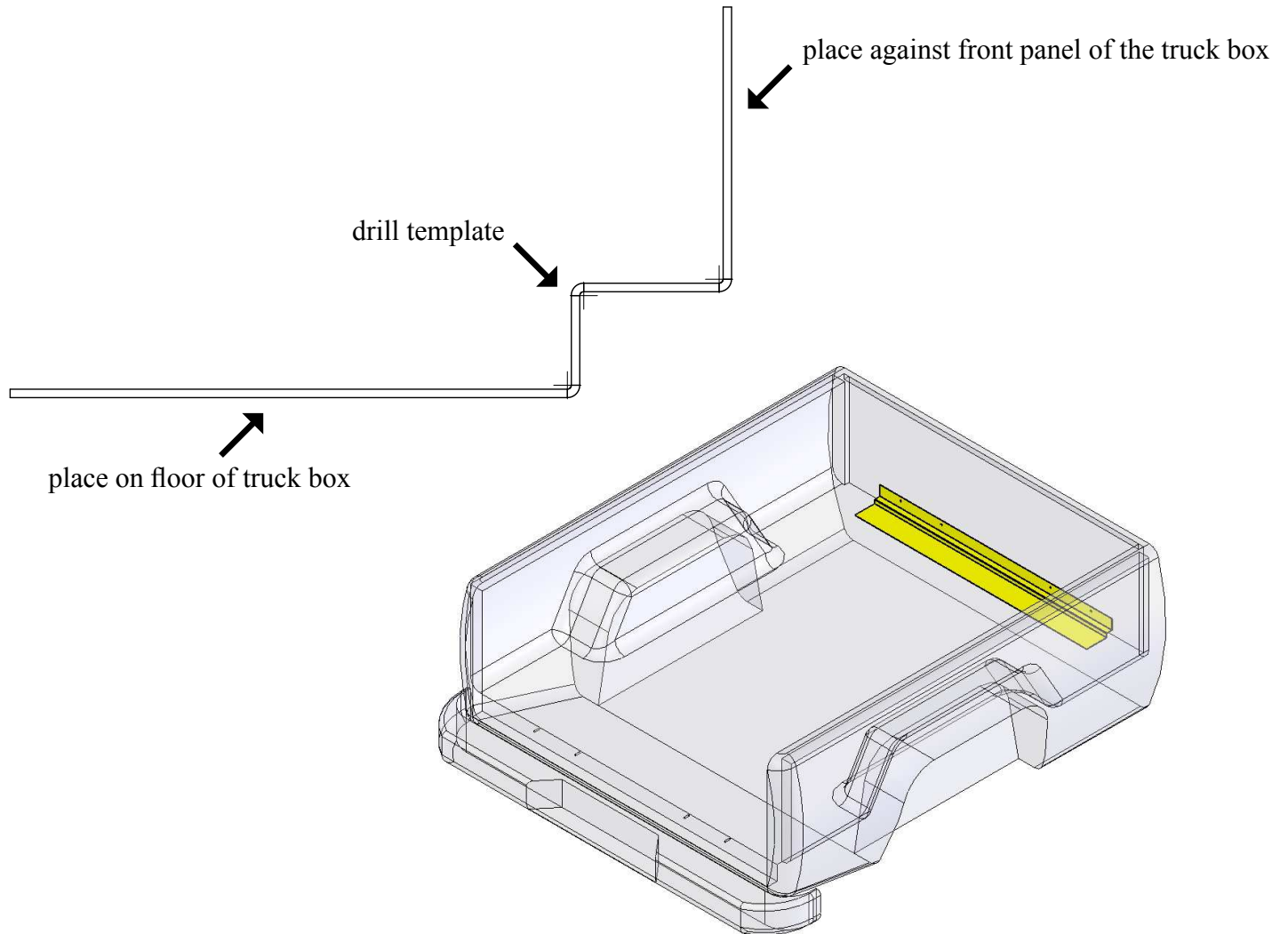

Step 3: Enlarging pilot holes

Using the 9/16" drill bit supplied, enlarge all 1/4" pilot holes to this size. **CAUTION:** drill very slowly because enlarging a hole in thin material causes the drill to catch and grab easily. Vacuum or sweep shavings.

Step 4: Attaching mounting plates

Method A: With Assistant

Using an assistant, have them support a Nut Channel from underneath the truck, up in between the truck box and the cab. The flat side of the Nut Channel should go against the truck box. Fasten the Mounting Ramp Plate (using two $\frac{1}{2}$ "x $1\frac{1}{2}$ " bolts) with the open slots on top, flat side against the truck box. Start all bolts before tightening. Repeat procedure for other ramp.

Method B: Without Assistant

Take a 3 foot (approx.) length of masking tape, fashion a loop, and use it to suspend the Nut Channel down between the truck box and the cab. The flat side of the Nut Channel should go against the truck box. Fasten the Mounting Ramp Plate (using two $\frac{1}{2}$ "x $1\frac{1}{2}$ " bolts) with the open slots on top, flat side against the truck box. Start all bolts before tightening. Simply tear away the masking tape after bolts have been tightened. Repeat procedure for other ramp.

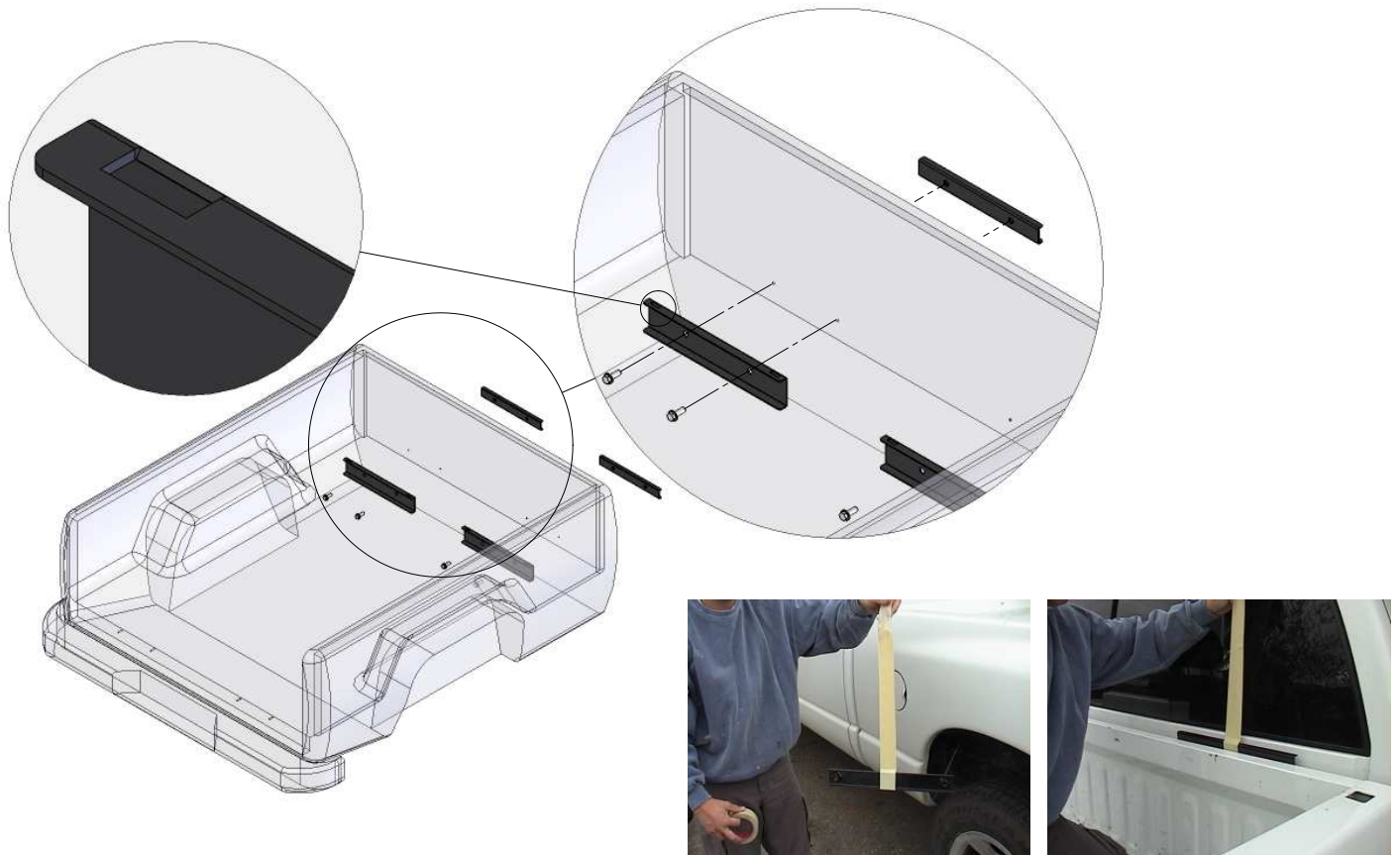

Step 5: Installing adjustable channels

Locate Sliding Channels. These Channels may be found within the ramp assembly, tucked into the Main Tunnel (outer housing). Position the Channels as shown on next page. The flat edge of the Channels should face out. Fit the Channels into the rectangular slots of the Mounting Ramp Plate by tilting up, hooking in, then letting down. Make sure the tabs at the end of the Channels are fully through the slots of the Mounting Ramp Plate. Repeat procedure for other ramp.



Step 6: Installing ramp assembly

To prevent scratching of the truck bed, place cardboard or a thin cloth underneath the Sliding Channels. Place ramp assembly on the truck bed in line with the Channels. Carefully guide the ramp assembly onto the Channels while guiding the locating pins into the holes on the back ledge of the truck bed. Bolt (using two $\frac{1}{2}$ "x $\frac{1}{4}$ " bolts and FOUR washers) the front of the ramp assembly to both Channels. These bolts must always be in place and secure as they lock the ramp assembly into the back of the truck. Repeat procedure for other ramp.

NOTE: If your tailgates have arrived pre-assembled and are already attached to the ramp, then installation is complete. If not, please proceed to **Step 7**.



Step 7: Tailgate assembly

Place the centre tailgate into the end of the ramp by inserting Locking Bars (square pins) through ramp-end square holes. The Ramp Handle should be facing down. Place ONE of the Gate Side Tubes onto the centre tailgate by inserting pin into side of ramp-end while at the same time sliding the ABS pipe over the other end of the Gate Side Tube. Repeat with other Gate Side Tube on other side of centre tailgate. Bolt Gate Side Tubes to centre tailgate using four $\frac{1}{2}$ " x 1" bolts (bolt heads should be on the inside of centre tailgate). Repeat procedure for other ramp.



Operating Instructions

How to Extract Ramp

1. Grasp Ramp Handle and lift upwards until Locking Bars clear holes in top of ramp header. Be careful not to catch hand / knuckles in between Handle and cross-member. Lift slowly!
2. Lower tailgate down and allow Handle (Locking Bars) to spring back into holes on front of ramp header.
3. Lift the Ramp Gate Pin (located in centre of ramp header) with one hand while extracting ramp with the other hand.
4. Withdraw the ramp with both hands until ramp has reached the end of its travel. Lower ramp to ground. Ensure that the ramp is at the end of its travel by checking the “stops” located on the inside of the Main Tunnel (outer housing). **THE STOPS MUST BE CHECKED TO ENSURE THEY ARE PREVENTING THE RAMP FROM BEING RELEASED.**
5. Adjust ramp laterally to achieve the proper width for equipment being loaded. Ramp must remain straight. **DO NOT TWIST** or you may release the ramps inadvertently from the STOPS, as described in Step 4, above.



How to Retract Ramp

6. Lift end of ramp (tailgate) with both hands such that it is level and centred with Main Tunnel (housing) on bed of truck.
7. Walk and push ramp into Tunnel on truck bed until ramp is completely retracted. The Ramp Gate Pin should automatically snap down into place and lock once the ramp has been fully retracted. If the Ramp Gate Pin fails to snap down and lock, simply adjust the ramp until this is achieved. **THE RAMP MUST BE LOCKED IN THIS POSITION AT ALL TIMES.**
8. To raise tailgate, reverse steps 1) and 2) above.



WARNING!

There is an inherent risk involved in the use of ATV's, snowmobiles, and motorcycles, and the loading, unloading, and hauling of these vehicles using any carrier system. Iron Concepts Ltd. assumes no liability whatsoever for damage or injury incurred during the use of this product.

- **Read complete instructions before using ramps.**
- **Inspect ramps before each use. Tighten any loose hardware and replace any worn or damaged parts.**
- **Only use ramps in the fully extended position. Check that they have reached the end of their travel and are secure. Do not use if ramps contact truck's bumper.**
- **Do not overload ramps. Maximum capacity is 600 lbs per ramp or 1200 lbs for a set of 2 ramps (evenly distributed load).**
- **Do not drive or ride your equipment while loading or unloading.**
- **Make sure ramps are straight and the tires run near the centre of each ramp and not on the edge of the ramp.**
- **Never secure cargo to the ramps.**
- **Always load or unload on a solid, level surface with the vehicle in gear, parking brake on, and engine off.**

Warranty

This Product is guaranteed to be free from defects in materials and workmanship for a period of one year from the date of shipment. This warranty does not apply to paint or items considered to be wear items. In the event the Product or any component thereof is claimed to be defective by the Customer, it shall be returned to Iron Concepts Ltd. (ICL) by the Customer, prepaid for inspection. No Product or any component thereof is to be returned to ICL by the Customer without the prior written consent and acceptance of ICL. Provided the Customer's complaint is received within the warranty period, if ICL determines that it is responsible for a defect in materials or workmanship, ICL may, in its sole discretion, choose to (i) remedy the defect in ICL's facility (and Customer agrees to provide full access to the Product for this purpose at Customer's sole cost and expense), or (ii) credit the Customer. This is the Customer's sole remedy hereunder. This warranty shall not apply to any Product which (a) have been altered or modified in any way (for purposes hereof, incorporation of Product in other products by the Customer where no changes have been made to Product to perform such incorporation is deemed not to be an alteration or modification), or (b) improperly installed or used, or (c) have been subjected to unusual physical or electrical stress, misuse, abuse, negligence or accident.