



Instructions for Black Widow Motorcycle Stands

General Guidelines

- It is the user's responsibility to read and follow all instructions.
- Keep these instructions with the product at all times and review before each use.
- It is the responsibility of this product's owner to furnish the instructions to any person that borrows or purchases the product.
- Inspect the product before use to ensure it is assembled properly and all parts are in safe working order and free of defects.
- Never modify this product in any way.
- All circumstances cannot be addressed in these instructions. Please use common sense and practice general safety measures when using this product.
- Parts and/or instructions are subject to change without notice.

Safety

- For use with sport bikes only.
- Keep motorcycle tires straight when using the stand(s).
- Keep a firm grasp on the motorcycle when lifting or lowering to keep it steady. Use an assistant if necessary.
- If lifting both the rear and front of the motorcycle, always lift the rear stand first.

Parts

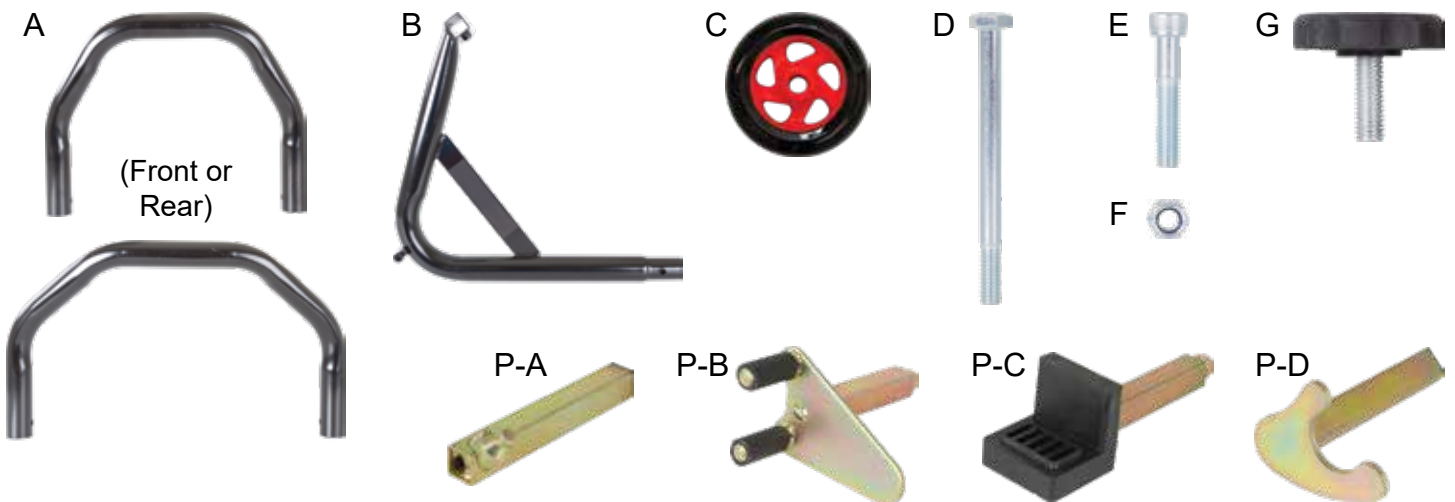

Part	Description	Quantity
A	Tire Loop (Front or Rear)	1
B	Side Brace	2
C	Wheel	4
D	M8x100 Bolt	2
E	M8x45 Allen Head Bolt	2
F	M8 Nut	4

Part	Description	Quantity
G	M8x22 Turn Knob	2
Pin Options*		
P-A	Front Fork Pin (BW-F-PIN)	2
P-B	Front Prong Pin (BW-F-PRONG)	2
P-C	Rear Swingarm Pad (BW-R-PAD)	2
P-D	Rear Spool Pin (BW-R-SPOOL)	2

*Included pins may vary depending on the stand or kit you purchased.

Tools Required

- 13mm or 1/2" wrench
- 14mm or 9/16" wrench
- 6mm Allen wrench

Assembly

Step 1. Attach the tire loop (A) to the two side braces (B) using the M8x45 bolts (E) and nuts (F). Tighten securely using a 6mm Allen wrench and 13mm wrench.

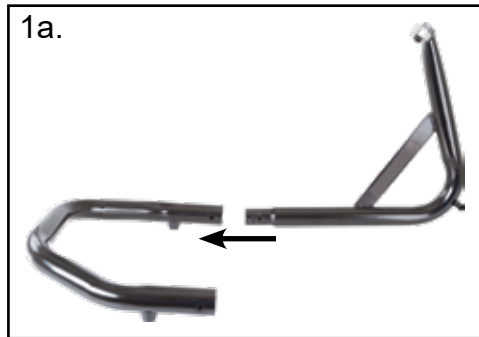



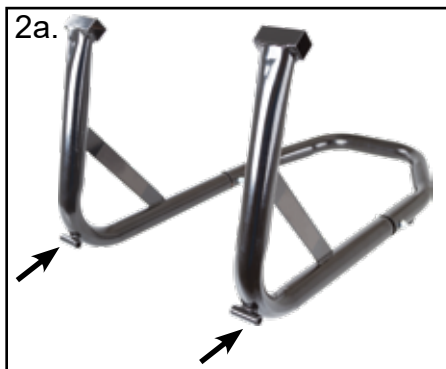

Step 2. Attach the wheels (C) to the side braces (B) using the M8x100 bolts (D) and nuts (F). Tighten using 13mm and 14mm wrenches.

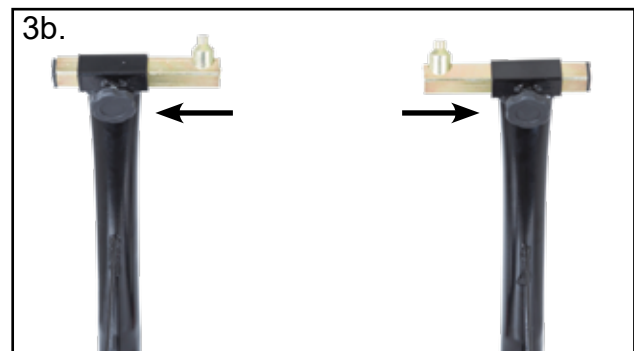
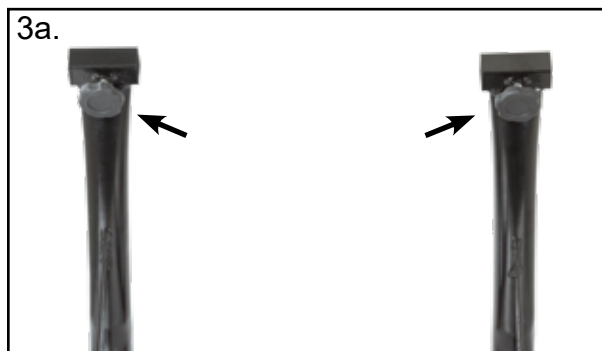

Step 3. Insert the turn knobs (G) into the holes on the brackets on the side braces (B). Insert the appropriate pin set (P-A, P-B, P-C, or P-D) into the brackets on the side braces (B) and adjust to the appropriate width. Tighten the turn knobs to secure the pins in place.



Pin Options

Front Wheel	Rear Wheel
<p>Front Fork Pin - Tapered struts fit into the holes on the bottom end of the motorcycle's front forks.</p>  A yellow tapered pin with a hexagonal base and a cylindrical top section.	<p>Rear Swingarm Pad - Lifting pads hook under the rear swingarm of the motorcycle.</p>  A yellow rectangular base with a grey L-shaped hook on the right side.
<p>Front Prong Pin - Rubber coated arms lift under the bottom and back side of the motorcycle's front fork tubes.</p>  A yellow pin with a triangular base and two black cylindrical prongs at the top.	<p>Rear Spool Pin - Hook-style attachments fit under the spools on the motorcycle.</p>  A yellow pin with a long horizontal base and a hook-shaped attachment on the right side.

Use

Make sure the correct pins are securely installed in the stand (see Pin Options). Keep your motorcycle kickstand down.

To raise the motorcycle, roll the stand in place, ensuring the pins properly fit under your motorcycle's forks, swing arms, or spools. While keeping a firm hold on the motorcycle with one hand to keep it steady, push down on the stand with the other hand until the motorcycle is raised and the stand is resting on the ground. Use an assistant if necessary, having one person steady the bike while the other pushes down on the stand.

To lower the motorcycle, keep a firm hold on the motorcycle with one hand and pull up on the stand with the other hand until the motorcycle is resting on the ground. Use an assistant if necessary.



Product Warranty and Liability

GENERAL PRODUCT WARRANTY: Products purchased from the Authorized Dealer (original place of purchase) or Merchant (“Dealer”) will be free of defects in material and workmanship at the time of receipt, and will meet the specifications stated at the place of purchase transaction or online at the Dealer’s website, under normal use and service when correctly installed, operated and maintained. This product warranty is effective for the period of time stated below, unless otherwise stated in the product instructions or depicted in the product advertisement. **All Authorized Dealer warranties are NON-TRANSFERABLE** and cover only the original end purchaser. This limited warranty does not cover products purchased through non-authorized dealers. Non-authorized dealer receipts are not accepted for warranty verification.

*****Warranty claims must be made directly to the original place of purchase.*****

WARRANTY PERIOD: This warranty remains in force for one year from the date of the product’s accepted delivery. The Authorized Dealer offers a one year manufacturer’s warranty for most products unless otherwise specified on the product advertisement.

WARRANTY SERVICE: The Authorized Dealer will replace any defective or malfunctioning part at no charge, including payment of the shipping costs of parts or replacement product to and from the manufacturer. The purchaser is responsible for labor charges. If the product does not meet specifications as depicted in the advertisement, the Authorized Dealer will refund the full purchase price of the product.

Questions regarding the warranty on a specific product and warranty claims should be directed to the Authorized Dealer with whom the purchase transaction was made.

WARRANTY LIMITATIONS: The above warranty does not apply to products that are repaired, modified or altered by any party other than the Authorized Dealer; are subjected to unusual physical stress or conditions (such as overloaded ramps or corrosion), natural disaster, governmental actions, wars, strikes, labor disputes, riots, theft, vandalism, terrorism or any reason beyond reasonable control; are damaged due to improper installation, misuse, abuse, accident or negligence in use, storage, transportation or handling, or tampering; or to products that are considered consumable items or items requiring repair or replacement due to normal wear and tear.

Product should be inspected prior to signing for delivery. Product damage incurred during shipping, unless noted on the Bill of Lading at the time of delivery, renders this warranty void.

LIMITED LIABILITY: In no event shall THE AUTHORIZED DEALER be liable to the purchaser or any third party for any indirect, incidental, consequential, special, exemplary or punitive damages arising out of the use of the product, including, without limitation, property damage, loss of value of the product or any third party products that are used in or with the product, or loss of use of the product or any third party products that are used in or with the product.

