

# BC-7621-E

# INSTRUCTIONS

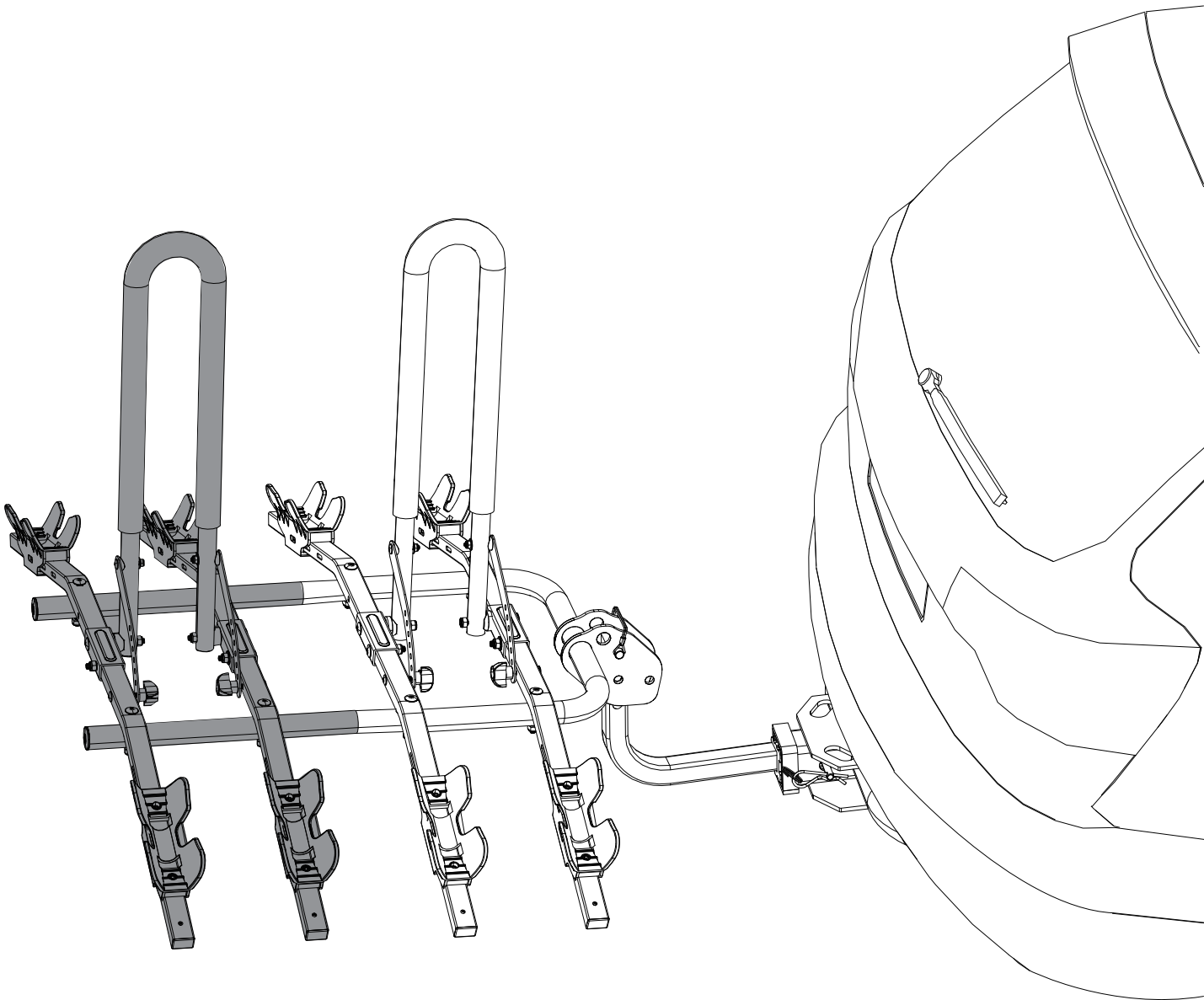

## Caution \_\_\_\_\_

1. Do not drive off road or exceed the speed limit.
2. The maximum load is 90kgs (225 lbs).
3. This bike rack is not suitable for RV, fifth wheel, and travel trailer.
4. The manufacturer is not liable for any damages resulting from improper use.
5. The attachment of rack to vehicle and bikes to rack is critical and beyond the control of the manufacturer. The user needs to secure it properly to the vehicle and you need to regularly inspect parts for wear or damage.

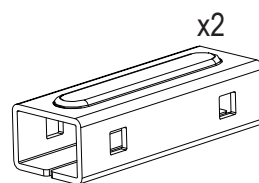
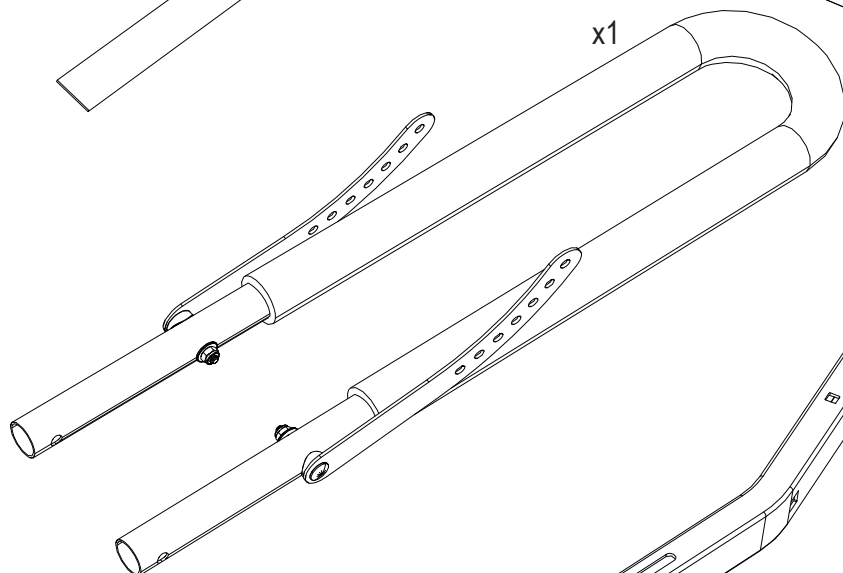
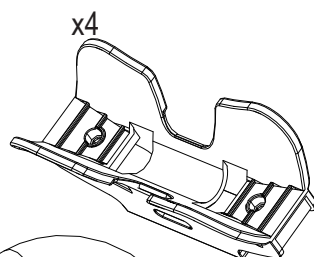
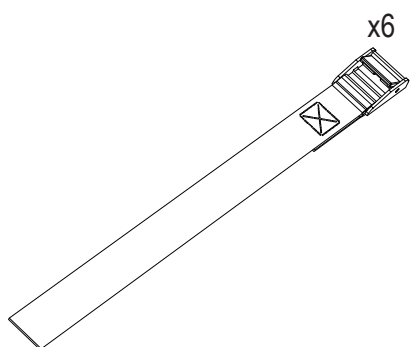
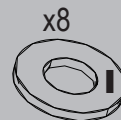
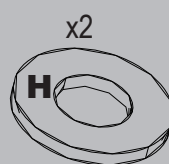
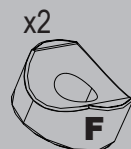
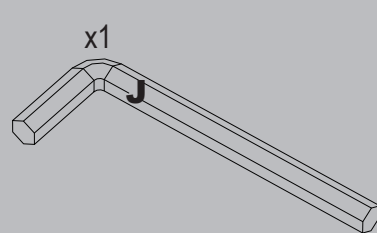
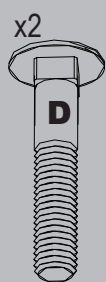
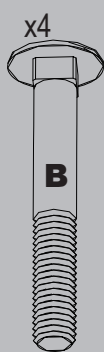
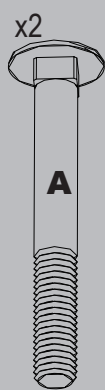

x4

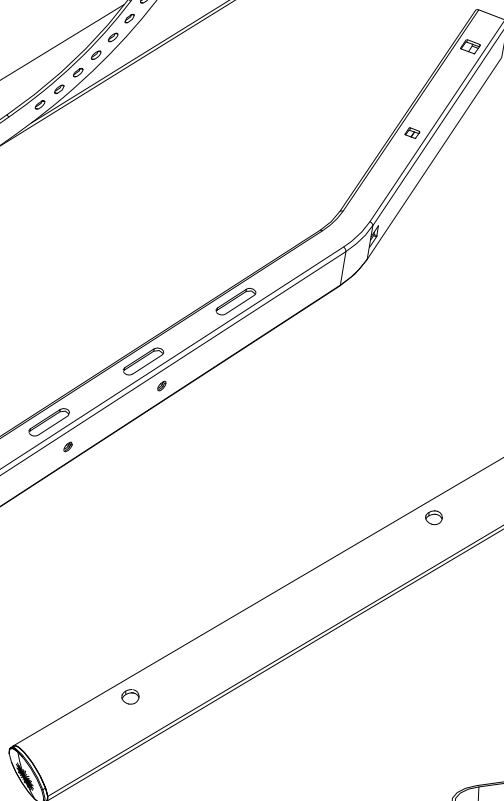

x2

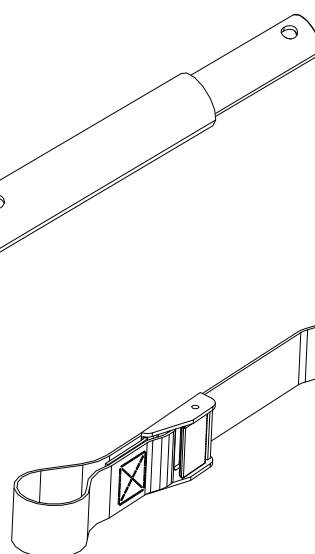

x1

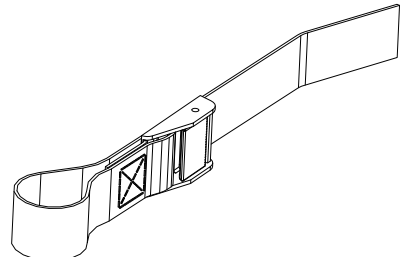

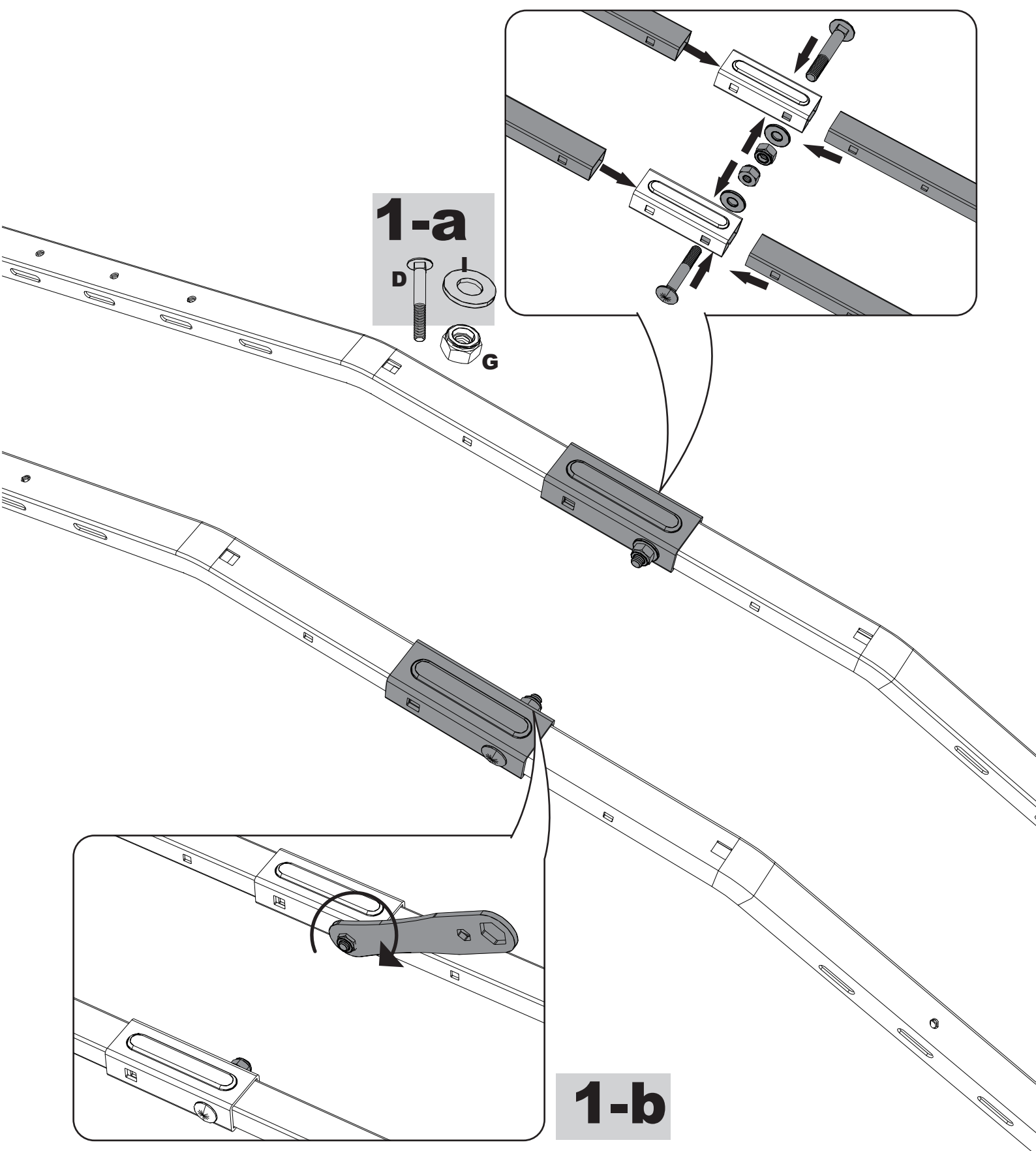

**2-a**

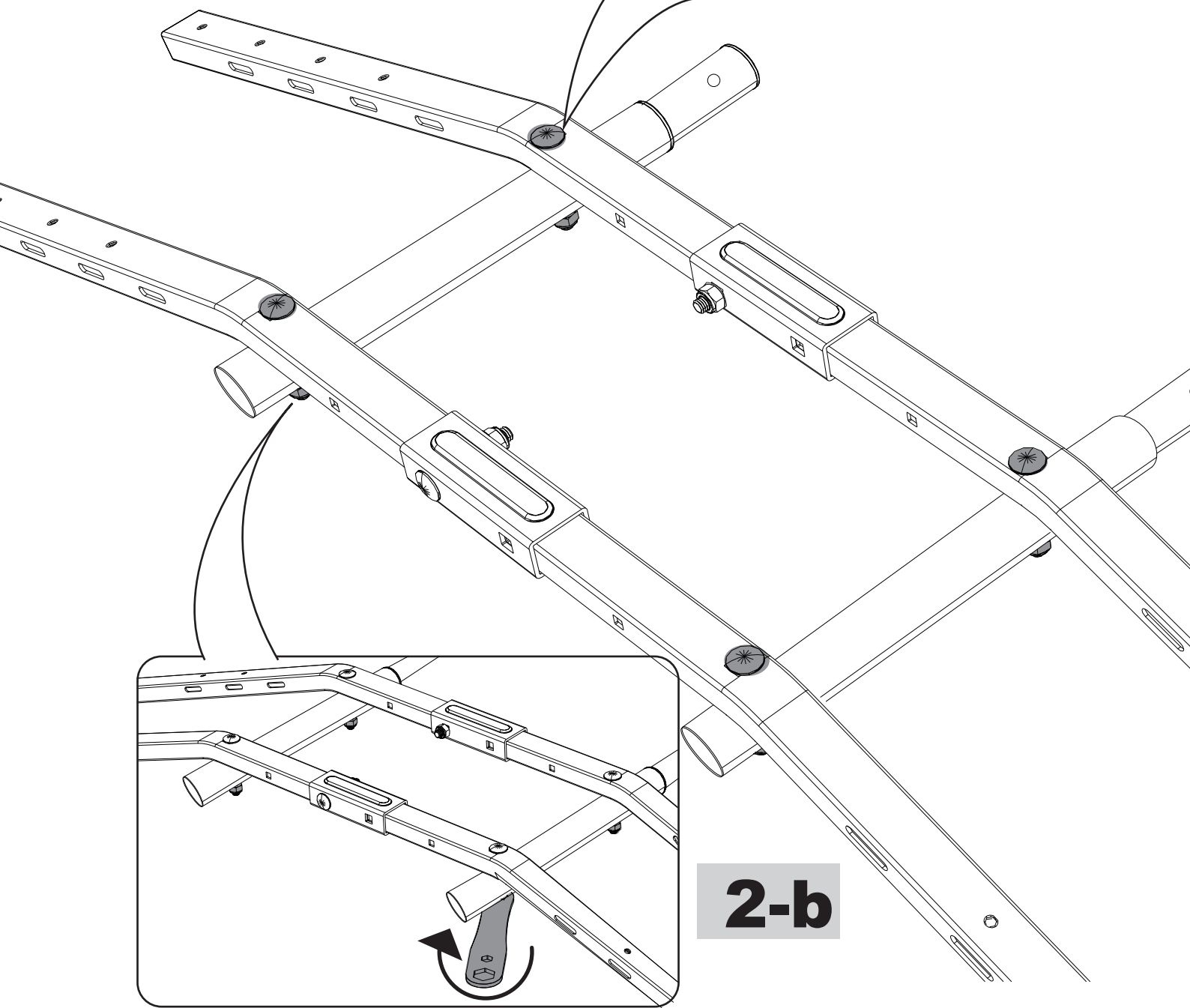
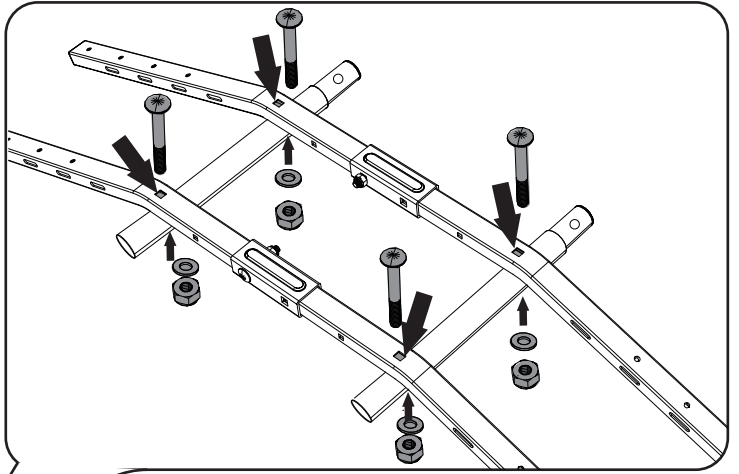
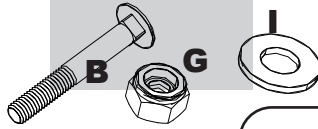

**2-b**

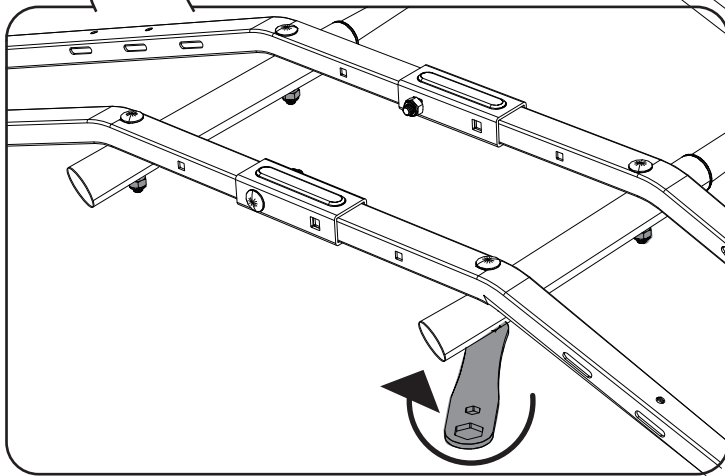

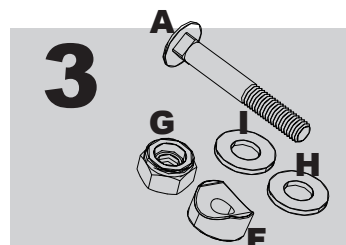
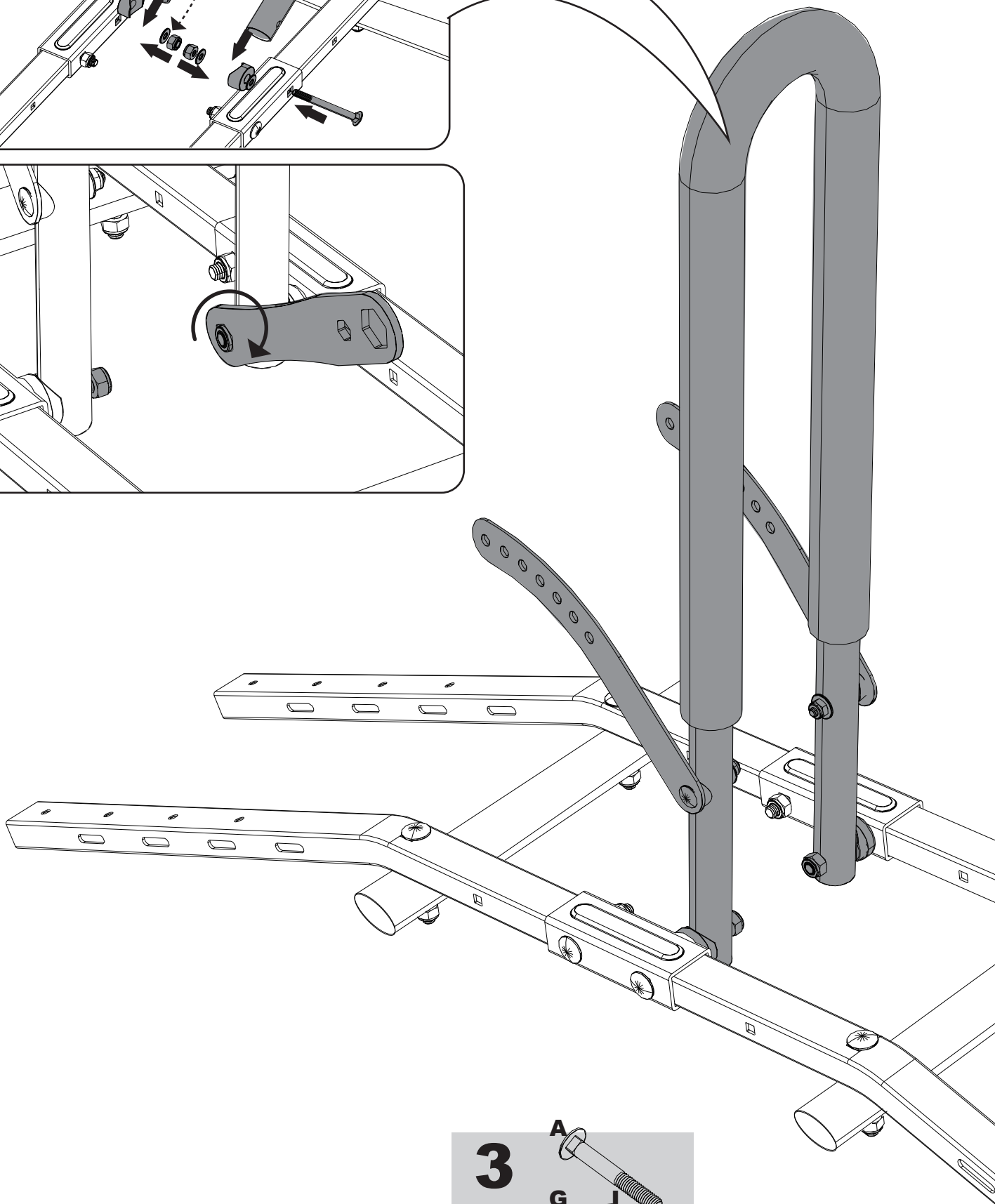
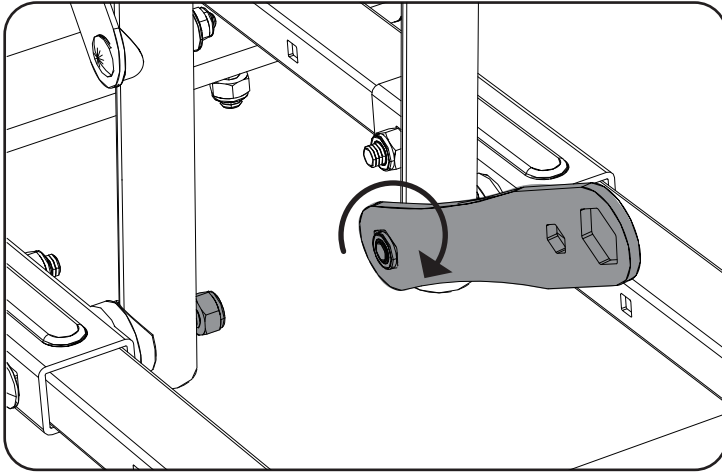
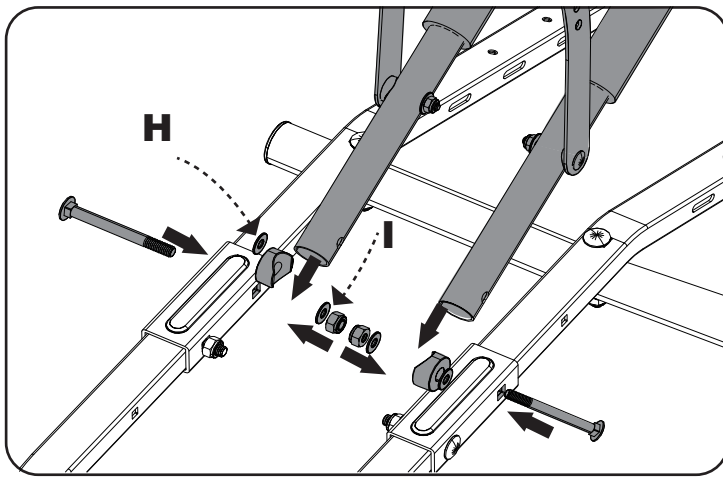

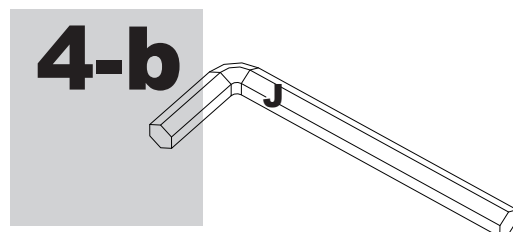
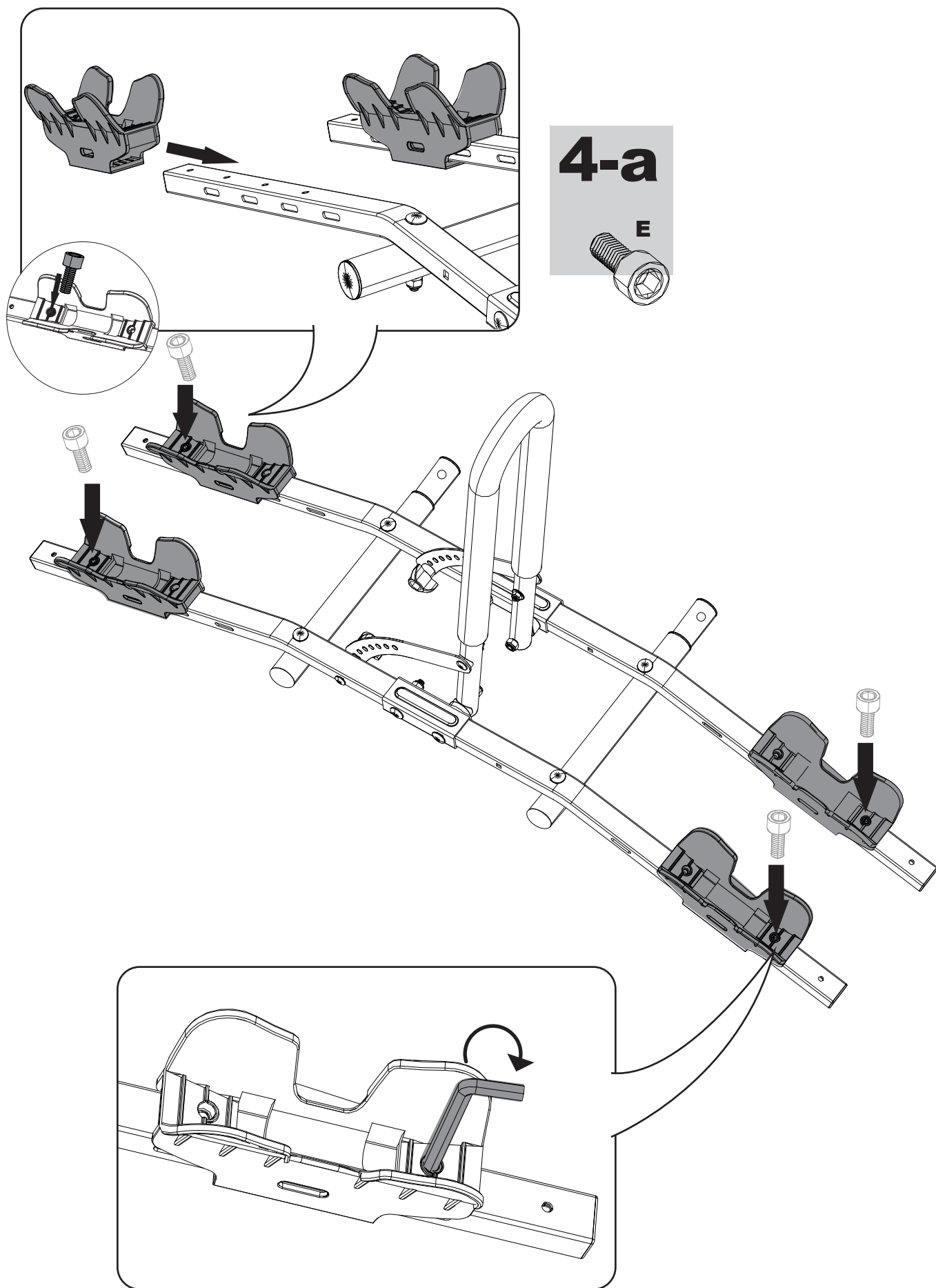

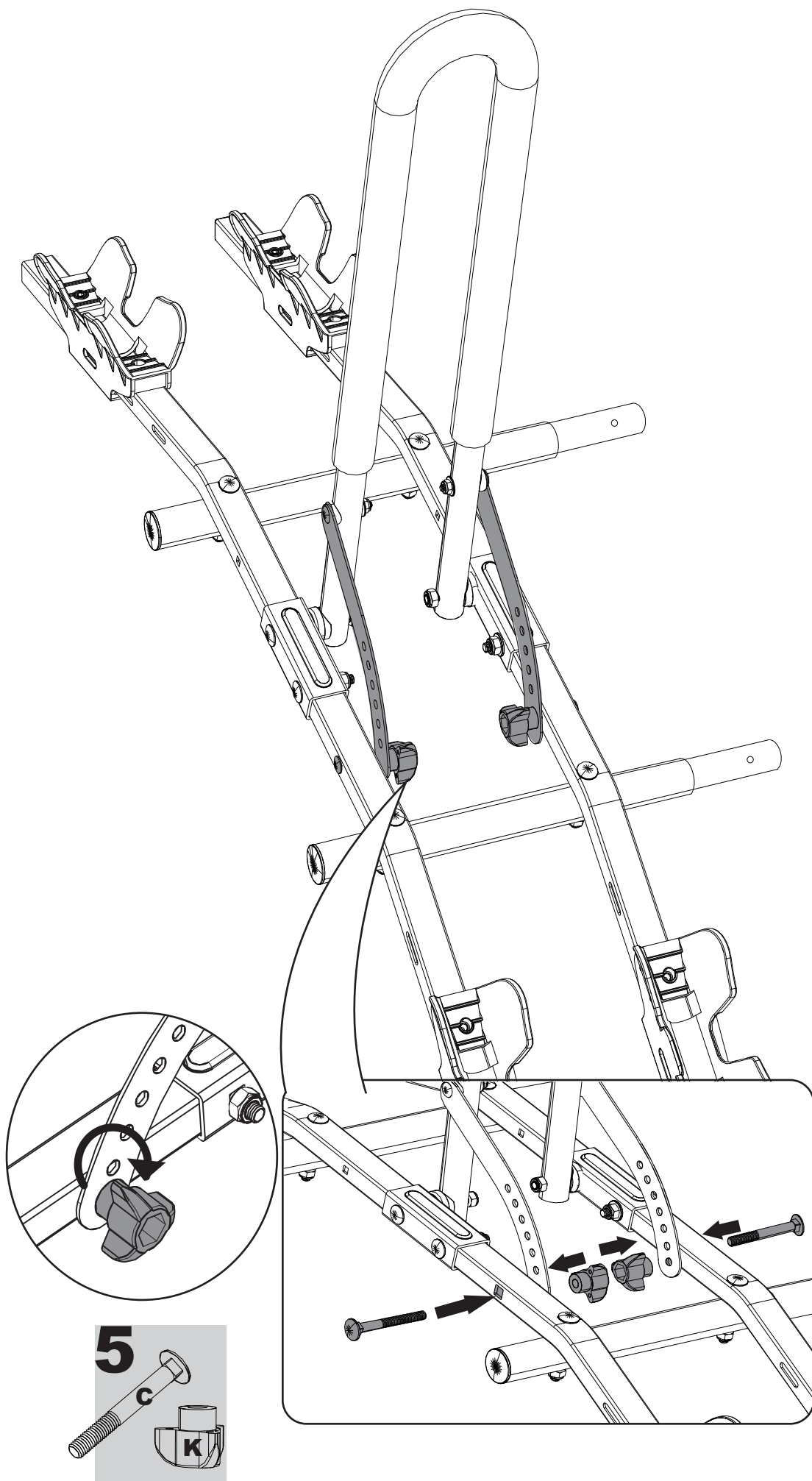

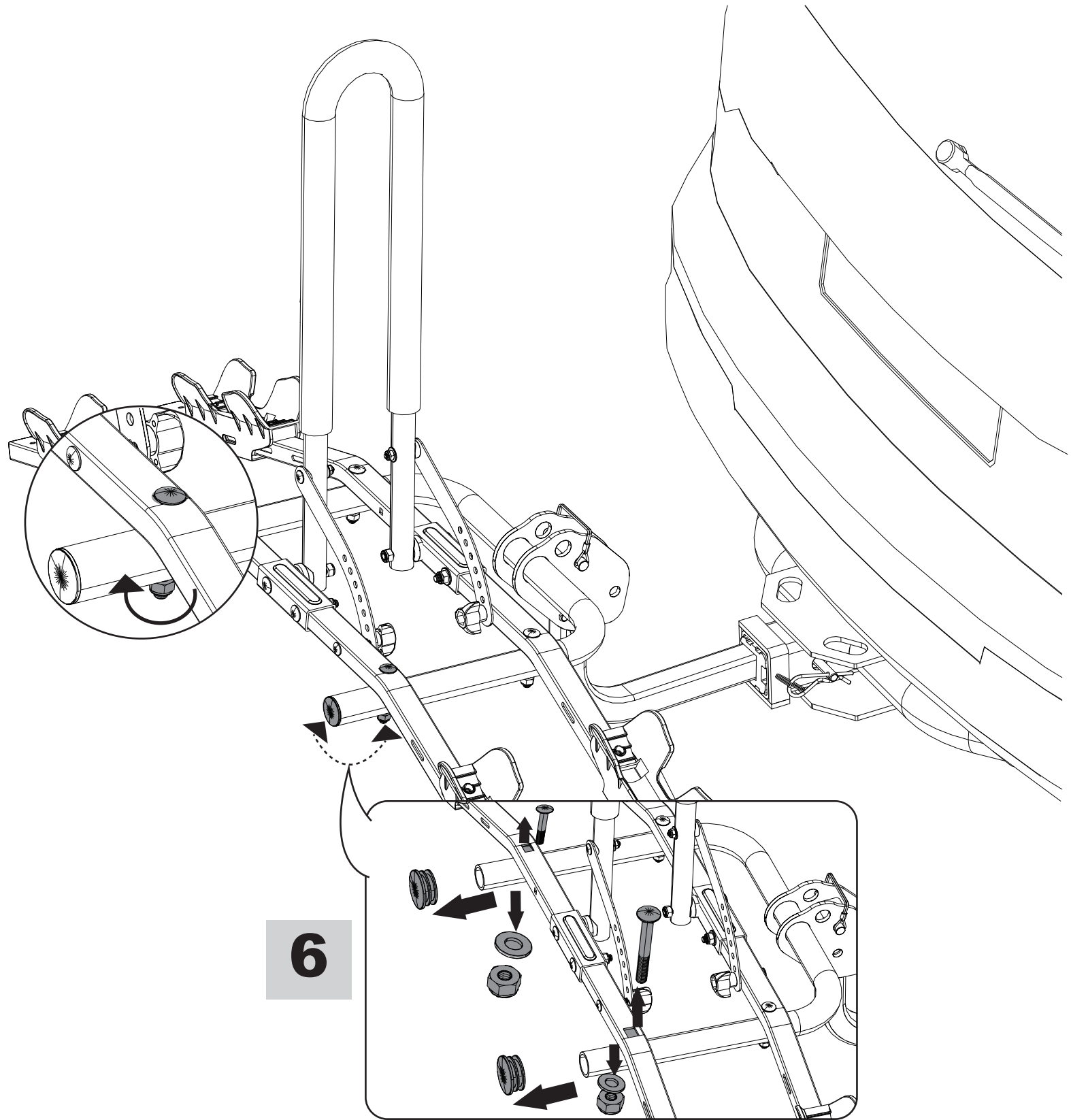

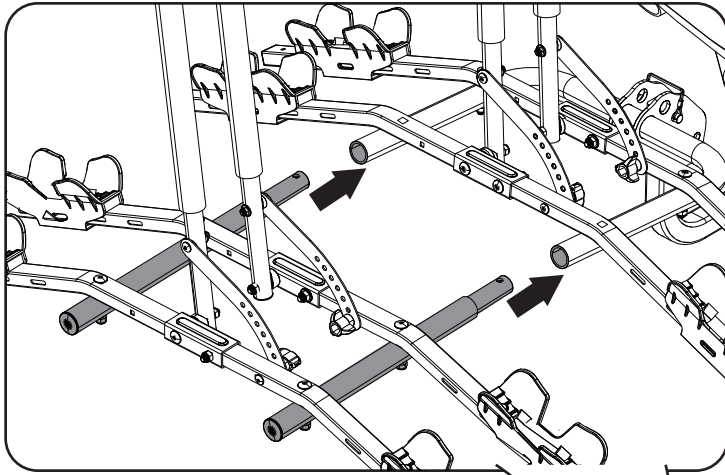

**7-a**

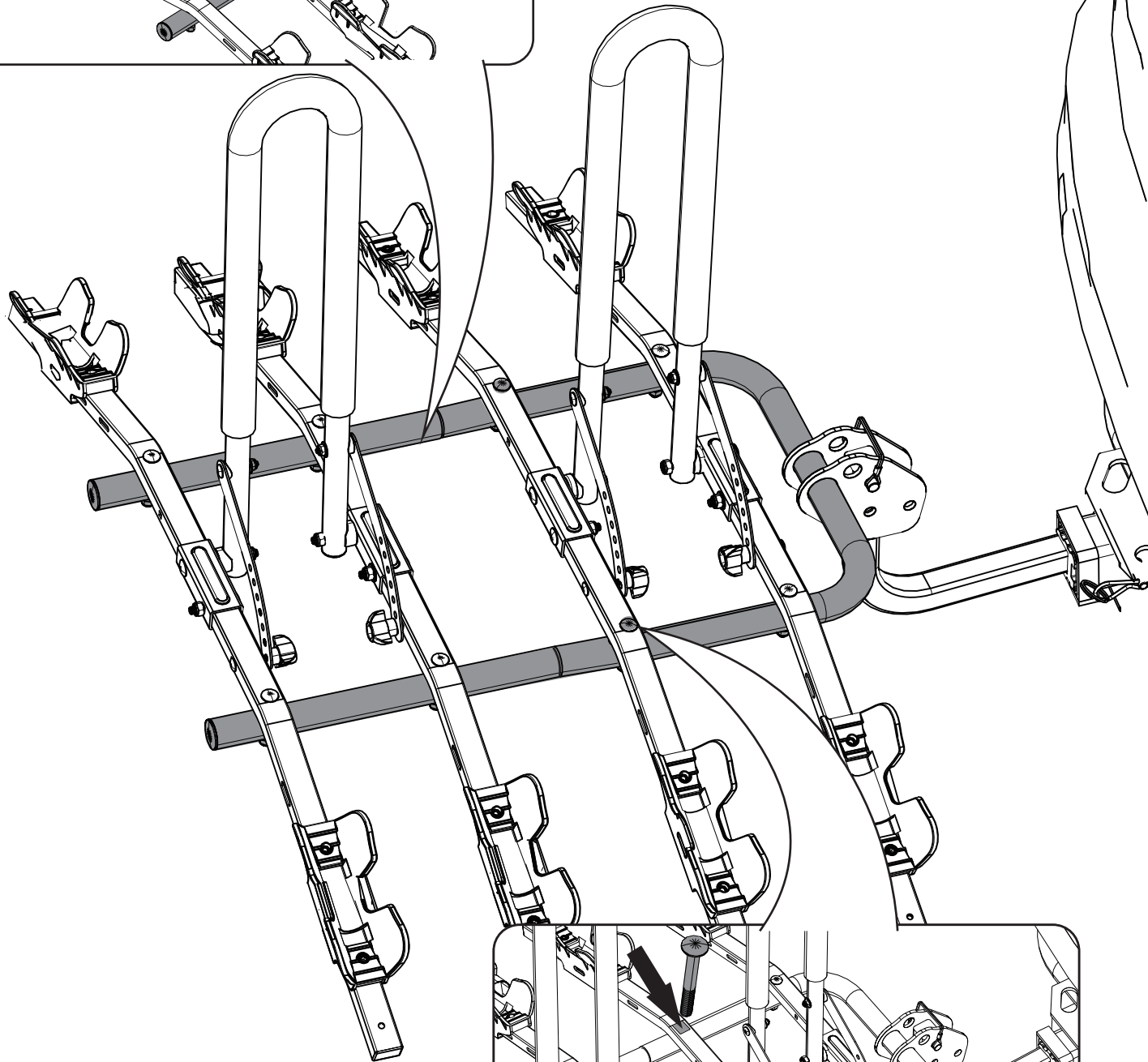

**7-b**

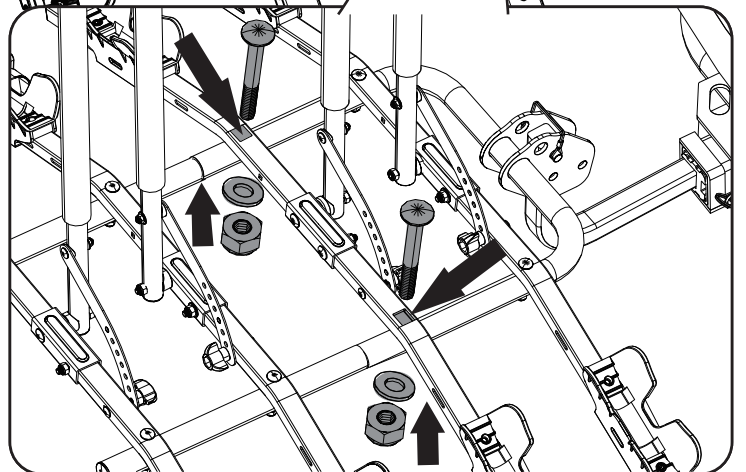

8

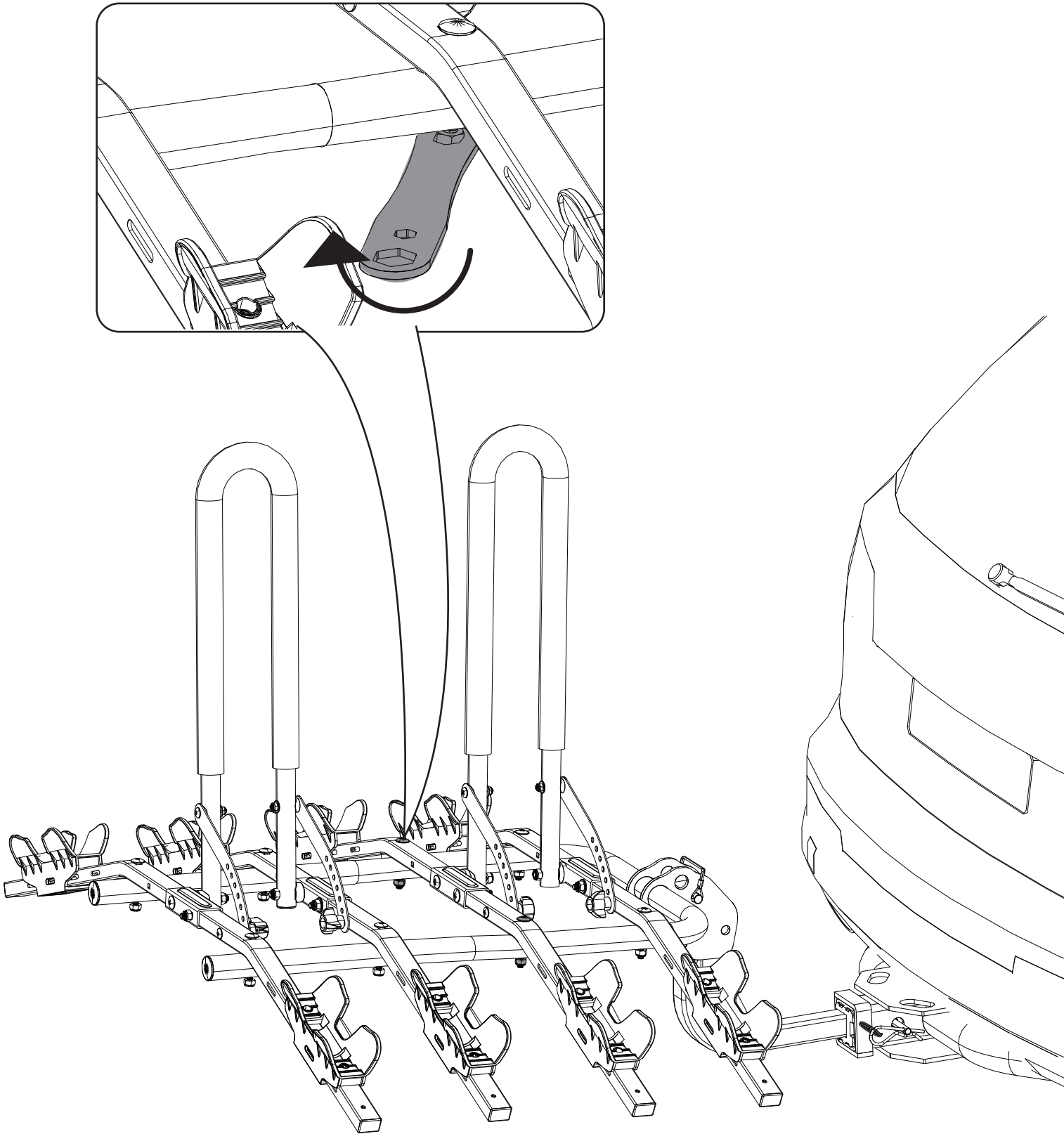

**9**

Installation complete. Then please refer to BC-7621 instruction for mounting the bikes. Please make sure the safety strap is used.

