



# 10 Ton Hydraulic Shop Press

Instructions for Part # BD-PRESS-10H

## **GENERAL GUIDELINES & SAFETY**



- It is the user's responsibility to read and follow all instructions.
- Keep these instructions with the product at all times and review before each use.
- It is the responsibility of this product's owner to furnish the instructions to any person that borrows or purchases the product.
- Inspect the product before use to ensure it is assembled properly and all parts are in safe working order and free of defects.
- Never modify this product in any way.
- All circumstances cannot be addressed in these instructions.
- Please use common sense and practice general safety measures when using this product.
- Parts and/or instructions are subject to change without notice.
- Steel and other materials can shatter, so always use protective eyewear that complies with the appropriate ANSI code, a full-face safety shield, and work gloves when operating the press.
- Do not wear loose-fitting clothing when operating. Remove ties, watches, rings, and other loose jewelry and contain long hair.
- Do not use the press when tired or under the influence of alcohol, drugs, or any intoxicating medication. Do not allow untrained persons to operate the press.
- If you detect anything that may indicate imminent structural failure, stop using the press immediately and inspect it thoroughly.
- Only use the press on stable, level, and dry surfaces capable of sustaining the load.
- Bolt the press to the floor it is to be used with bulky or unstable items. If the press will be getting almost daily use, it is recommended to bolt it down.
- Do not use the press to compress springs or any other item that could disengage and cause a potential hazard.
- Safe assembly may require two people.

## **BEFORE USE**

During shipment or handling, air in the jack can become trapped in the hydraulic system, causing the jack to malfunction. To release air from the hydraulic system:

- Turn the release valve counter-clockwise with the handle no more than two full turns.
- Remove the oil fill plug.
- Pump the jack handle quickly in several full strokes.
- Repeat the above steps as needed. Remember to replace the oil fill plug.

## PARTS

Part	Description	Qty
1	Frame	1
2	Lower screw nut	1
3	Arbor plate	2
4	Bed frame	1
5	Bed frame pin	2
6	Clip	2
7	Bolt M8x25	8
8	Washer 8	8
9	Lock washer 8	4
10	Nut M8	8
11	Base	2
12	Release valve	1
13	Pump	1
14	Handle	1
15	Vent screw	1
16	Hose	1
17	Gauge	1
18	Cylinder / Ram	1

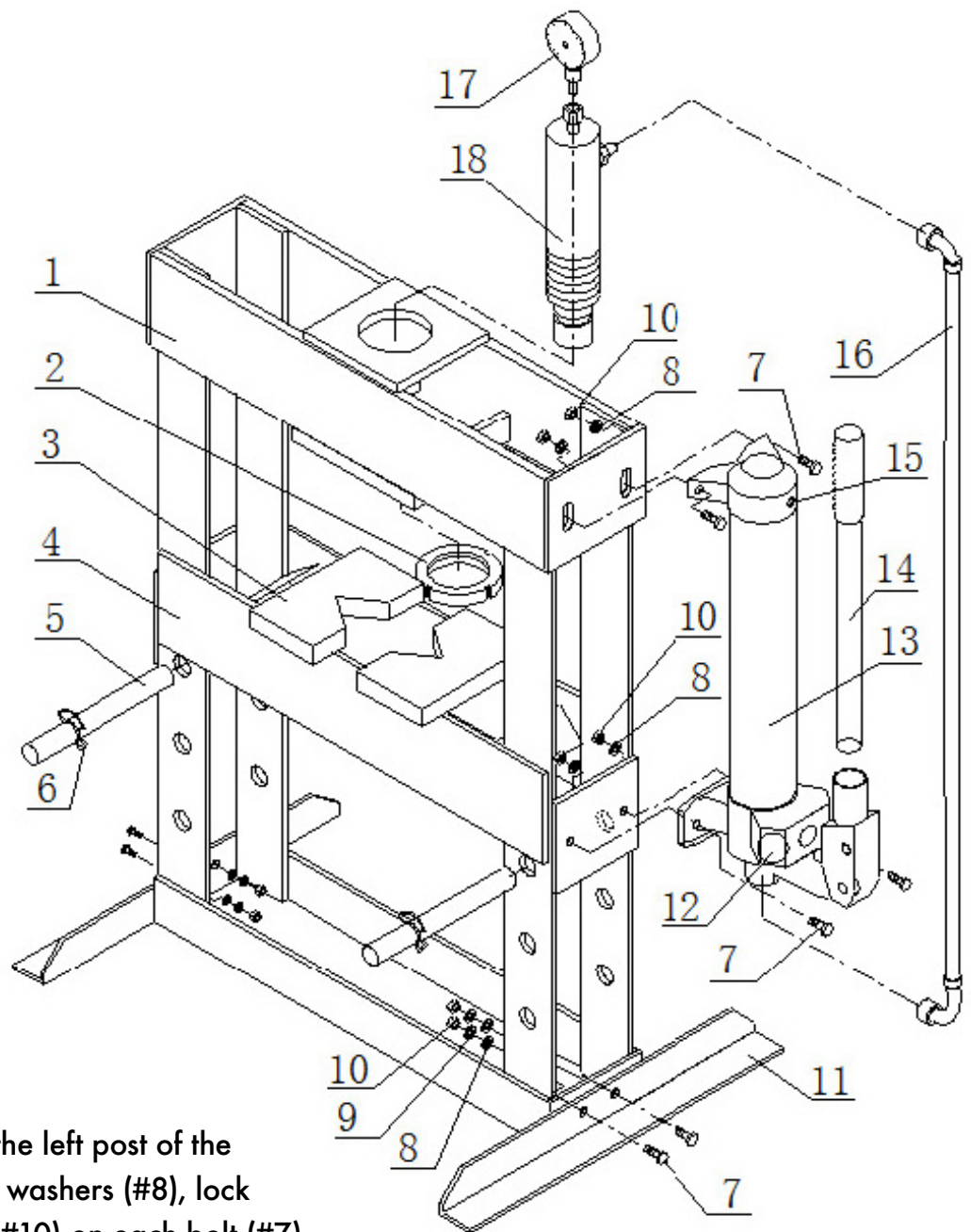

## ASSEMBLY

- STEP 1.** Attach a base (#11) to the left post of the frame (#1). Secure with washers (#8), lock washers (#9) and nuts (#10) on each bolt (#7).
- STEP 2.** Follow Steps 2.1 to attach the base to the right post.
- STEP 3.** Raise the shop press frame upright.
- STEP 4.** Thread the gauge (#17) into the connection nut at the top of the cylinder (#18).
- STEP 5.** Insert the cylinder (#18) from the top center of frame (#1) into the hole. Thread the cylinder onto the base which welded on the bottom of upper cross beam until it reaches the top threads. Position so the gauge is facing the front.
- STEP 6.** Thread the lower screw nut (#2) onto the cylinder (#18), tighten to secure the nut to the base.
- STEP 7.** Secure the pump (#13) with bolts (#7), washers (#8), and nuts (#10) . The bolts are inserted through the right post and into screw holes in the pump's mounting frame.
- STEP 8.** Connect the hydraulic hose (#16) to the connection nut on the pump (#13), and another side to the cylinder connection nut (#18).

- STEP 9.** Push each bed frame pin (#5) through the matching set of holes on the left and right side of the frame. The bed frame (#4) will rest on these, so ensure they are level with each other. Secure the pins with the included clips (#6).
- STEP 10.** Position the bed frame so the beams are outside of the leg assemblies. Lower until the bed frame is resting on the pins.
- STEP 11.** Insert a handle (#14) to the handle hole when using it.
- STEP 12.** Put the arbor plate (#3) on the bed frame.
- STEP 13.** Check all bolts and nuts and tighten if necessary.

## **OPERATION**

- STEP 1.** Lift or lower the bed frame as needed until it is in position. Insert a bed frame pin into the left and right posts beneath the bed frame, ensure they are level. Lower the bed frame so it rests on the bed frame pin.
- STEP 2.** Place both arbor plate on the bed frame far enough apart to support the work-piece. Leave a gap wide enough for the ram piston. then position the work-piece on the arbor plate.
- CAUTION \*\*THE ARBOR PLATE MUST BE USED BY PAIR, NOT BY PIECE!**
- \*\* THE ARBOR PLATE CAN BE USED BY BOTH SIDES.**
- STEP 3.** Turn the release valve knob clockwise to firmly close it.
- STEP 4.** Pump the handle until ram nears work-piece.
- STEP 5.** Align work-piece and ram to ensure center loading.
- STEP 6.** Pump handle to continue extending the ram and apply the load onto work-piece (please see numeration in pressure gauge, Do not over load).
- STEP 7.** When the task is done, stop pumping the handle. Turn the release valve counterclockwise in small increments to slowly and carefully retract the ram and remove the load from work-piece by. (Must turn with the small angle, the biggest is two circles).
- STEP 8.** Once the ram is fully retracted, remove the work-piece from bed frame.
- STEP 9.** Purge any residual air in the system then close the release valve.

## **MAINTENANCE**

- STEP 1.** Periodically, lubricate all moving parts including the pump piston and hydraulic ram.
- STEP 2.** When not in use, store the press in a dry location with ram and piston fully retracted.
- STEP 3.** Check hydraulic oil level and ensure all connections and hoses are well before use.
- STEP 4.** If the press need repairing and/or there are any parts that need to be replaced, have it repaired by authorized and trained technicians and only use the replacement parts supplied by the manufacturer.

# **PRODUCT WARRANTY & LIABILITY**

**GENERAL PRODUCT WARRANTY:** Products purchased from the Authorized Dealer (original place of purchase) or Merchant ("Dealer") will be free of defects in material and workmanship at the time of receipt, and will meet the specifications stated at the place of purchase transaction or online at the Dealer's website, under normal use and service when correctly installed, operated and maintained. This product warranty is effective for the period of time stated below, unless otherwise stated in the product instructions or depicted in the product advertisement. All Authorized Dealer warranties are NON-TRANSFERABLE and cover only the original end purchaser. This limited warranty does not cover products purchased through non-authorized dealers. Non-authorized dealer receipts are not accepted for warranty verification.

**\*\*\*WARRANTY CLAIMS MUST BE MADE DIRECTLY TO THE ORIGINAL PLACE OF PURCHASE.\*\*\***

**WARRANTY PERIOD:** This warranty remains in force for one year from the date of the product's accepted delivery. The Authorized Dealer offers a one year manufacturer's warranty for most products unless otherwise specified on the product advertisement.

**WARRANTY SERVICE:** The Authorized Dealer will replace any defective or malfunctioning part at no charge, including payment of the shipping costs of parts or replacement product to and from the manufacturer. The purchaser is responsible for labor charges. If the product does not meet specifications as depicted in the advertisement, the Authorized Dealer will refund the full purchase price of the product.

Questions regarding the warranty on a specific product and warranty claims should be directed to the Authorized Dealer with whom the purchase transaction was made.

**WARRANTY LIMITATIONS:** The above warranty does not apply to products that are repaired, modified or altered by any party other than the Authorized Dealer; are subjected to unusual physical stress or conditions (such as overloaded ramps or corrosion), natural disaster, governmental actions, wars, strikes, labor disputes, riots, theft, vandalism, terrorism or any reason beyond reasonable control; are damaged due to improper installation, misuse, abuse, accident or negligence in use, storage, transportation or handling, or tampering; or to products that are considered consumable items or items requiring repair or replacement due to normal wear and tear.

Product should be inspected prior to signing for delivery. Product damage incurred during shipping, unless noted on the Bill of Lading at the time of delivery, renders this warranty void.

**LIMITED LIABILITY:** In no event shall **THE AUTHORIZED DEALER** be liable to the purchaser or any third party for any indirect, incidental, consequential, special, exemplary or punitive damages arising out of the use of the product, including, without limitation, property damage, loss of value of the product or any third party products that are used in or with the product, or loss of use of the product or any third party products that are used in or with the product.

