

### Returns

If you purchased this product directly from SeaSucker and have not used it yet, you can return it for exchange or refund within 30 days of purchase. To request a Return Authorization for a return, exchange, or repair, visit [https://seasucker.formstack.com/forms/rma\\_request](https://seasucker.formstack.com/forms/rma_request).

### Repair and Replacement

Products with non-warrantable damage or products that are no longer within the warranty period may still be repaired or replaced at your expense. Discounted replacement parts, including vacuum pads, pumps, fork mounts and hardware, can be found on-line in the Replacement Parts section of SeaSucker's on-line store.

### Warranty

SeaSucker offers a 1-year, non-transferable warranty covering defects in materials and workmanship. Defective products can be returned within 1 year of the date of original purchase to SeaSucker for replacement or repair (at SeaSucker's option). Warranty claims must be accompanied by a sales receipt or other proof of purchase document. The cost of transportation to and from SeaSucker for the repair or replacement of any defective part or accessory is not covered by this warranty and is to be paid by the owner. This warranty does not apply to damage or failure resulting from normal use, routine wear and tear, lack of maintenance, user error, alteration of the product, accidents, abuse, or neglect. This warranty is given in lieu of all other written or oral warranties, express or implied, including without limitation implied warranties of merchantability and fitness for a particular purpose, and are limited to the duration and specifications of this warranty. SeaSucker's liability for any damages relating to any allegedly defective product, whether arising from the use or the inability to use the product and whether claimed under tort, contract or any other legal theory, shall be limited to the actual price paid for such product and shall in no event include loss of use, loss of time, incidental, consequential, special, or indirect damages of any kind, even if SeaSucker is aware of the possibility of such damages, to the full extent as such may be disclaimed by law.

We love it when people share pics and videos of their SeaSucker racks on social media.

Tag us on Instagram and Facebook: @seasucker

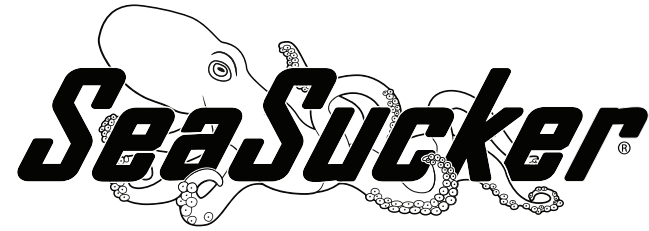

## READ THIS BEFORE USING YOUR SEASUCKER KOMODO

### WARNINGS

- Do not exceed the posted speed limit.
- Do not use if the indicator band is exposed on any of your SeaSucker's pumps.
- Do not use if all of your rack's vacuum cups cannot maintain a full vacuum seal for at least 4 hours at a time.
- Check the indicator band during use.
- Clean the mounting surface before attaching.
- Clean SeaSuckers before attaching.
- Clean and lube your SeaSuckers' pumps regularly.
- Komodo rack is for road bikes only.
- Attach protective covers when not in use.
- Make sure the vacuum pads are fully seated in the protective covers when not in use.
- Inspect screws, nuts, and bolts regularly and retighten if necessary.
- Do not use for bicycles over 45 pounds.
- Make sure the fork mount is fully clamped and secure before you transport your bicycle.

### What's In the Box:

- Komodo rack frame
- 9mm Fork Mount Plugs
- 5g Lube Tube for pump maintenance
- Spare vacuum pad and vacuum pump
- 12mm Fork Mount Plugs
- Fork-mount skewer and nut
- Hogg Front Wheel Holder
- Instruction Manual

**Care and Maintenance**  
 To get the most out of your Seasucker rack, inspect it regularly and store it with the vacuum cups' protective covers on. Check that all screws are securely tightened, including the screws attaching the vacuum pads to the Seasucker housing and the screws attaching the Seasuckers to the rack platform or bars.  
**Clean the vacuum cups before each use** with a sponge or soft cloth, mild dish soap and water. Do not use harsh solvents or abrasive cleaning pads. Make sure there is no dirt or debris on the sealing edge (the bottom outside edge) of the vacuum pad. Inspect the sealing edge for stiffness, cracks, roughness, or cuts – a cut will allow air to leak under the cup and will prevent your Seasucker from holding vacuum. A damaged vacuum pad should be replaced.  
**The vacuum pump should be cleaned regularly.** To clean the pump, pull the plunger straight out of the pump cylinder. Clean the inside of the cylinder with dish soap and a soft cloth or paper towel. Make sure to dry out the cylinder – water left in the cylinder can cause the pump to make a popping noise when pumped and may interfere with the check-valve rubber gasket at the tip of the plunger should be re-lubed with a thin layer of silicone-based gel lubricant, such as the Lube Tube that came with your rack. After cleaning, push the plunger back into the cylinder and pump it several times to seat it properly and distribute the lubricant.

Problem	What Might Be Wrong	How To Fix It
Slow Leakage	Dry mounting surface or vacuum pad	Moisten the mounting surface or the vacuum pad
	Nicks or cuts on vacuum pad	Replace the vacuum pad
	Dirt in pump	Clean and re-lube the plunger and pump cylinder
	Dry pump	Re-lube the plunger seal
	Dirt on vacuum pad	Clean the vacuum pad
	Dirty or uneven mounting surface	Clean the mounting surface or move to a more suitable spot
Severe Leakage	Dirty or uneven mounting surface	Clean the mounting surface or move to a more suitable spot
	Damaged pump	Replace the vacuum pump
	Nicks or cuts on vacuum pad	Replace the vacuum pad
Jammed or Sluggish Pump	Obstructed valve stem	Remove the obstruction; clean and re-lube the pump
	Dry pump	Re-lube the plunger seal
	Dirt in pump	Clean and re-lube the plunger and pump cylinder

**TROUBLESHOOTING GUIDE**

**The Rack's Responsibility**  
 With all Seasucker vacuum mounts fully engaged, the rack will securely hold road bicycles up to 45 pounds each at speeds up to 75 mph. The rack will indicate if the Seasuckers are not maintaining vacuum: each Seasucker has an orange power indicator band in the pump that will extend out and become visible upon loss of vacuum. If you see the indicator band, you must re-pump the Seasucker before the rack can be safely used again.  
**Your Responsibility**  
 You must inspect the indicator bands on all Seasuckers when entering and exiting your vehicle. A quick glance will tell you if the rack is at full power. If the indicator band is visible, you must re-pump the Seasucker before the rack can be used. If any of your Seasuckers do not hold vacuum for at least 4 hours, they may need to be cleaned, repaired, or replaced. Your rack comes with an extra Seasucker vacuum cup; keep it with your rack in case you accidentally damage one of your vacuum cups.

**Assembly**  
**For 9mm QR Fork Mounts:** Insert the black fork mount plugs into the holes in the head of the rack. The collars of the plugs should be touching the sides of the rack if fully inserted. Unscrew the nut from the fork mount skewer and push the skewer through either side of the fork mount at the front of the rack. Make sure the concave side of the black skewer washer is situated directly next to the quick-release lever. Screw the nut loosely back on to the skewer. Follow the instructions below for setting the lever tension for the first time.  
**For 12mm Thru-Axle Fork Mounts:** Insert the silver fork mount plugs into the holes in the head of the rack. The collars of the plugs should be touching the sides of the rack if fully inserted.  
 Finally, unfold the rack's tail, making sure the locking pin under the tail joint is fully engaged.

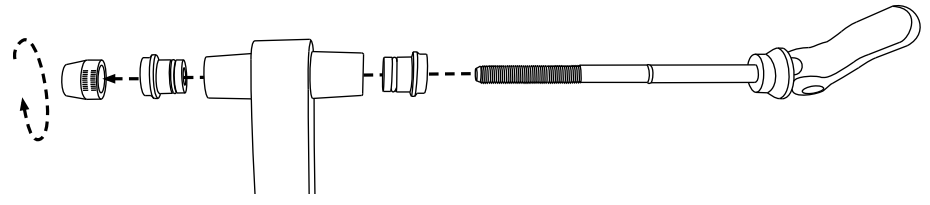

### Check for the Indicator Band During Use

SeaSucker vacuum mounts are not intended to be permanent fixtures on your car - they will lose vacuum over time. When your vacuum cup loses vacuum, it will warn you by extending the pump's plunger, exposing an orange band. You are required to monitor your vacuum cups during use. When getting in or out of your car, check to see if the indicator band is visible on any of the rack's vacuum cups. If you see the band, simply pump the SeaSucker as described above.

If the indicator band appears less than four hours after being pumped to full strength, either cleaning, maintenance or repositioning may be required. If your rack is mounted on a scratched surface, move the rack to a more suitable position. If the mounting surface or vacuum cup is dirty, clean it. If these steps don't stop the vacuum cup from losing vacuum prematurely, discontinue use until the problem is resolved. Replace the suspect vacuum cup with the spare that came with your rack if necessary - additional replacement parts can be purchased in the Replacement Parts section of our on-line store.

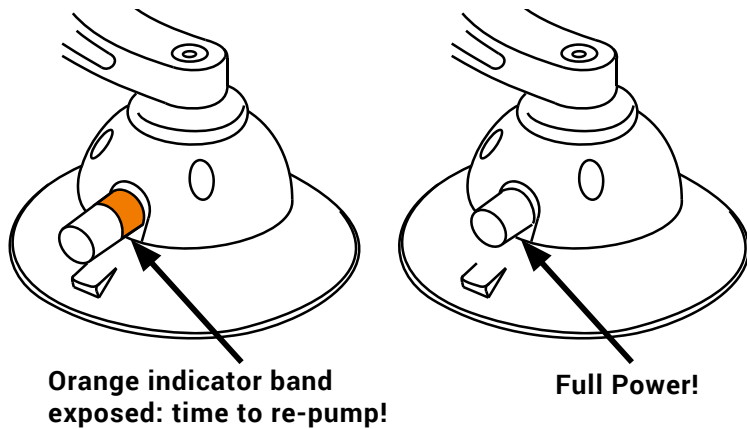

### Weather Conditions

SeaSuckers can be used in cold weather. The vacuum pads will stiffen in colder temperatures. Because the vacuum pads need to conform to the mounting surface when you attach them, it is highly recommended that you store your rack at room temperature (60F+) prior use. You will not be able to properly attach the vacuum cups if they are too cold. Mounting surfaces must be free of ice, snow, dirt and any other potential obstruction to making a full vacuum seal. Rain and wet weather should not affect the performance of your SeaSucker rack. If rain or water gets inside any of your vacuum pumps, pull the plunger out and dry the inside of the pump cylinder with a paper towel. Re-lube the plunger gasket if necessary and reinsert the plunger in the pump cylinder. Screws or other metal parts that show signs of rusting or corrosion should be replaced.

### Where to Attach

The Komodo is designed to attach to a car's trunk, roof top, or rear windshield.

- **DO NOT** mount bicycles with the handles bars facing the rear of the vehicle.
- **DO NOT** mount bicycles sideways.
- For roof mounting, position the rack near the front or rear windshield where the roof has more internal support. The metal in the middle of some car roofs may not be sturdy enough to support the weight of your bicycle and rack.
- For hatchback/SUV/van mounting, make sure the bicycle's rear wheel does not hang lower than the bottom of the vehicle's bumper.

Each vacuum cup on your rack should attach to a clean, unobstructed, metal or glass surface. The vacuum cups will not attach over a seam or other surface incongruity. Attaching your rack to a sunroof is done at your own risk and we strongly recommend that you test the strength and suitability of your sunroof first.

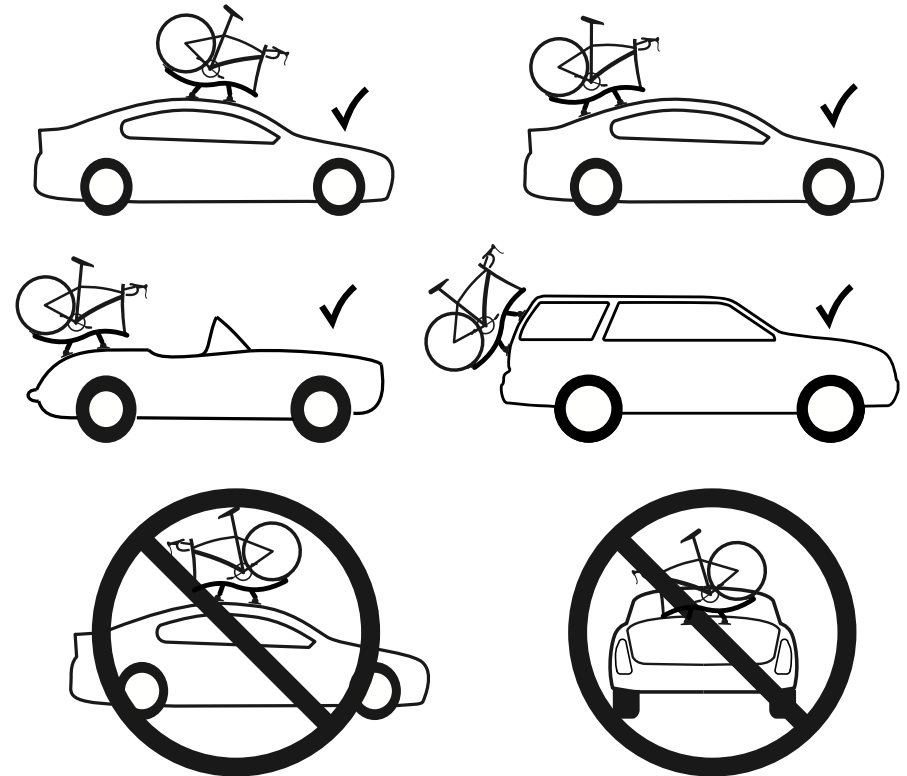

## Attaching Your Rack - Clean, Wet, and Pump

Clean the surface where you will mount the rack. Dust and dirt will affect your Seasuckers' ability to create and hold vacuum. Remove the protective cover from each Seasucker and inspect the rubber vacuum cup for damage or dirt. Do not use your rack if there is any visible damage to the vacuum cup. If the vacuum cup is dirty, clean it with a mild soap and water solution and a soft cloth or sponge.

Moisten the bottom edge of each vacuum cup or the mounting surface with water - do not use cleaners, lubricants, or other liquids. Press the vacuum cup against the mounting surface to make a full seal; you may need to press firmly down on the body of the rack to ensure that the vacuum pad is fully connecting with the mounting surface when pumping. Pump the Seasucker repeatedly until the plunger doesn't spring back and the indicator band is hidden inside the pump cylinder. Repeat this for all Seasuckers on the rack. If the plunger won't stay seated in the pump cylinder or continues to extend out immediately after pumping, you may need to clean the mounting surface or the vacuum cup or pump, perform basic maintenance on the vacuum cup or pump, or move the rack to a more suitable mounting position. Do not use your rack without correcting the problem!

4

### Attach:

1. Remove protective cover.
2. Place on a smooth, clean surface.
3. Swivel vacuum mount so that it sits flat on the mounting surface.
4. Press pump repeatedly until orange indicator band is no longer visible.

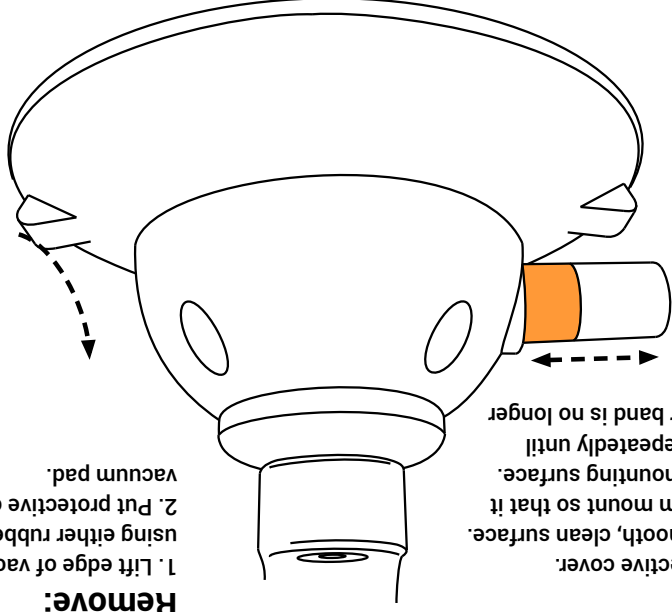

- ### Remove:
1. Lift edge of vacuum pad using either rubber tab.
  2. Put protective cover on vacuum pad.

## Using your Hog Front Wheel Holder

### Set Up:

Replace the skewer nut on your bike's rear wheel with the threaded skewer nut included with the Hog.

### Attaching the Front Wheel:

1. Screw the Hog onto the threaded skewer nut. **Note that the Hog and skewer nut have reverse threads - turn the Hog counter-clockwise to attach and clockwise to remove.**

2. Attach your front wheel to the Hog by inserting the wheel's skewer nut into the Hog cavity. Tighten the skewer as you would normally to secure the wheel to the Hog.

3. Thread the Anti-Rotation Strap around and through both the front and read wheels to keep your front wheel from spinning while driving.

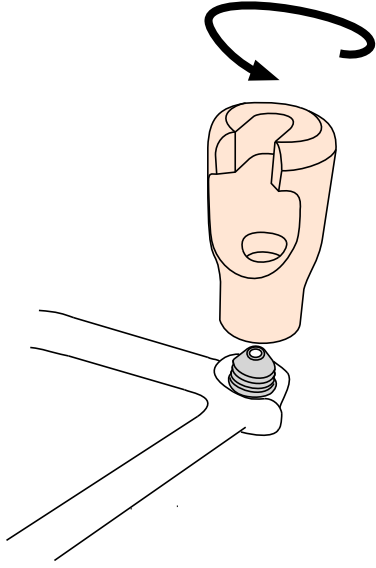

- ### Removing the Front Wheel:
1. Remove the orange Vencro it in a safe place.
  2. Unclamp your front wheel and remove it from the Hog
  3. Unscrew the Hog from the rear skewer nut (**clockwise**) and store it in a safe place.

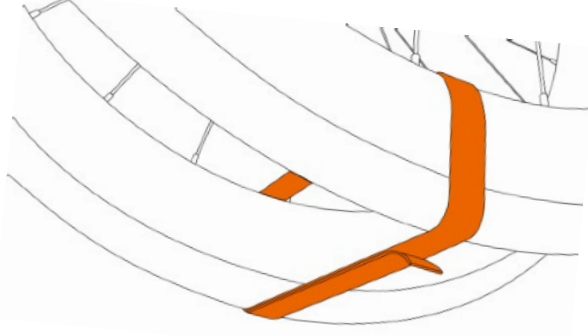
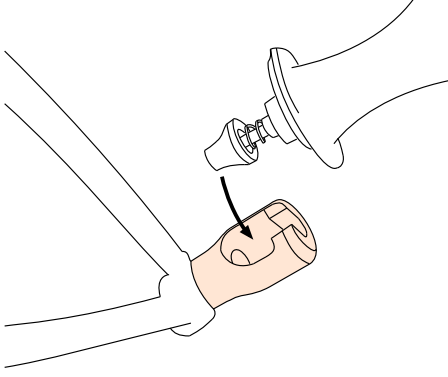

6

### Using the Rear Wheel Strap and Buckle

Place your bicycle's rear tire on the black tire platform at the tail of the rack. Push the strap through a gap in your rear wheel's spokes and thread the end of the strap into the ratcheting buckle on the other side of the rack's tail. Position the rim pad on the strap so that the pad will be centered over the rim when tightened down. Lift the buckle repeatedly to tighten the strap until your rear wheel is secure. To release the rear wheel strap, push the tab in the middle of the buckle towards the top of the buckle while simultaneously pulling on the strap until the strap is free from the buckle.

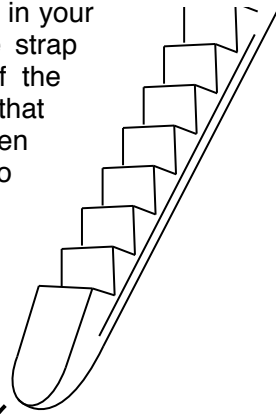

Insert the strap  
in this slot

Pull on this lever to  
release the buckle

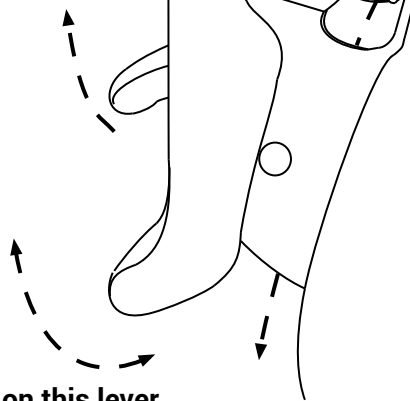

Pull up on this lever  
to tighten the buckle

### Locking Your Bike and Rack

Because SeaSucker bike racks cannot be permanently attached to your car, you should exercise caution when leaving your bike or rack unattended. When not using your rack, we recommend that you remove and properly store the rack in your home or car. You can lock your bike and rack to your car using one of SeaSucker's Cable Anchors. Cable Anchors provide a sturdy steel loop for attaching a cable-type lock.

Most surfaces on your car have a slight curve. The vacuum cups on your Komodo are articulating - each should move with slight pressure to parallel the mounting surface underneath it and make a solid connection between the rack and the car. Additionally, the rear legs of your Komodo are hinged to allow the rack to attach to even very small spaces. After determining where to attach your Komodo, pull the rear legs backwards to give the rack the largest possible footprint allowed by the space where you are attaching the rack.

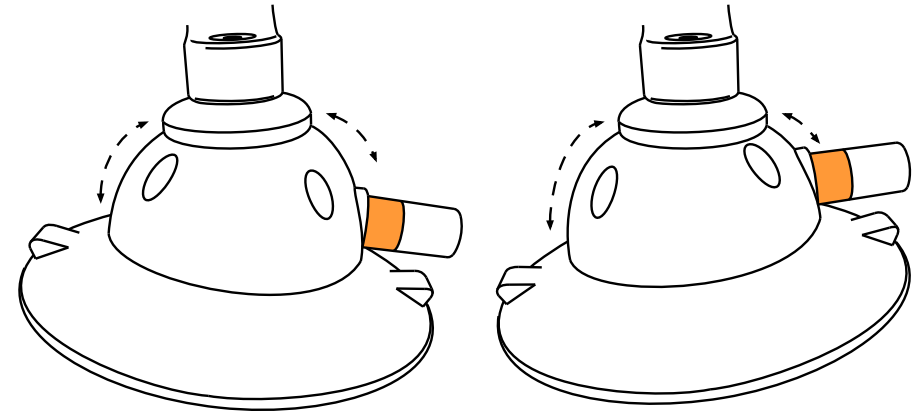

### Removing Your Rack - Lift and Cover!

Remove your bike from the rack by unclamping the fork mount and unstrapping the Velcro from the back wheel. With your fingertip, use one of the tabs on the SeaSucker's vacuum pad to lift the edge of the cup up from the mounting surface and break the vacuum seal.

Always put protective covers back on when the rack is not attached to your car to protect the vacuum pads. Make sure the rubber of the vacuum pad is fully seated in the protective cover before storing it. The edge of the vacuum cup could be damaged or deformed if the vacuum pad isn't fully seated in the protective cover.

Videos demonstrating how to remove your SeaSucker rack can be found on-line at [www.SeaSucker.com](http://www.SeaSucker.com).

## Mounting Your Bike on a Komodo with a 9mm QR

It is easier to set the tightness of the cam lever for the first time before mounting your rack to your vehicle.

1. Place your Seasucker rack on the floor. Leave the protective covers on the vacuum pads to avoid accidental damage to the pads.
2. Open the fork mount's quick release - place the cam lever in the open position and turn the adjustment nut counterclockwise to loosen it until it is almost at the end of the skewer.
3. Remove the front wheel from your bicycle.

4. Place your bicycle's fork dropouts onto the skewer. Make sure the QR washer is next to the cam lever. If your bicycle won't balance on its own, have a helper hold on to it.

5. Push the skewer as far through the body of the fork mount as possible by pressing the cam lever towards your fork (while still in the open position). **IMPORTANT:** the cam lever, QR washer and the leg of your fork should be pressed tightly together against the body of the fork mount with no gaps in between them. Strike the cam lever with the heel of your palm if necessary to ensure full penetration.

6. Turn the adjustment nut clockwise until it is finger-tight against the other side of the fork.

7. Unscrew the adjustment nut six full turns. Mark the nut in some way to keep track of the number of turns.

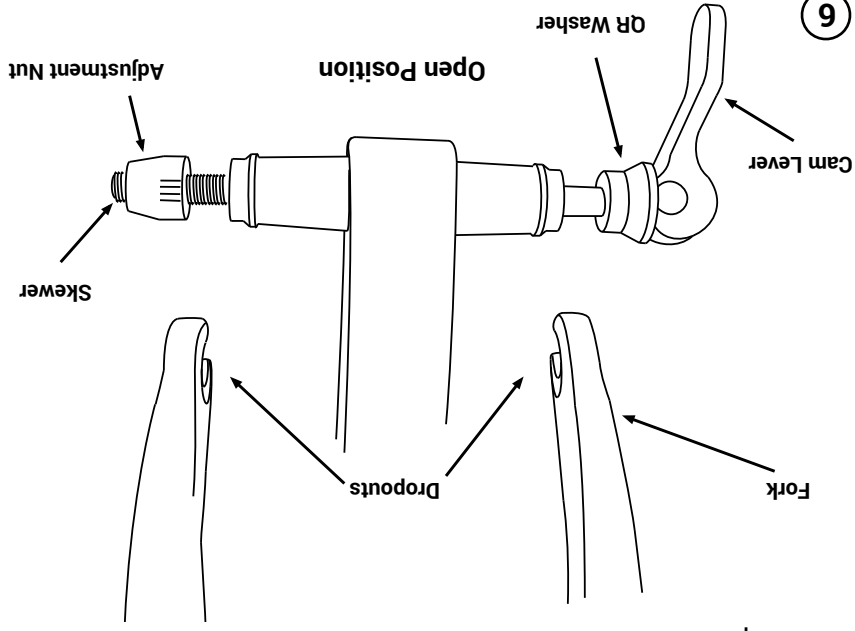

6

8. Flip the cam lever into the closed position. The lever should swing approximately 180 degrees. You should feel the cam lever starting to tighten just past 90 degrees of swing. It should take firm pressure to fully close the lever, but not so much pressure that it won't close fully. If you are not closing it 180 degrees, or the lever or forks feel loose, you are doing it wrong! Go back to step 5 and try again.

The 9mm QR fork mount has a large cam, which means that you probably won't have to loosen or tighten the adjustment nut every time you mount or remove your bicycle from the rack.

## Mounting Your Bike on a Komodo with a 12mm Thru-Axle Fork Mount

1. Remove the front wheel from your bicycle.
2. Place your bike's forks on the head of the rack, lining up the axle holes on the fork and the fork mount.
3. Push your wheel's axle through the holes, turn it to screw into the opposite side of the fork, and close the lever. Installing your axle should be the same as when your reattach your front wheel. Consult your wheel or hub maker's instructions for more information.

**Test the tightness of the fork mount by gripping your fork and firmly pulling and pushing. If the fork moves in the mount in any way, you should adjust the adjustment nut and re-clamp your fork to tighten the fork mount.**

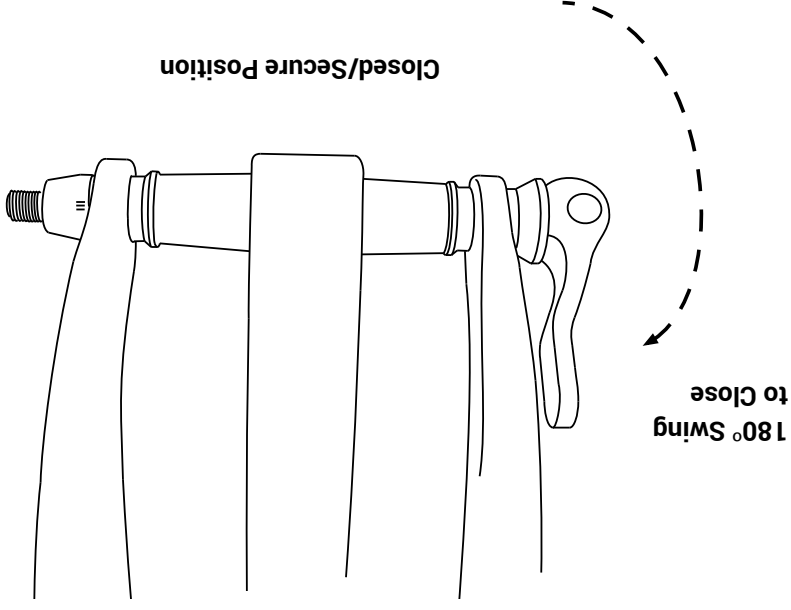

7