



Silver Spring®

by DiscountRamps.com®

Instructions for Part # MWCC



General Guidelines

- It is the user's responsibility to read and follow all instructions.
- Keep these instructions with the product at all times and review before each use.
- It is the responsibility of this product's owner to furnish the instructions to any person that borrows or purchases the product.
- Inspect the product before use to ensure it is assembled properly and all parts are in safe working order and free of defects.
- Never modify this product in any way.
- All circumstances cannot be addressed in these instructions. Please use common sense and practice general safety measures when using this product.
- Parts and/or instructions are subject to change without notice.

Safety

- Do NOT stand on the carrier.
- Never exceed vehicle tongue weight rating.
- Always store the carrier in a safe place.
- Only use the carrier with a Class I, II, III or IV 2" hitch adapter.
- Improper use, storage, or installation of the carrier could result in death or serious injury.
- Do NOT put the product on any kind of trailer.
- The carrying capacity is 100 lbs.
- Periodically check nuts and bolts for tightness.

Tools Required

- 10mm wrench
- 17mm wrench
- 19mm wrench
- 1" wrench
- 3/16" Allen wrench

Parts

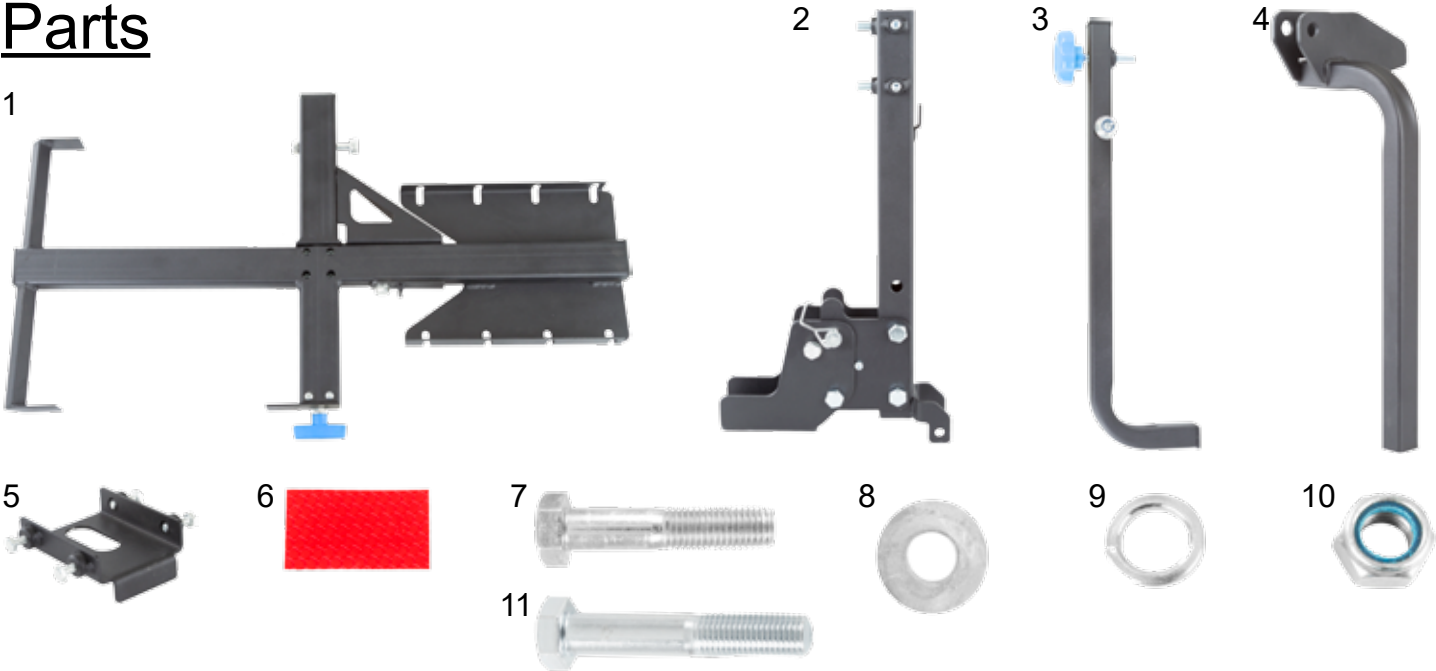

Part	Description	Quantity
1	Carrier Platform	1
2	Support Tube	1
3	Hold Down Arm	1
4	Hold Down Inner Arm	1
5	Stabilizer	1
6	Reflector	3

Part	Description	Quantity
7	M16x85 Bolt (Use 1" wrench)	1
8	M16 Washer	2
9	M16 Lock Washer	2
10	M16 Lock Nut	2
11	M16x90 Bolt (Optional)	1

Assembly

Step 1. Install carrier platform (1) to support tube (2) with carrier platform bolt, washers, and lock nut. Tighten with 17mm wrench.

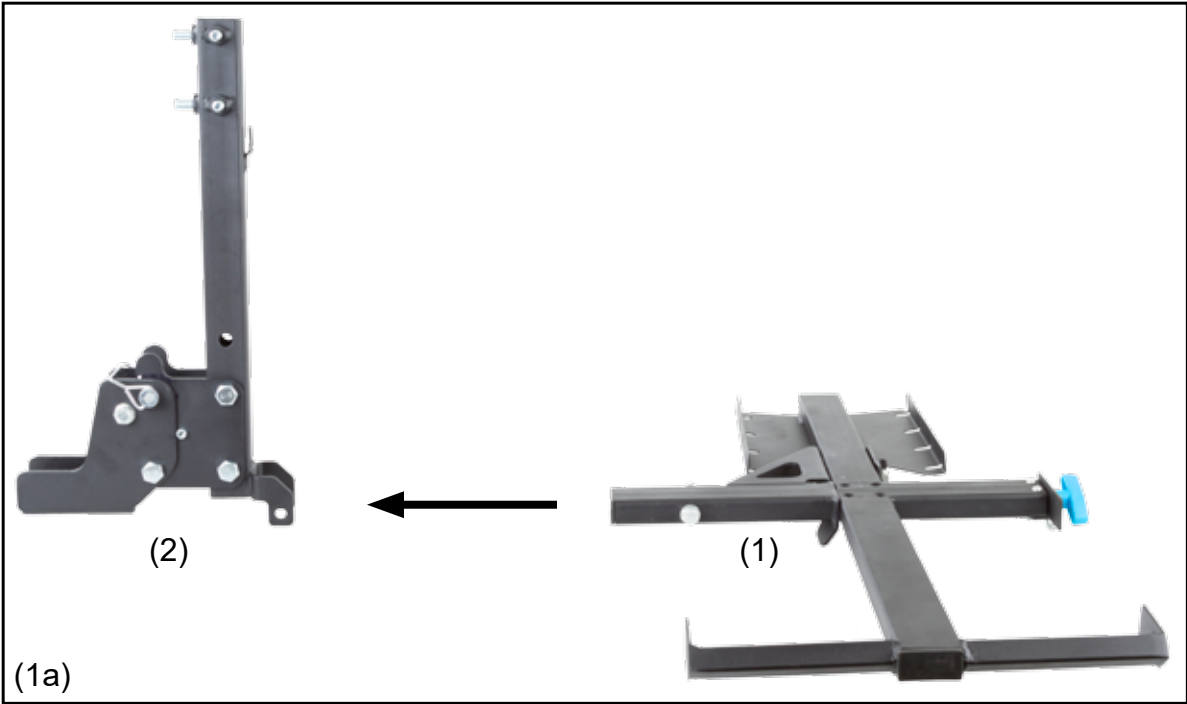

Step 2. Install hold down inner arm (4) to support tube (2).

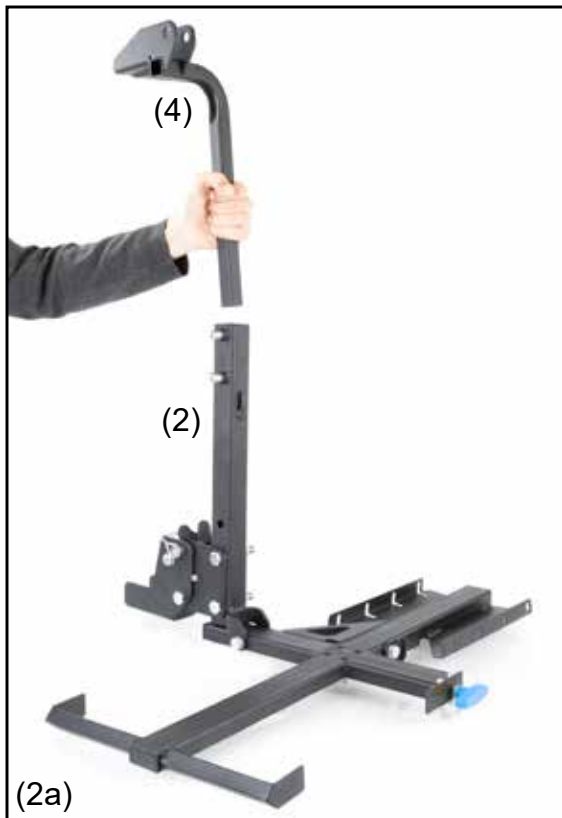

Step 3. Install hold down arm (3) to hold down inner arm (4) with hold down arm bolt, washers, and lock nut. Tighten with 17mm wrench.

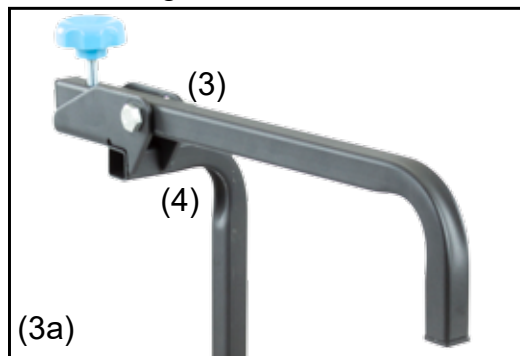

IMPORTANT

Install washers in between hold down inner arm and hold down arm. This will allow the arm to stay in position when loading and unloading wheelchair.

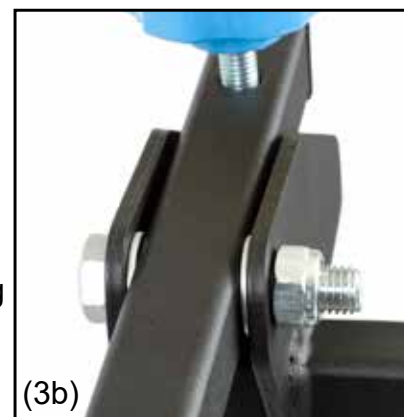

Step 4. Install stabilizer (5) to vehicle hitch adapter. Tighten side bolts with 10mm wrench.

*Stabilizer is optional depending on mounting option used. Please refer to "Determine Best Mounting Height" on Page 6.



Step 5. Install carrier to hitch adapter and stabilizer with M16x85 bolt (7), M18 washers (8), M18 lock washer (9), and M18 lock nut (10). Secure with 1" wrench.



Step 6. Adjust height of hold down inner arm to best accommodate wheelchair (6a).



Step 7. Tighten support tube Allen wrench set screws with 3/16" Allen wrench (7a).



Loading Wheelchair

Step 1. Pull handle to tilt carrier into loading position.



Step 2. Push down on wheelchair handles, tilting the front wheels off the ground. Roll wheelchair onto carrier platform. With larger wheels in platform cradle, lift up on wheelchair handles. Carrier will tilt and lock into position.



Step 3. Tighten hold down arm onto wheelchair armrests by turning knob clockwise (3a). The wheelchair is now ready for transport (3c).



Folding Carrier

With carrier unoccupied, swing down hold down arm (1a). Flip up carrier platform towards support tube. Pulling handle up, place bracket slot onto locking tab of support tube (1b).



Tilt Away Feature

For trunk access, the carrier can be swung down in the folded position by removing safety pin. Do NOT attempt to transport carrier in folded down position.

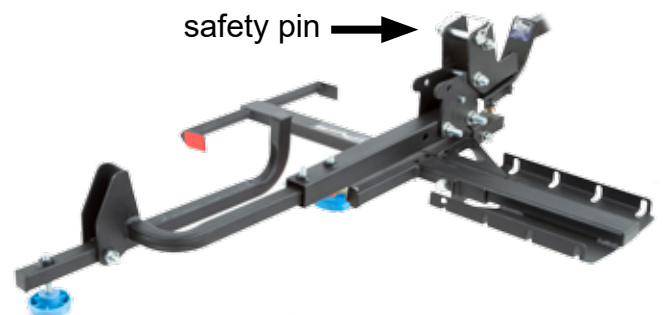

Determine Best Mounting Height

The MWCC requires an 8-12" ground clearance from the bottom of the unfolded carrier platform, this will provide an appropriate degree of tilt for loading and unloading your wheelchair.

It is recommended to measure the distance from the hitch bar to ground (A). Please refer to the diagram below (B) for the best mounting option with support tube.

Note: Mounting options 3 and 4 do NOT require use of stabilizer (5).

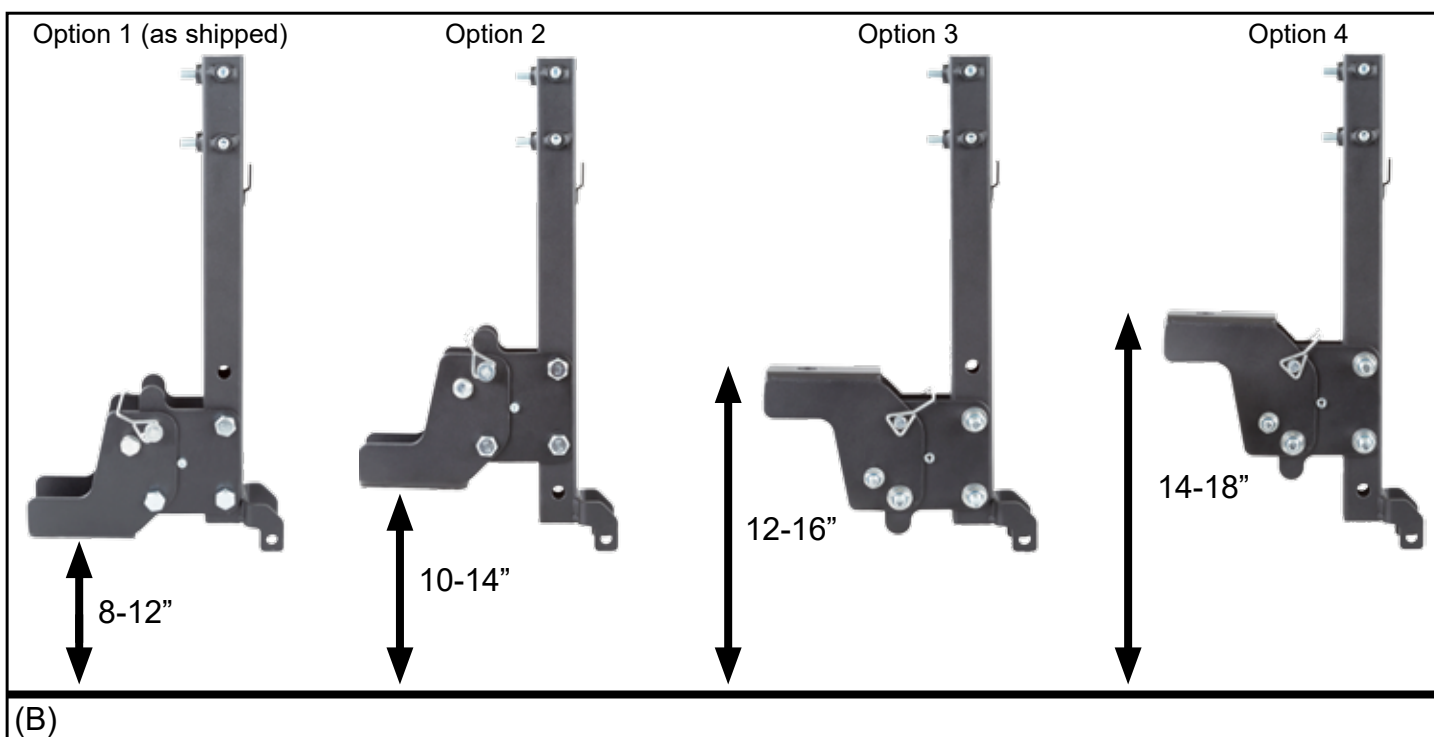
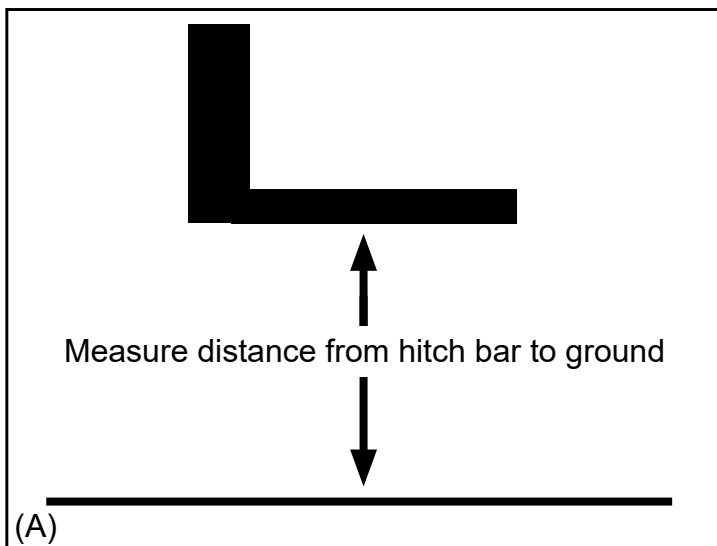

Product Warranty and Liability

GENERAL PRODUCT WARRANTY: Products purchased from the Authorized Dealer (original place of purchase) or Merchant ("Dealer") will be free of defects in material and workmanship at the time of receipt, and will meet the specifications stated at the place of purchase transaction or online at the Dealer's website, under normal use and service when correctly installed, operated and maintained. This product warranty is effective for the period of time stated below, unless otherwise stated in the product instructions or depicted in the product advertisement. **All Authorized Dealer warranties are NON-TRANSFERABLE** and cover only the original end purchaser. This limited warranty does not cover products purchased through non-authorized dealers. Non-authorized dealer receipts are not accepted for warranty verification.

*****Warranty claims must be made directly to the original place of purchase.*****

WARRANTY PERIOD: This warranty remains in force for one year from the date of the product's accepted delivery. The Authorized Dealer offers a one year manufacturer's warranty for most products unless otherwise specified on the product advertisement.

WARRANTY SERVICE: The Authorized Dealer will replace any defective or malfunctioning part at no charge, including payment of the shipping costs of parts or replacement product to and from the manufacturer. The purchaser is responsible for labor charges. If the product does not meet specifications as depicted in the advertisement, the Authorized Dealer will refund the full purchase price of the product.

Questions regarding the warranty on a specific product and warranty claims should be directed to the Authorized Dealer with whom the purchase transaction was made.

WARRANTY LIMITATIONS: The above warranty does not apply to products that are repaired, modified or altered by any party other than the Authorized Dealer; are subjected to unusual physical stress or conditions (such as overloaded ramps or corrosion), natural disaster, governmental actions, wars, strikes, labor disputes, riots, theft, vandalism, terrorism or any reason beyond reasonable control; are damaged due to improper installation, misuse, abuse, accident or negligence in use, storage, transportation or handling, or tampering; or to products that are considered consumable items or items requiring repair or replacement due to normal wear and tear.

Product should be inspected prior to signing for delivery. Product damage incurred during shipping, unless noted on the Bill of Lading at the time of delivery, renders this warranty void.

LIMITED LIABILITY: In no event shall THE AUTHORIZED DEALER be liable to the purchaser or any third party for any indirect, incidental, consequential, special, exemplary or punitive damages arising out of the use of the product, including, without limitation, property damage, loss of value of the product or any third party products that are used in or with the product, or loss of use of the product or any third party products that are used in or with the product.



DiscountRamps.com
1-888-651-3431
760 S. Indiana Ave.
West Bend, WI 53095