



Instructions for Part # SNO-FS-LIFT

General Guidelines

- It is the user's responsibility to read and follow all instructions.
- Keep these instructions with the product at all times and review before each use.
- It is the responsibility of this product's owner to furnish the instructions to any person that borrows or purchases the product.
- Inspect the product before use to ensure it is assembled properly and all parts are in safe working order and free of defects.
- Never modify this product in any way.
- All circumstances cannot be addressed in these instructions. Please use common sense and practice general safety measures when using this product.
- Parts and/or instructions are subject to change without notice.

Parts

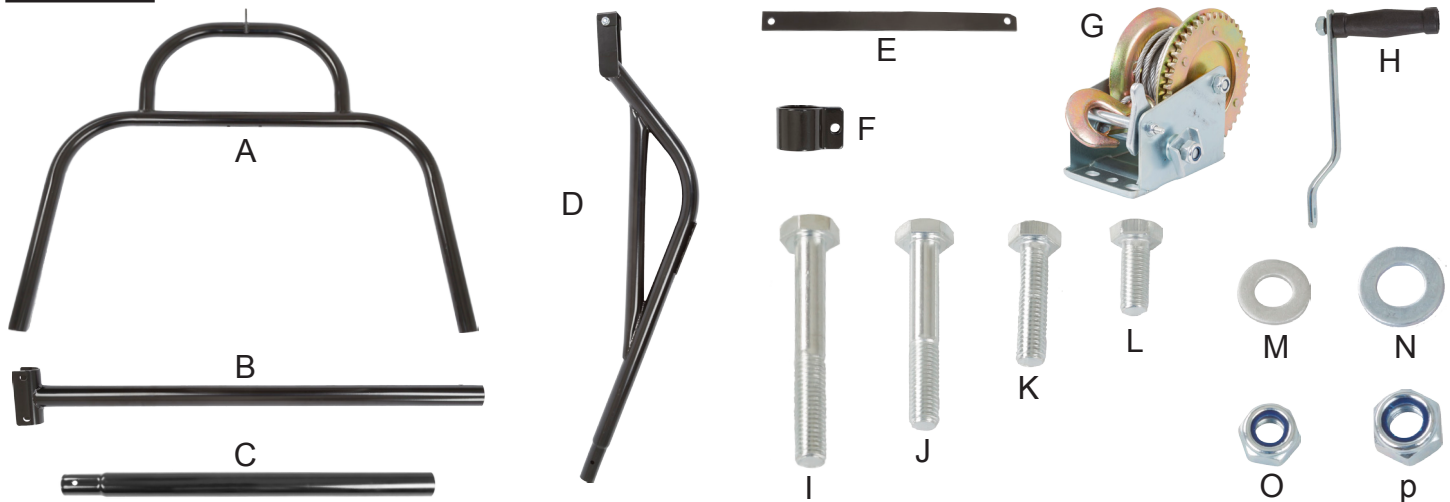

Part	Description	Quantity
A	Base	1
B	Center Support	1
C	Extension Leg	2
D	Support Arm	1
E	Support Bar	1
F	Support Bar Bracket	1
G	Winch	1
H	Winch Handle	1
I	M10x1.25x75 Bolt (use 17mm or 11/16" wrench)	4

Part	Description	Quantity
J	M10x1.25x65 Bolt (use 17mm or 11/16" wrench)	1
K	M12x1.25x45 Bolt (use 19mm or 3/4" wrench)	1
L	M12x1.25x28 Bolt (use 19mm or 3/4" wrench)	1
M	M10 Flat Washer	5
N	M12 Flat Washer	2
O	M10x1.25 Lock Nut (use 17mm or 11/16" wrench)	5
P	M12x1.25 Lock Nut (use 19mm or 3/4" wrench)	2

Tools Required

- 17mm or 11/16" wrench
- 19mm or 3/4" wrench
- 3/8" wrench

Assembly

Step 1. Install extension legs (C) to base (A).

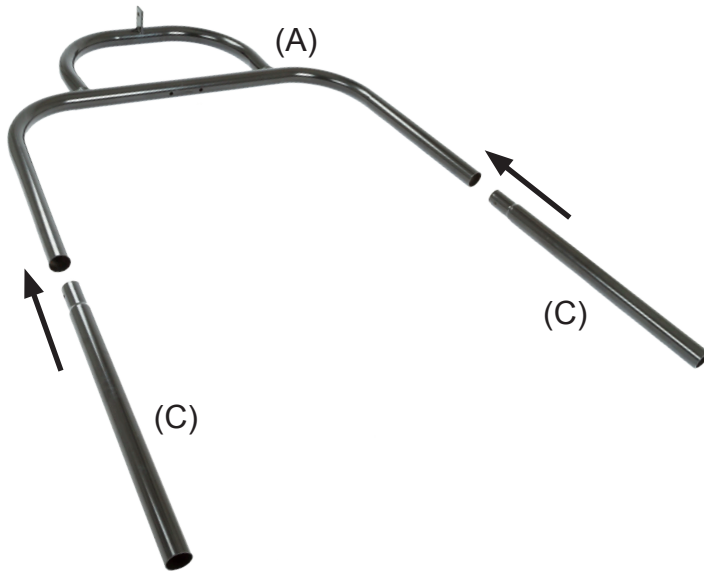

Step 2. Install center support (B) to base (A) with (2) M10x1.25x65 bolts (J). Secure each bolt with (1) M10 flat washer (M) and (1) M10x1.25 lock nut (O). Tighten with 17mm or 11/16" wrench.

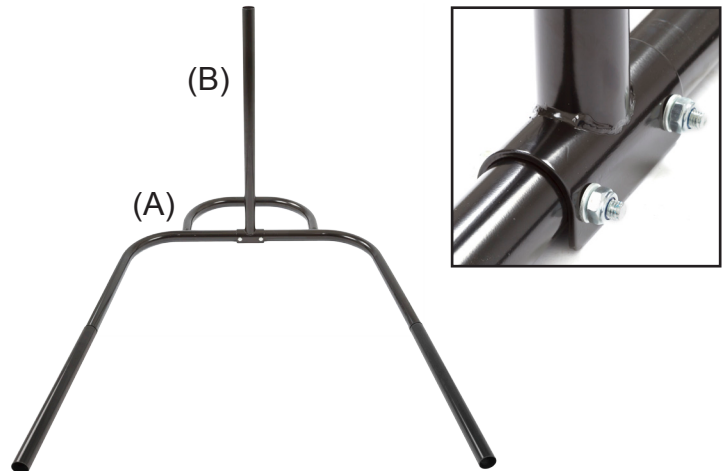

Step 2. Slide support bar bracket (F) over center support (B).

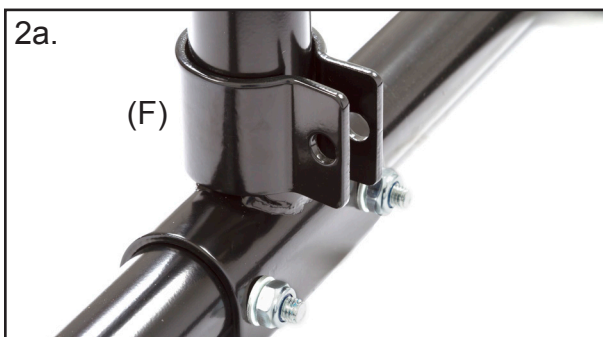

Step 3. Install support bar (E) to base with M12x1.25x28 bolt (L). Slide bar bracket (F) up center support (B) and install support bar to bar bracket with M12x1.25x45 bolt (K). Secure each bolt with (1) M12 flat washer (N) and (1) M12x1.25 lock nut (P). Tighten with 19mm or 3/4" wrench.



Step 4. Install support arm (D) into center support (B) with M10x1.25x65 bolt (J). Secure with M10 flat washer (M) and M10x1.25 lock nut (O). Tighten with 17mm or 11/16" wrench.

Step 5. Remove lock nut from winch (F). Install winch handle (H) to winch with lock nut. Tighten with 19mm or 3/4" wrench.

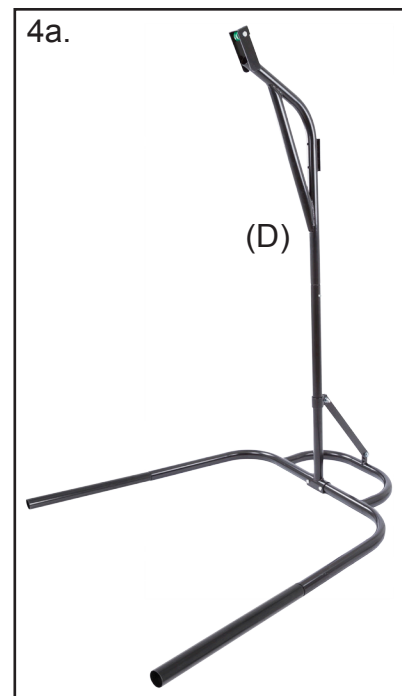
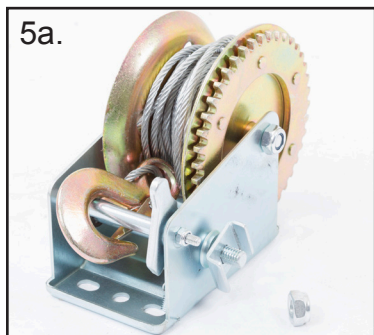

Step 6. Fully unwind cable from winch. Remove locking bar from winch with 3/8" wrench. Install winch to support arm (D) with (2) M10x1.25x75 bolts (I). Secure each bolt with M10 flat washer (M) and M10x1.25 lock nut (O). Tighten with 17mm or 11/16" wrench.

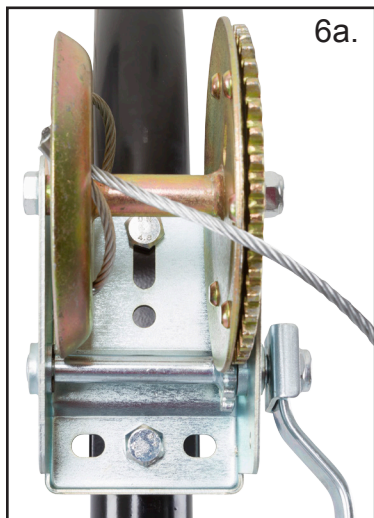

Step 7. Reinstall locking bar to winch with 3/8" wrench. Make sure spring is attached to winch. Rewind cable - keep some slack to provide enough length to reach pulley (next step).

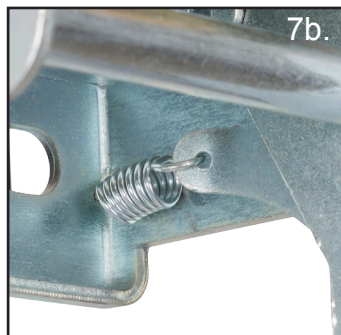
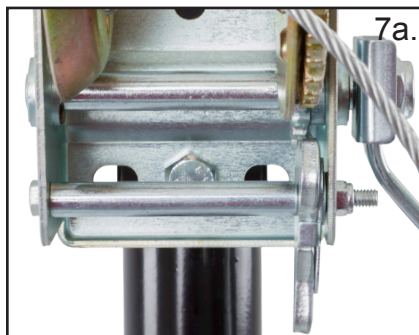

Step 8. Loosen top pulley bolt with 17mm or 11/16" wrench. Slide pulley cover off and place steel cable on pulley. Reinstall pulley cover, tighten.

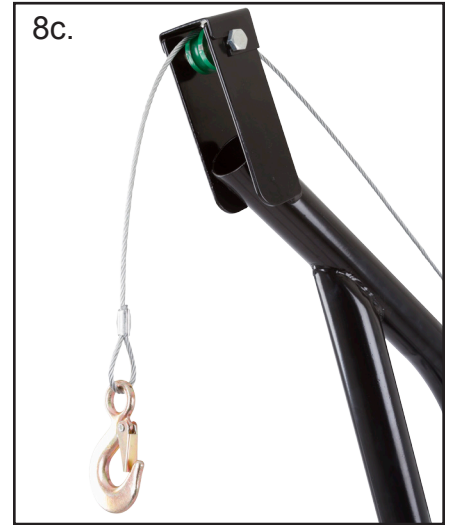

Locking / Unlocking Winch

Locked Position



Unlocked Position



Product Warranty and Liability

GENERAL PRODUCT WARRANTY: Products purchased from the Authorized Dealer (original place of purchase) or Merchant ("Dealer") will be free of defects in material and workmanship at the time of receipt, and will meet the specifications stated at the place of purchase transaction or online at the Dealer's website, under normal use and service when correctly installed, operated and maintained. This product warranty is effective for the period of time stated below, unless otherwise stated in the product instructions or depicted in the product advertisement. **All Authorized Dealer warranties are NON-TRANSFERABLE** and cover only the original end purchaser. This limited warranty does not cover products purchased through non-authorized dealers. Non-authorized dealer receipts are not accepted for warranty verification.

*****Warranty claims must be made directly to the original place of purchase.*****

WARRANTY PERIOD: This warranty remains in force for one year from the date of the product's accepted delivery. The Authorized Dealer offers a one year manufacturer's warranty for most products unless otherwise specified on the product advertisement.

WARRANTY SERVICE: The Authorized Dealer will replace any defective or malfunctioning part at no charge, including payment of the shipping costs of parts or replacement product to and from the manufacturer. The purchaser is responsible for labor charges. If the product does not meet specifications as depicted in the advertisement, the Authorized Dealer will refund the full purchase price of the product.

Questions regarding the warranty on a specific product and warranty claims should be directed to the Authorized Dealer with whom the purchase transaction was made.

WARRANTY LIMITATIONS: The above warranty does not apply to products that are repaired, modified or altered by any party other than the Authorized Dealer; are subjected to unusual physical stress or conditions (such as overloaded ramps or corrosion), natural disaster, governmental actions, wars, strikes, labor disputes, riots, theft, vandalism, terrorism or any reason beyond reasonable control; are damaged due to improper installation, misuse, abuse, accident or negligence in use, storage, transportation or handling, or tampering; or to products that are considered consumable items or items requiring repair or replacement due to normal wear and tear.

Product should be inspected prior to signing for delivery. Product damage incurred during shipping, unless noted on the Bill of Lading at the time of delivery, renders this warranty void.

LIMITED LIABILITY: In no event shall THE AUTHORIZED DEALER be liable to the purchaser or any third party for any indirect, incidental, consequential, special, exemplary or punitive damages arising out of the use of the product, including, without limitation, property damage, loss of value of the product or any third party products that are used in or with the product, or loss of use of the product or any third party products that are used in or with the product.



DiscountRamps.com
1-888-651-3431
760 S. Indiana Ave.
West Bend, WI 53095