

READ THIS BEFORE USING YOUR MONKEY BARS!

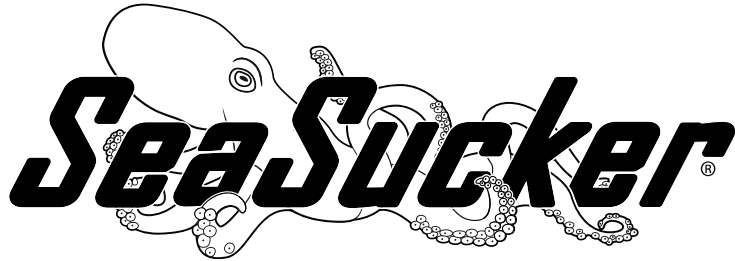

SeaSucker, LLC
Bradenton, Florida
www.SeaSucker.com

What's in the Box

- (2) Front bar mounts with (2) 6" SeaSucker vacuum cups attached
- (2) Rear bar mounts with (1) 6" SeaSucker vacuum cup attached
- (2) Aluminum cross bars
- (1) 5g Lube Tube (for vacuum pump maintenance)
- (1) spare SeaSucker vacuum pump (for maintenance)
- (1) 5/32 hex wrench (for assembly)

Please contact SeaSucker directly if any of these components are missing or damaged.

WARNINGS

- Do not exceed the posted speed limit.
- Do not use if the indicator band is exposed on any of your SeaSucker's pumps.
- Do not use if all of your rack's vacuum mounts cannot maintain a full vacuum seal for at least 4 hours at a time.
- Check the indicator band during use.
- Clean the mounting surface before attaching.
- Clean SeaSuckers before attaching.
- Clean and lubricate your SeaSuckers' pumps regularly.
- Remove racks when not in use.
- Attach protective covers when not in use.
- Inspect housing screws regularly and retighten if necessary.
- Inspect clamp screws regularly and retighten if necessary.

The Rack's Responsibility

With all SeaSuckers fully engaged, the rack will securely hold at speeds of up to 70 mph. The rack will indicate if the SeaSuckers are not maintaining vacuum: the indicator band in the pump of each SeaSucker will extend out and become visible upon loss of vacuum. If you see the indicator band, you must re-pump the SeaSucker before the rack can be safely used again.

Your Responsibility

You must inspect the indicator bands on all SeaSuckers when entering and exiting your vehicle. A quick glance will tell you if the rack is at full power. If the indicator band is visible, you must re-pump the SeaSucker before the rack can be used. If any of your SeaSuckers do not hold vacuum for at least 4 hours, they may need to be cleaned, repaired, or replaced. Your rack comes with an extra SeaSucker vacuum pump; keep it with your rack in case you accidentally damage one.

Assemble Your Monkey Bars

The SeaSucker Monkey Bars require simple assembly to be ready for use. Ideally, you will assemble your rack near your vehicle so you can custom fit the rack to your roof.

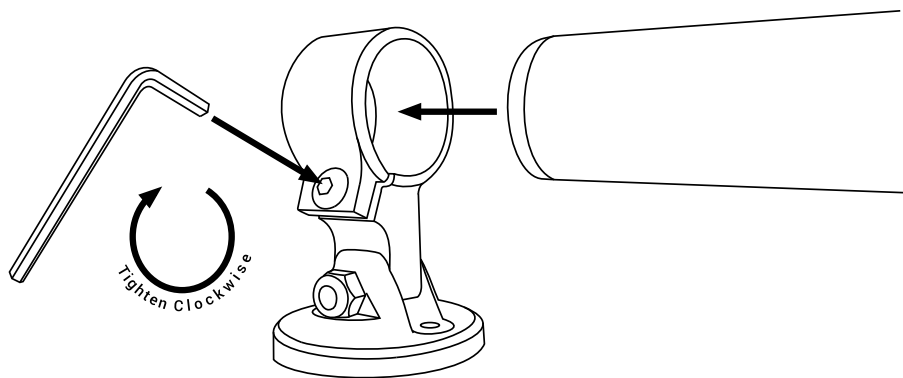

Separate the front bar mounts (the ones with the round clamp on a platform in between two SeaSucker vacuum mounts) and the rear bar mounts (the ones with the round clamp mounted directly on top of one SeaSucker vacuum mount). If you purchased the folding bars, unfold them and push them together to form a solid bar. Slide one of the front bar mounts onto one of the cross bars. Slide the other front bar mount onto the other side of the same bar; make sure the vacuum pumps on the mounts are pointing in the same direction. Remove the protective covers from the mounts and place the bar and mounts onto the roof of your vehicle just behind the front windshield; the vacuum pumps should be pointing towards the rear of the vehicle. Position each of the front bar mounts as near to the front corners of the roof as you can (see “Where to Attach” below). Attach the vacuum mounts (see “To Attach Your Rack” below) and center the cross bar between the front bar mounts. If you purchased the folding bars, rotate the bar so that the center oval opening is facing downwards towards the roof of the vehicle. Using the hex wrench supplied with the rack, tighten the clamp screw on each front bar mount. Your front cross bar should now be custom-fit to your vehicle; you can use it or remove it from the car (see “To Remove your Rack” below).

Repeat this process for the rear bar mounts and cross bar, mounting them just in front of the rear window.

Where to Attach

Monkey Bars are specifically designed to attach to a car’s roof top. Ideally, the vacuum mounts on your rack should be attached in the front and back corners of your car’s roof, where the roof is most solid. The metal in the middle of some car roofs may not be sturdy enough to support the weight of your rack and whatever you may be transporting.

Each vacuum mount on your SeaSucker rack should attach to clean, unobstructed metal or glass surface. The vacuum pads will not attach over a seam or other surface incongruity. Attaching your rack to a sunroof is done at your own risk and we recommend that you test the strength and suitability of your sunroof first.

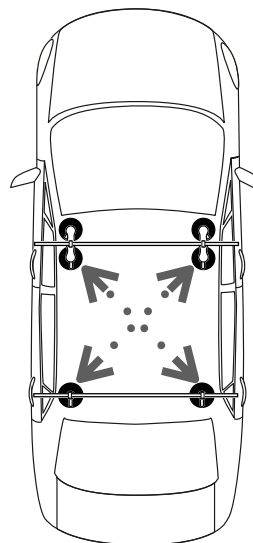

To Attach Your Monkey Bars (Clean, Wet, and Pump!)

Clean the surface you’re going to mount the rack to. Dust and dirt will affect your SeaSuckers’ ability to create and hold vacuum. Remove the protective cover from each SeaSucker and inspect the rubber vacuum cup for damage or dirt. Do not use your rack if there is any visible damage to the vacuum cup. If the vacuum cup is dirty, clean it with a mild soap and water solution and a soft cloth or sponge.

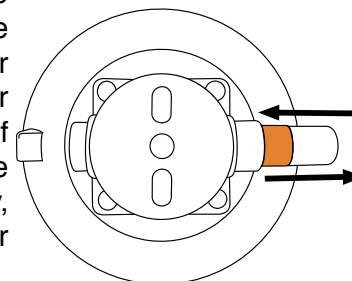

Moisten the bottom edge of each vacuum pad or the mounting surface with water - do not use cleaners, lubricants or other liquids; just water. Press the vacuum pad against the mounting surface to make a full seal; you may need to press firmly down on the body of the rack to ensure that the vacuum pad is fully connecting with the mounting surface when pumping. Pump the SeaSucker repeatedly until the plunger does not spring back and the indicator band is hidden inside the pump cylinder.

Repeat this for all SeaSuckers on the rack. If the plunger won’t stay seated in the pump cylinder or continues to extend out immediately after pumping, you may need to clean the mounting surface or the vacuum pad or pump, perform basic maintenance on the vacuum pad or pump, or move the vacuum cup to a more suitable mounting position. Do not use your rack without correcting the problem!

Check for the Indicator Band During Use

SeaSucker vacuum mounts are not intended to be permanent fixtures on your car - they will lose vacuum over time. When your vacuum cup loses vacuum, it will warn you by extending the pump's plunger, exposing an orange band. You are required to monitor your

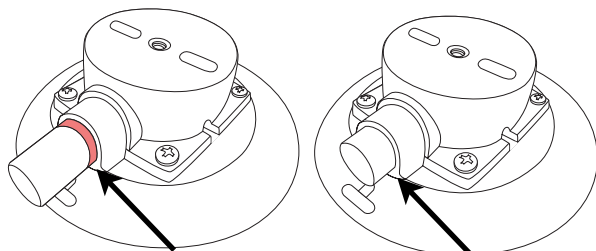

**Indicator band exposed:
time to re-pump!**

Full power!

vacuum mounts during use. When getting in or out of your car, check to see if the indicator band is visible on any of the rack's vacuum cups. If you see the band, simply pump the SeaSucker as described above.

If the indicator band appears less than four (4) hours after being pumped to full strength, either cleaning, maintenance or repositioning may be required. If your rack is mounted on a scratched surface, move the rack to a more suitable position. If the mounting surface or vacuum cup is dirty, clean it. If these steps don't stop the vacuum mount from losing vacuum prematurely, discontinue use until the problem is resolved. Replace the suspect vacuum cup with the spare that came with your rack if necessary - additional replacement parts can be purchased in the Replacement Parts section of our on-line store.

Strapping Cargo to You Monkey Bars

One of the great things about owning Monkey Bars is that you can carry almost anything you can strap to the bars. To secure cargo, such as surfboards, paddle boards, ladders, lumber, PVC pipes, or taxidermied alligators, remember this simple mantra: **OVER** the cargo, **UNDER** the bars.

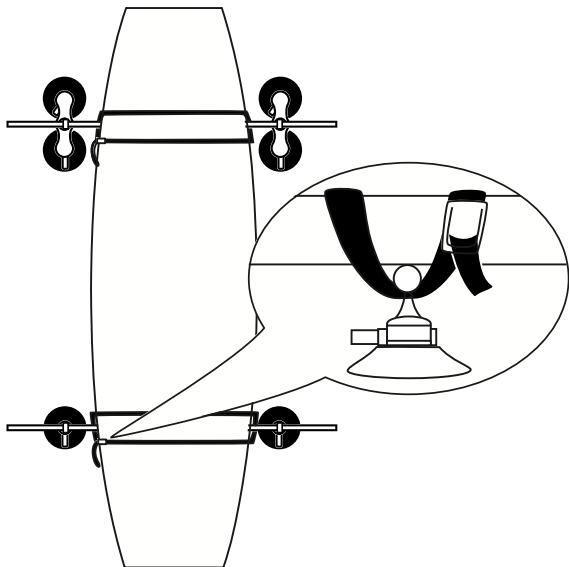

Weather Conditions

SeaSuckers can be used in cold weather. The vacuum pads will stiffen in colder temperatures. Because the vacuum pads need to conform to the mounting surface when you attach them, it is highly recommended that you store your rack at room temperature (60F+) prior to use. You will not be able to properly attach the vacuum mounts if they are too cold. Mounting surfaces must be free of ice, snow, dirt and any other potential obstruction to making a full vacuum seal.

Rain and wet weather should not affect the performance of your SeaSucker rack. If rain or water gets inside any of your vacuum pumps, pull the plunger out and dry the inside of the pump cylinder with a paper towel. Re-lube the plunger gasket if necessary and reinsert the plunger in the pump cylinder. Screws or other metal parts that show signs of rusting or corrosion should be replaced.

To Remove Your Rack: Lift and Cover!

With your fingertip, use one of the tabs on the SeaSucker's vacuum pad to lift the edge of each pad up from the mounting surface. This will break the vacuum seal.

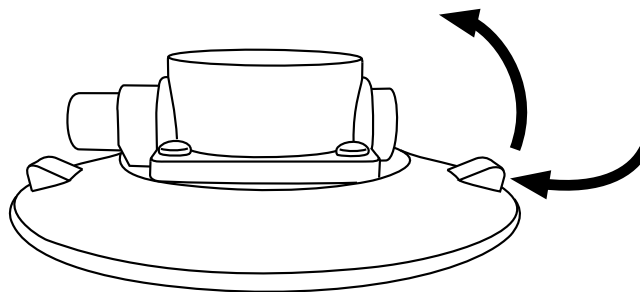

Always put the protective covers back on your SeaSuckers when the rack is not attached to your car to protect the rubber of the

vacuum pad from getting nicked or cut and to help the vacuum pad maintain its original shape. Make sure the vacuum pad is fully seated in the protective cover before storing it. The edge of the vacuum pad could be damaged or deformed if the protective cover isn't properly installed. If you lose or damage your protective covers, store your rack so that the vacuum cups do not come into contact with any object or surface.

Always check your straps after removing your rack. If you see signs of wear, fraying, or tearing, replace them before using your rack again.

Care and Maintenance

To get the most out of your SeaSucker rack, inspect it regularly and store it with the vacuum mounts' protective covers on. Check that all screws are securely tightened, including the screws attaching the vacuum pads to the SeaSucker housing, the screws attaching the SeaSuckers to the rack platform or bars.

Clean the vacuum cups before each use with a sponge or soft cloth, mild dish soap and water. Do not use harsh solvents or abrasive cleaning pads. Make sure there is no dirt or debris on the sealing edge (the bottom outside edge) of the vacuum pad. Inspect the sealing edge for stiffness, cracks, roughness, or cuts – a cut will allow air to leak under the cup and will prevent your SeaSucker from holding vacuum. A damaged vacuum pad should be replaced. One replacement SeaSucker comes with your rack. Additional replacement SeaSuckers, vacuum pads, and vacuum pumps can be purchased on-line at www.seasucker.com in the Replacement Parts section of our on-line store.

The vacuum pump should be cleaned regularly. To clean the pump, pull the plunger straight out of the pump cylinder. Clean the inside of the cylinder with dish soap and a soft cloth or paper towel. Make sure to dry out the cylinder – water left in the cylinder can cause the pump to make a popping noise when pumped and may interfere with the check-valve function of the pump.

The plunger should be wiped clean and the black rubber gasket at the tip of the plunger should be re-lubed with a thin layer of silicone-based gel lubricant, such as the Lube Tube that came with your rack. Additional tubes of Lube Tube can be found on-line in the Replacement Parts section at www.seasucker.com. After cleaning, push the plunger back into the cylinder and pump it several times to seat it properly and distribute the lubricant.

Repair and Replacement

Products with non-warrantable damage or products that are no longer within the warranty period may still be repaired or replaced at your expense. Discounted replacement parts, including vacuum pads, pumps, fork mounts and hardware, can be found on-line in the Replacement Parts section of SeaSucker's on-line store at www.seasucker.com.

Warranty

SeaSucker offers a lifetime, non-transferable warranty covering defects in materials and workmanship. Defective products can be returned to SeaSucker for replacement or repair (at SeaSucker's option). Warranty claims must be accompanied by a sales receipt or other proof of purchase document. The cost of transportation to and from SeaSucker for the repair or replacement of any defective part or accessory is not covered by this warranty and is to be paid by the owner. This warranty does not apply to damage or failure resulting from normal use, routine wear and tear, lack of maintenance, user error, alteration of the product, accidents, abuse, or neglect. This warranty is given in lieu of all other written or oral warranties, express or implied, including without limitation implied warranties of merchantability and fitness for a particular purpose, and are limited to the duration and specifications of this warranty. SeaSucker's liability for any damages relating to any allegedly defective product, whether arising from the use or the inability to use the product and whether claimed under tort, contract or any other legal theory, shall be limited to the actual price paid for such product and shall in no event include loss of use, loss of time, incidental, consequential, special, or indirect damages of any kind, even if SeaSucker is aware of the possibility of such damages, to the full extent as such may be disclaimed by law.

TROUBLESHOOTING GUIDE

Problem	What Might Be Wrong	How To Fix It
Slow Leakage	Dry mounting surface or vacuum pad	Moisten the mounting surface or the vacuum pad
	Nicks or cuts on vacuum pad	Replace the vacuum pad
	Dirt in pump	Clean and re-lube the plunger and pump cylinder
	Dry pump	Re-lube the plunger seal
	Dirt on vacuum pad	Clean the vacuum pad
	Dirty or uneven mounting surface	Clean the mounting surface or move to a more suitable spot
Severe Leakage	Dirty or uneven mounting surface	Clean the mounting surface or move to a more suitable spot
	Damaged pump	Replace the vacuum pump
	Nicks or cuts on vacuum pad	Replace the vacuum pad
Jammed or Sluggish Pump	Obstructed valve stem	Remove the obstruction; clean and re-lube the pump
	Dry pump	Re-lube the plunger seal
	Dirt in pump	Clean and re-lube the plunger and pump cylinder