



HYDRAULIC ZERO TURN MOWER LIFT- 500 LB. CAPACITY

Instructions for Part # ZTML-552

GENERAL GUIDELINES & SAFETY

- It is the user's responsibility to read and follow all instructions.
- Keep these instructions with the product at all times and review before each use.
- It is the responsibility of this product's owner to furnish the instructions to any person that borrows or purchases the product.
- Inspect the product before use to ensure it is assembled properly and all parts are in safe working order and free of defects.
- Never modify this product in any way.
- All circumstances cannot be addressed in these instructions.
- Please use common sense and practice general safety measures when using this product.
- Parts and/or instructions are subject to change without notice.
- Use of this product is limited to lifting, holding and lowering loads consisting of a single mower compatible with the lift platform. Incompatibility is evident when the loaded mower wobbles, appears unstable, and/or does not securely engage the wheel brackets.
- Only use this lift on a surface that is stable, level, dry and not slippery, and capable of sustaining the load. Keep the surface clean, tidy and free from unrelated materials and ensure that there is adequate lighting.
- Wear ANSI/CE approved safety goggles when operating the lift.
- Do not attempt to transport a load on the lift. The lift must only be used in a static position for lifting and lowering loads. Ensure that the load remains stable at all times.
- Immediately after lifting load, ensure lift mechanical loadholding device is engaged.
- Do not exceed the 500 lb weight limit.



PARTS

Tools Needed (not included): Phillips head screw driver, 19mm wrench, 14mm wrench.

Part	Description	Qty.
A	Handle	1
B	Base Frame	1
C	Support Arm	1
D	Stand Post	1
E	Tube	1
F	Support Arm Tube	1
G	Wheel Tray	2
H	Jack	1
I	Foot Pedal	1
J	Wheel	2
K	Flat Bar	2
L	Angled Bar	2
M	Wheel Tray Pin	2
N	Threaded Shaft	1
O	Long Pin	1
P	Short Pin	1
Q	Bent Pin	2
R	M12x90mm Hex Bolt	2

Part	Description	Qty.
S	M12x70mm Hex Bolt	2
T	M12x55mm Hex Cap Screw	6
U	M8x50mm Hex Cap Screw	3
V	12mm Locking Nut	12
W	8mm Locking Nut	3
X	12mm Washer	16
Y	12mm Heavy Washer	4
Z	8mm Washer	3
AA	E-Clip	2
AB	Spacer	2
AC	55mm Pin	1
AD	60mm Pin	1
AE	Cotter Pin	2
AF	Spring Pin	3
AG	R-Clip	2
AH	Split Ring Clip	2
AI	Rubber Cap	2

PARTS

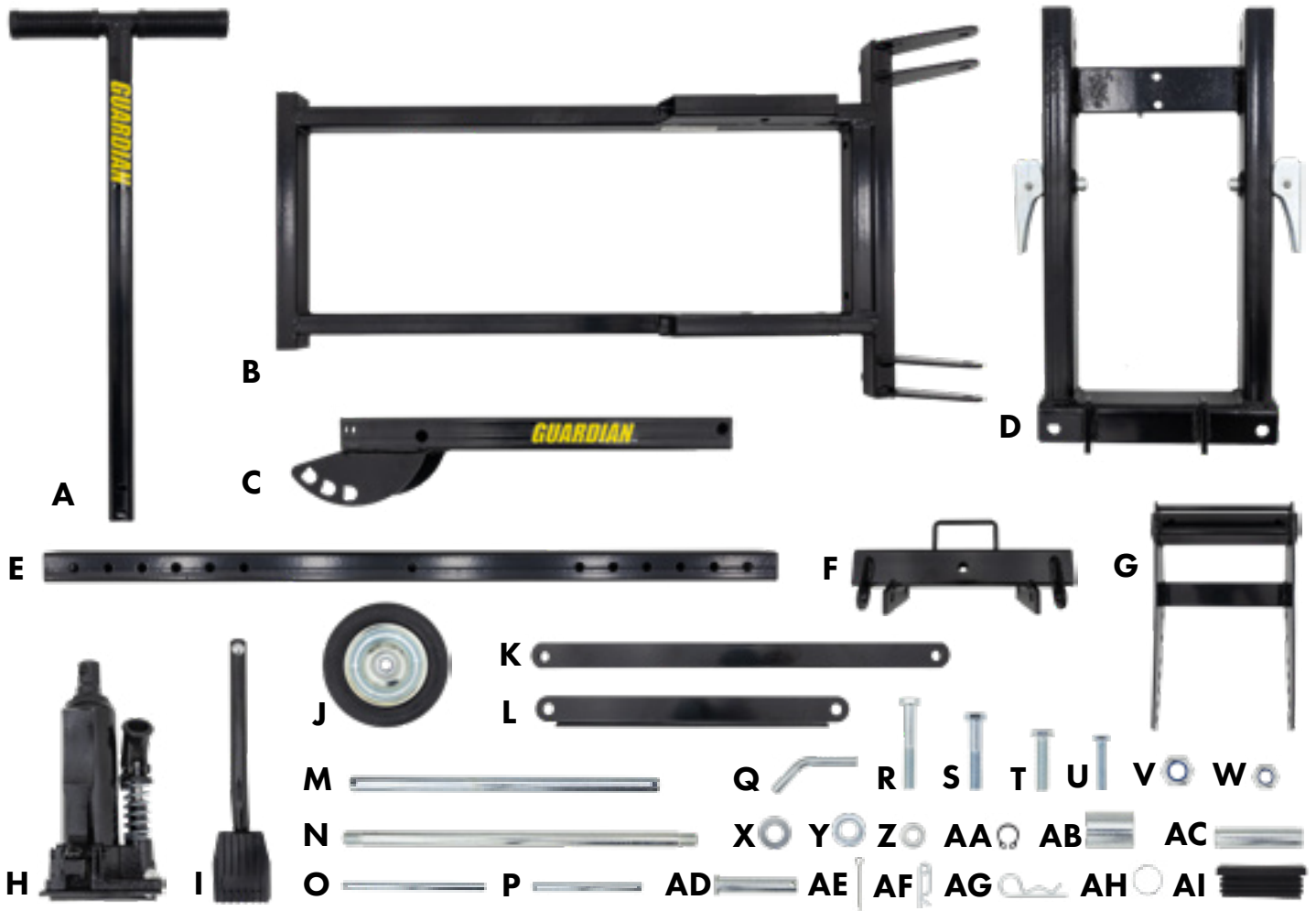

ASSEMBLY

STEP 1. Attach stand post (D) to the base frame (B) with two M12x90mm hex bolts (R), 12mm washers (X) and 12mm locking nuts (V).

SEE FIG. 1

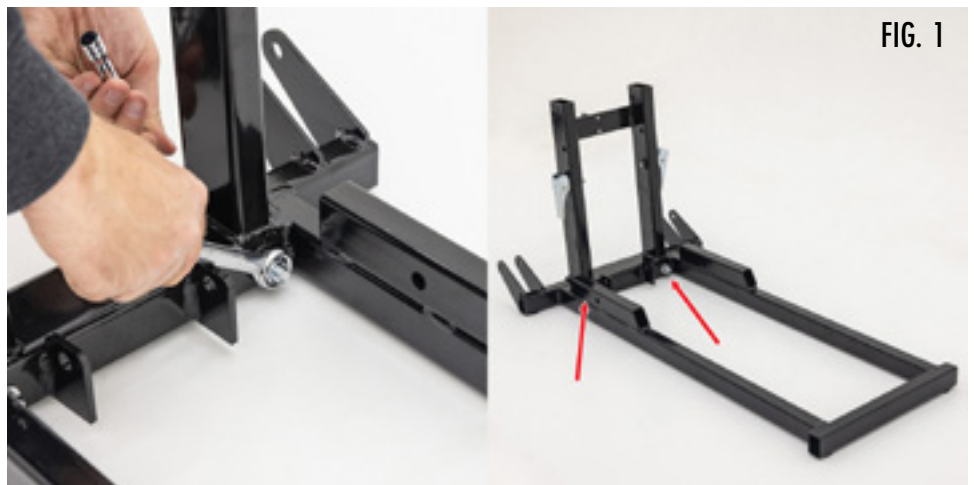

FIG. 1

STEP 2. Attach handle (A) to stand post (D) with three M8x50mm hex cap screws (U), three 8mm locking nuts (W) and three 8mm washers (Z).

SEE FIG. 2



FIG. 2

STEP 3. Attach jack (H) to post (D) with short pin (P) and two spring pins (AF).

SEE FIG. 3

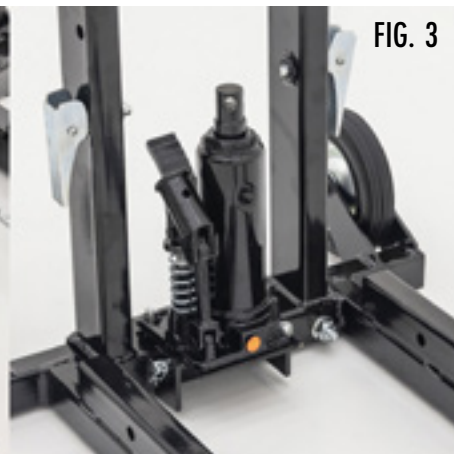

FIG. 3

STEP 4. Attach foot pedal (I) to jack (H) with the screw included on the foot pedal.

SEE FIG. 4



FIG. 4

STEP 5. Attach wheel (J) to base frame (B) with M12x70mm hex bolt (S), 12mm locking nut (V) and 12mm washer (X).

SEE FIG. 5



FIG. 5

STEP 6. Attach the angled bars (L) to base frame (B) with M12x55mm hex cap screws (T), 12mm locking nuts (V) and 12mm washers (X). SEE FIG. 6



STEP 7. Attach support arm (C) to stand post (D) and angled bar (L) with threaded shaft (N), 12mm locking nut (V) and 12mm washer (X). SEE FIG. 7



STEP 8. Attach jack (H) and support arm (C) with 55mm pin (AC) and E-clip (AA). SEE FIG. 8



STEP 9. Attach the flat bars (K) to stand post (D) with M12x55mm hex cap screws (T), 12mm locking nuts (V) and 12mm washers (X). SEE FIG. 9



STEP 10. Attach support arm tube (F) to support arm (C) with a long pin (O), cotter pin (AE) and 12mm washer (X).

SEE FIG. 10



FIG. 10

STEP 11. Attach flat bars (K) to support arm tube (F) with M12x55mm hex cap screws (T), 12mm locking nuts (V), 12mm washers (X), and spacers (AB).

SEE FIG. 11



FIG. 11

STEP 12. Slide the tube (E) through the support arm tube (F) and secure it with the 60mm pin (AD) and spring pin (AF).

SEE FIG. 12



FIG. 12

STEP 13. Slide the wheel tray (G) onto the tube (E) and secure with the bent pin (Q). Repeat on the other side. SEE FIG. 13

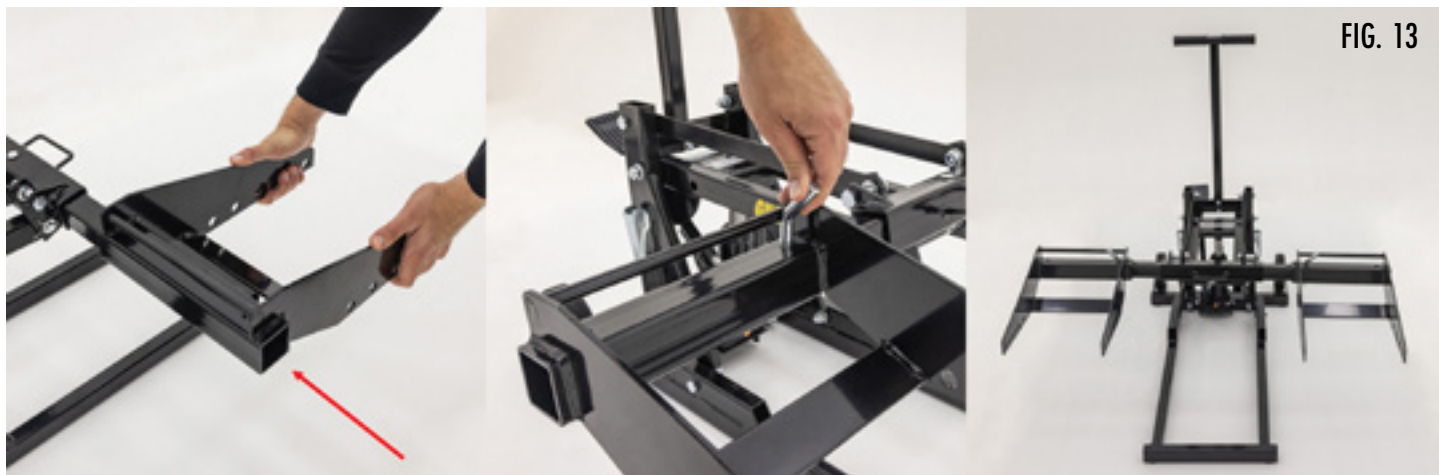

STEP 14. Attach the split ring clips (AH) to the wheel tray pins (M).
SEE FIG. 14



STEP 15. Slide the wheel tray pin (M) through the wheel tray (G) and secure with the R-clip (AG).
SEE FIG. 15

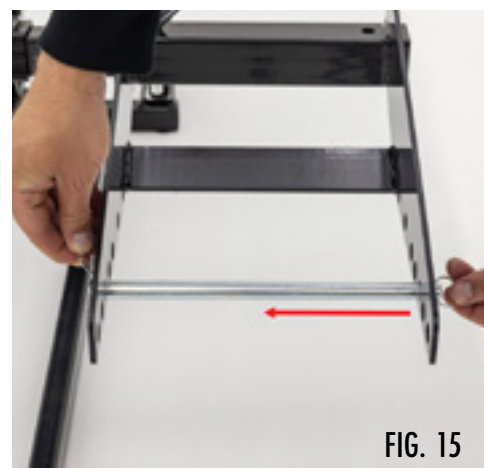

STEP 16. Insert the rubber cap (AI) into the stand post (D).
SEE FIG. 16

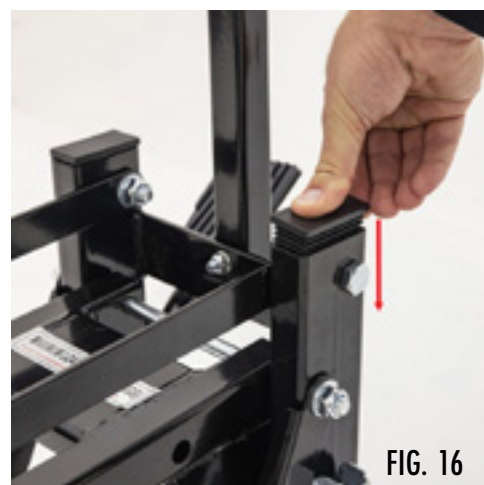

BEFORE USE

- Purge air away from hydraulic system.
- Manual operating system: With the lift in the lowest position, depress the release valve, then quickly depress lifting foot pedal 10-20 times to eliminate any air in the hydraulic system.
- Carefully and slowly, pinch oil fill plug to release trapped air.
- Place the lift on a suitable solid, flat surface.

OPERATION

To Raise the Vehicle

- **STEP 1.** Adjust the width of the wheel brackets to match the width of the mower wheels. Lock the brackets in place using the width pins.

Warning! Ensure the lift remains stable by adjusting the brackets so they are equidistant from the center of the lift.

- **STEP 2.** With the wheel bracket rods, adjust the depth of the wheel brackets to be slightly larger than the imprint of the mower wheels on the ground.
- **STEP 3.** Press the release pedal to lower the lift. Once the lift is fully lowered, release the release pedal.
- **STEP 4.** With the mower wheels straight, press the front of the wheel brackets against the front of the vehicle wheels.
- **STEP 5.** Push the wheel brackets under the wheels until both wheels rest in the center of the wheel bracket.
- **STEP 6.** Move the two safety lock levelers into the locked position to prevent unwanted movement.
- **STEP 7.** Use tie-down straps (sold separately) to secure the vehicle to the tie-down bracket.
- **STEP 8.** Holding the handle, pump the foot pedal with smooth, full strokes to raise the vehicle.
- **STEP 9.** Make sure the lift arm is locked in one of the three available positions before working on the vehicle.

MAINTENANCE

- Keep the lift clean and wipe off any oil or grease. Lubricate all moving parts.
- When not in use, the lift must be stored in the lowest position in a dry location to minimize ram and piston corrosion.
- Before each use, check all parts and ensure that all applicable bolts and nuts are firmly tightened. If any part of the lift is damaged or suspect, remove the lift from service and take necessary action to repair it.
- Periodically check the ram and piston for signs of corrosion. Clean exposed areas with a clean oiled cloth.
- When lift efficiency drops, purge away air from the hydraulic system.
- Check the hydraulic oil level. If not adequate, add hydraulic oil as necessary. Do not use brake fluid or any other improper fluid.
- If the lift needs repairing and/or there are any parts that need to be replaced, have it repaired by authorized and trained technicians and only use the replacement parts supplied by the manufacturer.

PRODUCT WARRANTY & LIABILITY

GENERAL PRODUCT WARRANTY: Products purchased from the Authorized Dealer (original place of purchase) or Merchant ("Dealer") will be free of defects in material and workmanship at the time of receipt, and will meet the specifications stated at the place of purchase transaction or online at the Dealer's website, under normal use and service when correctly installed, operated and maintained. This product warranty is effective for the period of time stated below, unless otherwise stated in the product instructions or depicted in the product advertisement. All Authorized Dealer warranties are NON-TRANSFERABLE and cover only the original end purchaser. This limited warranty does not cover products purchased through non-authorized dealers. Nonauthorized dealer receipts are not accepted for warranty verification.

*****WARRANTY CLAIMS MUST BE MADE DIRECTLY TO THE ORIGINAL PLACE OF PURCHASE.*****

WARRANTY PERIOD: This warranty remains in force for one year from the date of the product's accepted delivery. The Authorized Dealer offers a one year manufacturer's warranty for most products unless otherwise specified on the product advertisement.

WARRANTY SERVICE: The Authorized Dealer will replace any defective or malfunctioning part at no charge, including payment of the shipping costs of parts or replacement product to and from the manufacturer. The purchaser is responsible for labor charges. If the product does not meet specifications as depicted in the advertisement, the Authorized Dealer will refund the full purchase price of the product. Questions regarding the warranty on a specific product and warranty claims should be directed to the Authorized Dealer with whom the purchase transaction was made.

WARRANTY LIMITATIONS: The above warranty does not apply to products that are repaired, modified or altered by any party other than the Authorized Dealer; are subjected to unusual physical stress or conditions (such as overloaded ramps or corrosion), natural disaster, governmental actions, wars, strikes, labor disputes, riots, theft, vandalism, terrorism or any reason beyond reasonable control; are damaged due to improper installation, misuse, abuse, accident or negligence in use, storage, transportation or handling, or tampering; or to products that are considered consumable items or items requiring repair or replacement due to normal wear and tear. Product should be inspected prior to signing for delivery. Product damage incurred during shipping, unless noted on the Bill of Lading at the time of delivery, renders this warranty void.

LIMITED LIABILITY: In no event shall **THE AUTHORIZED DEALER** be liable to the purchaser or any third party for any indirect, incidental, consequential, special, exemplary or punitive damages arising out of the use of the product, including, without limitation, property damage, loss of value of the product or any third party products that are used in or with the product, or loss of use of the product or any third party products that are used in or with the product.