

# PET TRAVELING CAGE Installation diagram

## Erection sequence

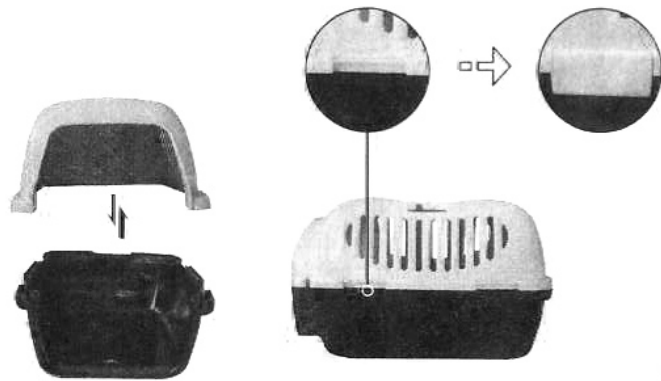

1. Put the cage top and the pedestal together in right place, and then fasten the five linkers to make the two parts fixed together.

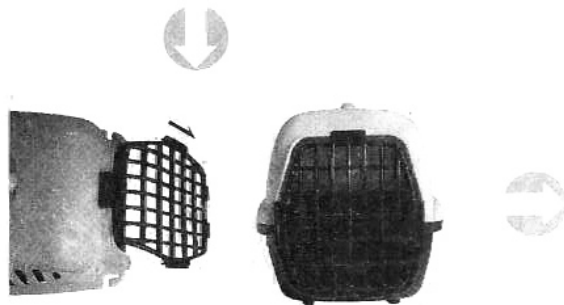

2. Put the fastener on the cage door on the slot in the cage top, and then pull downward the fastener with great efforts until it is buckled in the slot tightly.

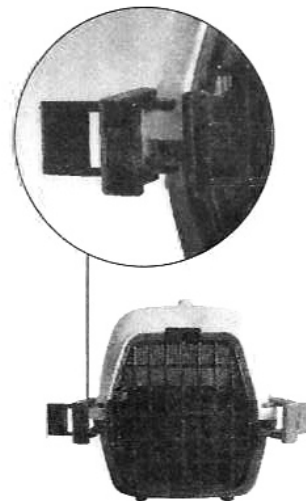

3. Put the switch of the cage on the left slot; pull the switch forward with great efforts until it gets stuck. Do the same to the right one.

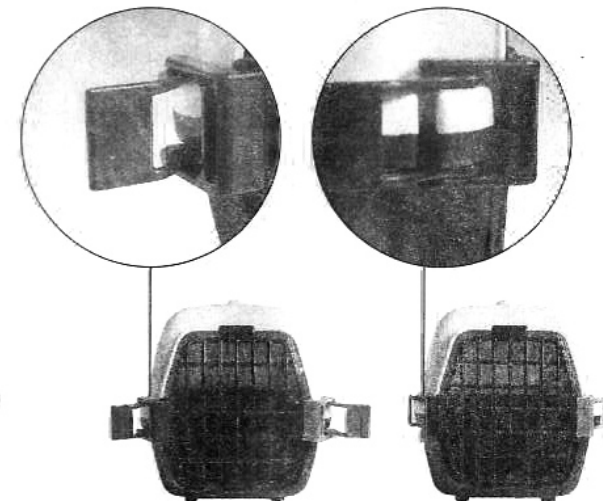

4. Get the switches hatched in the left and the right slots in the cage door; pull the switches backward with great efforts until they make the door fixed.

## Unit assembly drawing

