

# SWIVEL BASE HYDRAULIC LIFTING CRANE 1000LB

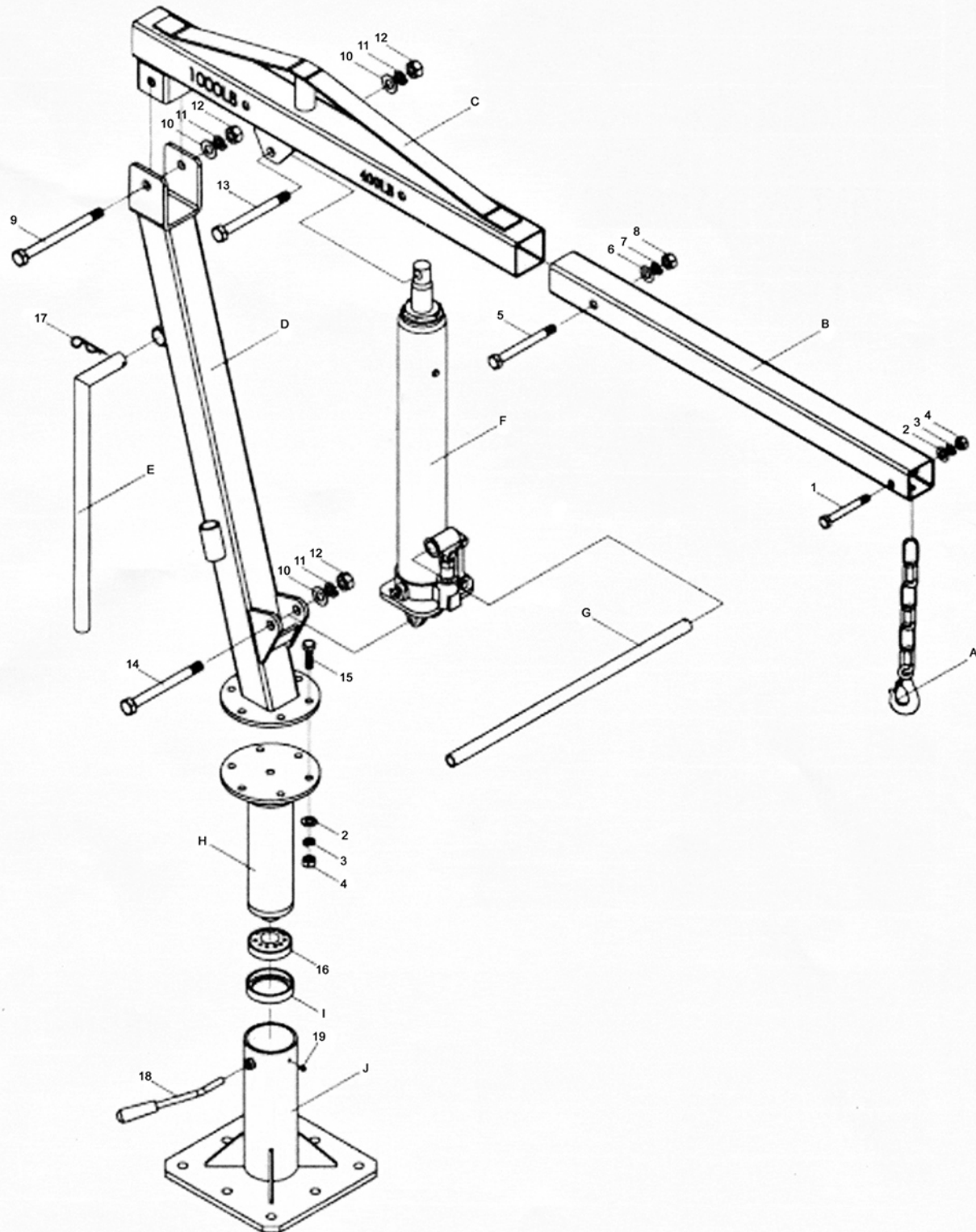

REF NO	DESCRIPTION	Q'TY
A	Chain & Hook	1
B	Boom Extension	1
C	Boom	1
D	Main Post	1
E	Handle	1
F	Jack	1
G	Jack Handle	1
H	Turntable	1
I	Wheel Hub	1
J	Base	1
1	Bolt M12 x 80	1
2	Flat Washer Ø12	7
3	Lock Washer Ø12	7
4	Nut M12	7
5	Bolt M14 x 90	1
6	Flat Washer Ø14	1
7	Lock Washer Ø14	1
8	Nut M14	1
9	Bolt M16 x 115	1
10	Flat Washer Ø16	3
11	Lock Washer Ø16	3
12	Nut M16	3
13	Bolt M16 x 85	1
14	Bolt M16 x 96	1
15	Bolt M12 x 35	6
16	Bearing	1
17	"R"Pin	1
18	Wheel Binding Bolt	1
19	Oil Cup	1