

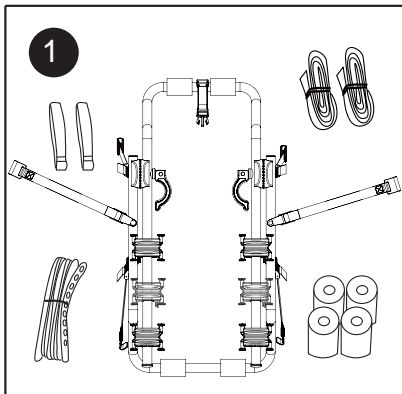

- 1 Rubber strap
- 2 Patented bike holder
- 3 Bike support arm
- 4 Hubs
- 5 Handle
- 6 Upper strap
- 7 Safety strap
- 8 Buckle
- 9 Protective foam pad
- 10 Middle strap
- 11 Bottom strap
- 12 Hook
- 13 Rubber foam

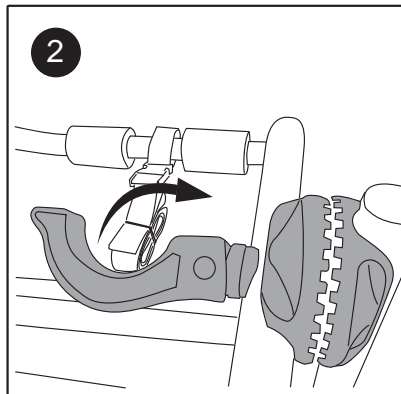

Thank you for purchasing bike carrier from us. First please check all items in the box: bike carrier, 6 rubber straps, 4 protective foam pad, 2 Velcro straps, and 2 tie down straps.



Loosen the black hubs by flipping the hub lever outward. This will allow the two sections of the rack frame to move relative to one another for correct placement on your vehicle.

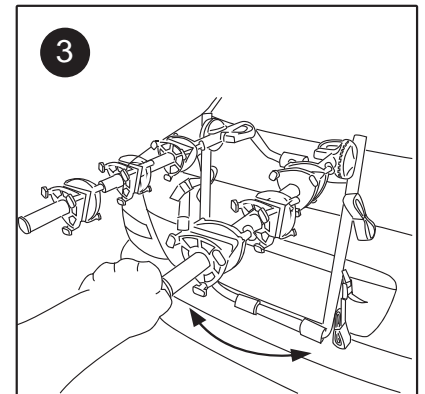

Rest the bike carrier on the rear bumper of vehicle. Note: the protective rubber pads on lower frame should rest between the bumper and trunk. Rear brace should rest on the trunk lid and the supporting arm should be adjusted 10 to 30 degree above the horizon.

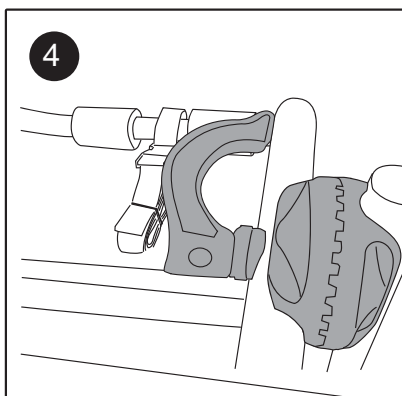

After the bike carrier is correctly placed as illustrated in diagram 3, tighten the black hubs by flipping the hub lever inward. Make sure the teeth of the black hubs are interlocked evenly.

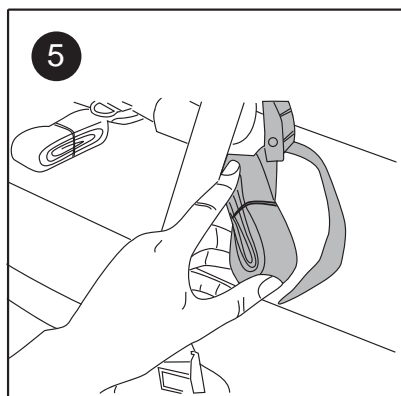

Begin attaching straps with the upper pair by pressing the buckle to release the strap.

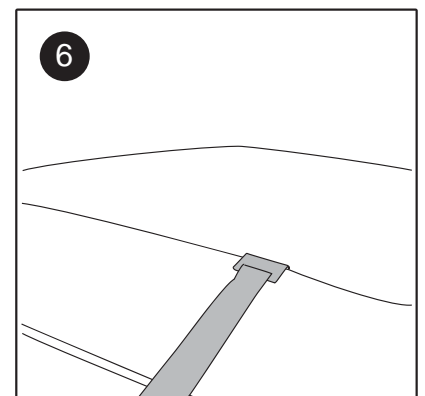

Placing the hooks in the most forward trunk lid opening (between rear window and trunk lid), and then pulling on the end of the strap until it is tight. Caution: Never install the hook on the plastic spoiler.

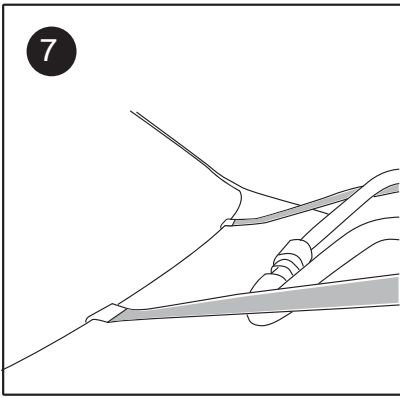

Follow the same procedure in diagram 6 for the other side.

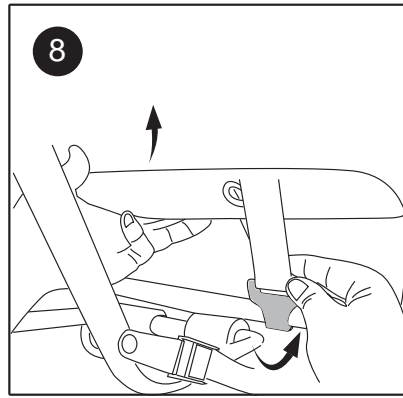

The bottom straps with hooks can be attached to the space between trunk lid and rear bumper. Caution: If it is necessary to open the trunk/tailgate to install hooks, make sure the trunk/tailgate is closed firmly after you install hooks.

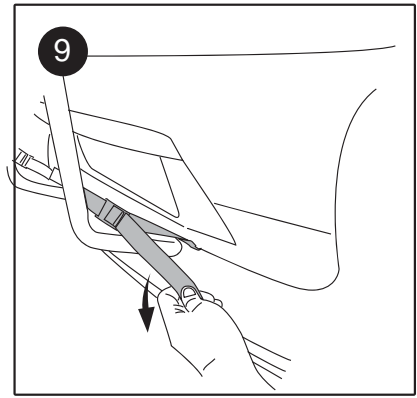

After the hooks are attached, pull them against the buckle until they are tight.

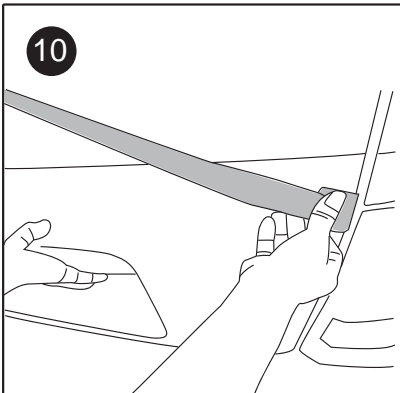

The side straps with hooks can be attached to the space between trunk lid and rear light. Caution: If it is necessary to open the trunk/tailgate to install hooks, make sure the trunk/tailgate is closed firmly after you install hooks.

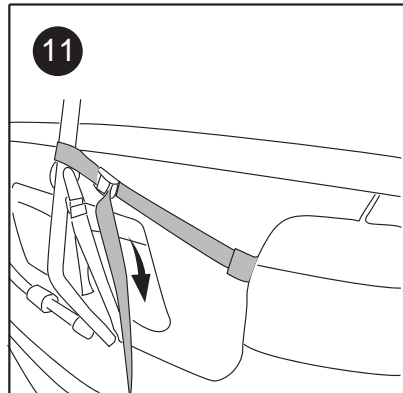

After the hooks are attached, pull them against the buckle until they are tight. Please double check the tension of all six straps, tighten them up if necessary.

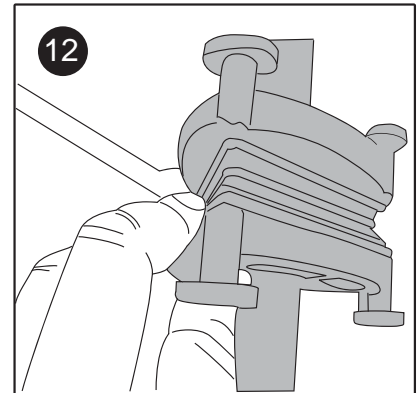

The bike holder is patented with multi-faced surface which features three diameter (1 inch, 1.25in, and 1.5 inch.) First, identify your bike's tube size for best fit. Then rotate the bike holder to preferred surface. Secure one end of the rubber strap to the knob of the bike holder. After bikes are mounted, secure the other end of the rubber strap.

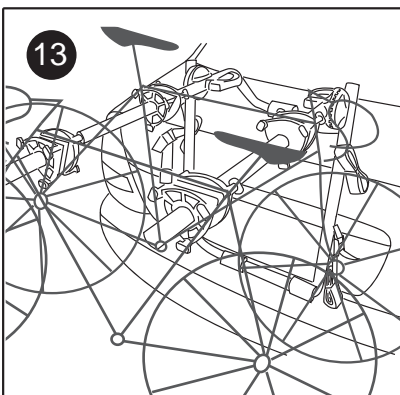

When you mount your bicycles on the bike carrier, please note the following points. First mount the heaviest bike, Then alternate the direction for the second bike. If your bike has Y frame (ex., lady bike) we recommend using bike beam which may secure the handle bar stem and seat tube.

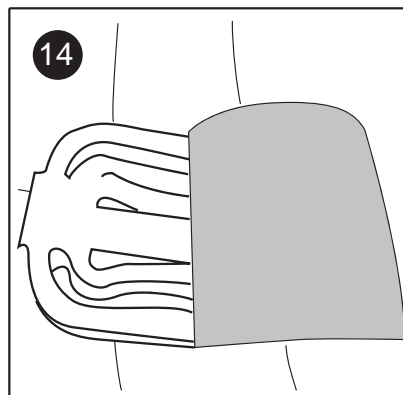

If there is any contact between car and bike carrier, we recommend using the protective foam pad.

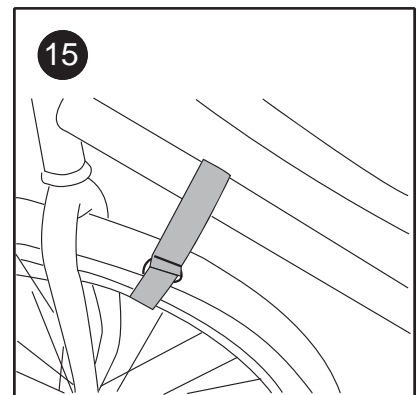

Using Velcro strap to secure front wheel and main frame can prevent the front wheel to wobble.

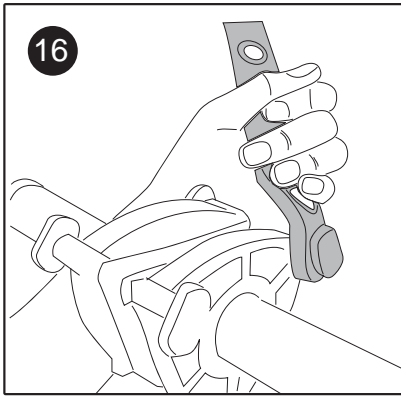

16 Snap the end of rubber strap into the protrusion part of the bike holder. Please double check if it is fully secured.

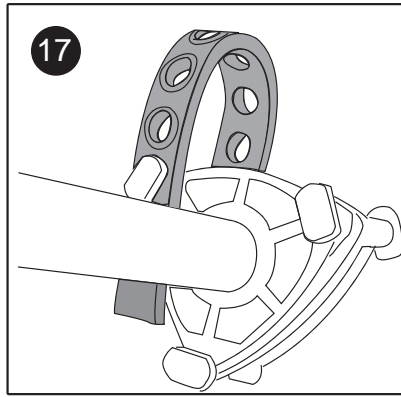

17 After the bike is mounted, pull the rubber strap over to the protrusion part on the other end of the bike holder. Double check if it is fully secured. Caution: overstretching shortens the life of rubber strap and may cause serious damage. It is recommended to check the rubber strap every time you mount the bikes. Replace worn straps with new straps from authorized dealers.

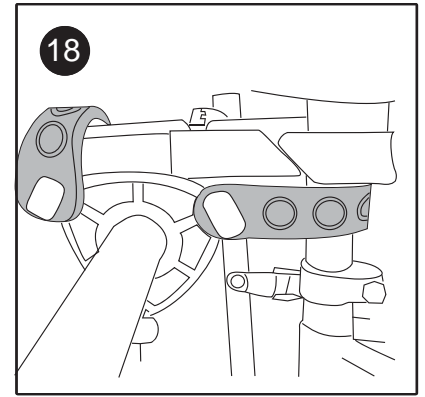

18 The patented bike holder can secure the bike's seat tube with additional rubber strap to prevent its wobbling during driving.

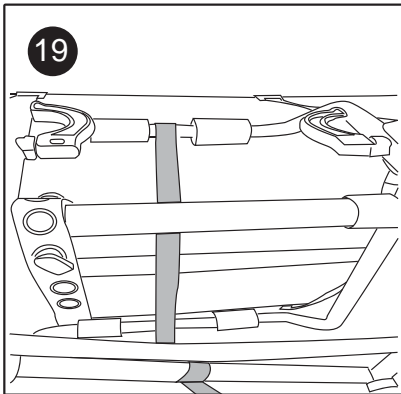

19 After mounting your bikes, please tie up the bikes with the integrated security strap.

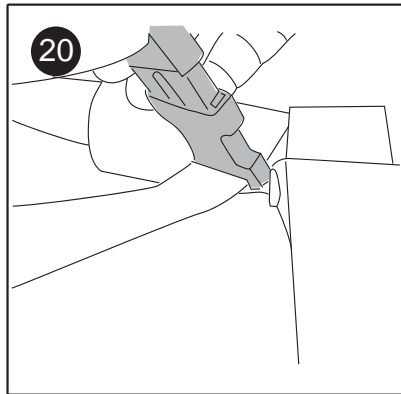

20 Then, insert the male end of buckle into the female end of buckle. Pull the strap until it is tight and make a knot around the buckle.

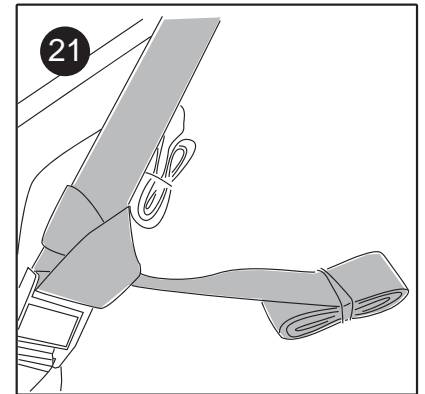

21 When all bikes are mounted, please double check the tension of each strap. If necessary, pull the strap against the buckle until it is tight. Make a knot around the buckle and tie the rest of the strap with the rubber band.

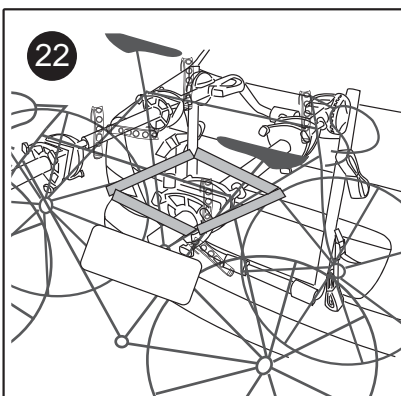

22 For additional safety, use the tie down strap to secure the bike to bike carrier. In addition, if the law requires that the license plate cannot be hidden, the auxiliary license board is recommended.

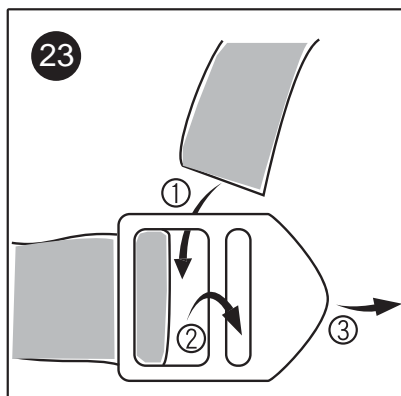

23 Diagrams shows how to secure the tie down strap with the attached buckle.

CAUTION

- 1.1 This carrier has been designed and manufactured to attach securely to a variety of vehicles. The attachment of this carrier to a vehicle is safety critical and beyond the control of the manufacturer. The user must therefore ensure that the cycle carrier is suitable for use with their particular vehicle and that both carrier and cycles are securely and safely attached to the vehicle.
- 1.2 Roof spoilers (made by ABS) may prevent the correct fitting of the cycle carrier as straps and carrier framework should be in contact with them when fitted.
- 1.3 During your journey, frequently check the tension of carrier fixing straps and the security of the cycles carried.
- 1.4 Be cautious that the bicycles and bicycle carrier do not come close to exhaust pipe of the vehicle.
- 1.5 The maximum load for this bicycle carrier is 45 kg. Do not over load.
- 1.6 Reduce the speed when on rough or dirt road.
- 1.7 This bicycle carrier is designed for temporary use only, remove when not in use or before going through a car wash.