



INSTALLATION / ASSEMBLY **INSTRUCTIONS**



BASE ASSEMBLY

'Ride-On; Get Off' ***Self-Standing / Floor-Stand*** ***Cycle Chock***

Model: 03-PMFSB-01 (B1)

(Part 1 of 2)

P/n 03-PMFSK-01 PROMAX Floor-Stand Kit

WARNING

BEFORE USE
PLEASE READ ALL WARNINGS AND
INSTRUCTIONS TO PREVENT SERIOUS INJURY

Feature Information

- The PROMAX Floor-Stand is specifically designed to bolt to the PROMAX Cycle Chock for 'Ride-On; Get-Off' self-stand feature for garage or shop areas.
- The PROMAX Floor-Stand can be purchased separately if you already own a Drop-Tail Trailer with PROMAX Cycle Chocks for 'Ride On; Get-Off Floor feature.
- The PROMAX Cycle Chock uses the same Three Arm Knob Screws to attach to all Drop-Tail Trailers, the PROMAX Floor-Stand and the Cycle Glyder Pro.

Installation Instructions

1. Carefully unpack contents from boxes & check for missing or broken parts. (If any parts are found to be missing or broken, please contact Drop-Tail Trailers @ 877-284-9008.)
2. Locate the PROMAX Floor-Stand Platform (1), Hex Bolts M6X20mm (2), Flat Washers 6mm (3) and Rubber Foot Pads (4). Install parts as shown in Exploded View on next page.

3. Locate PROMAX Cycle Chock assembly and mount to the Floor-Stand Base using the four Three Arm Knob Screws (9) as shown in the Exploded View. Ensure Knobs are firmly tightened to secure Cycle Chock to Floor-Stand.

NOTE: for proper mounting orientation, the back of the CYCLE Chock should be flush with the back side of the Floor-Stand.

4. Place PROMAX Cycle Chock / Floor-Stand assembly on a flat dry surface sufficient enough to handle the weight of motorcycle.

Operation Information

WARNINGS

- Before each use, check that the CYCLE CHOCK and Floor-Stand are in proper working condition.
- Use CYCLE CHOCK and Floor-Stand only on a dry level surface able to handle the weight of motorcycle.
- Do not let children play on or around CYCLE CHOCK Floor-Stand when loaded or unloaded.

IMPORTANT!!

- Before use, locate and read the PROMAX CYCLE CHOCK Installation / Operators Manual for proper usage and Cycle Chock Wheel adjustment. **NOTE:** Ensure Pivot Cups pivot point is to the upper set of holes for Floor-Stand application as noted in Cycle Chock Manual.

Exploded View / Parts List

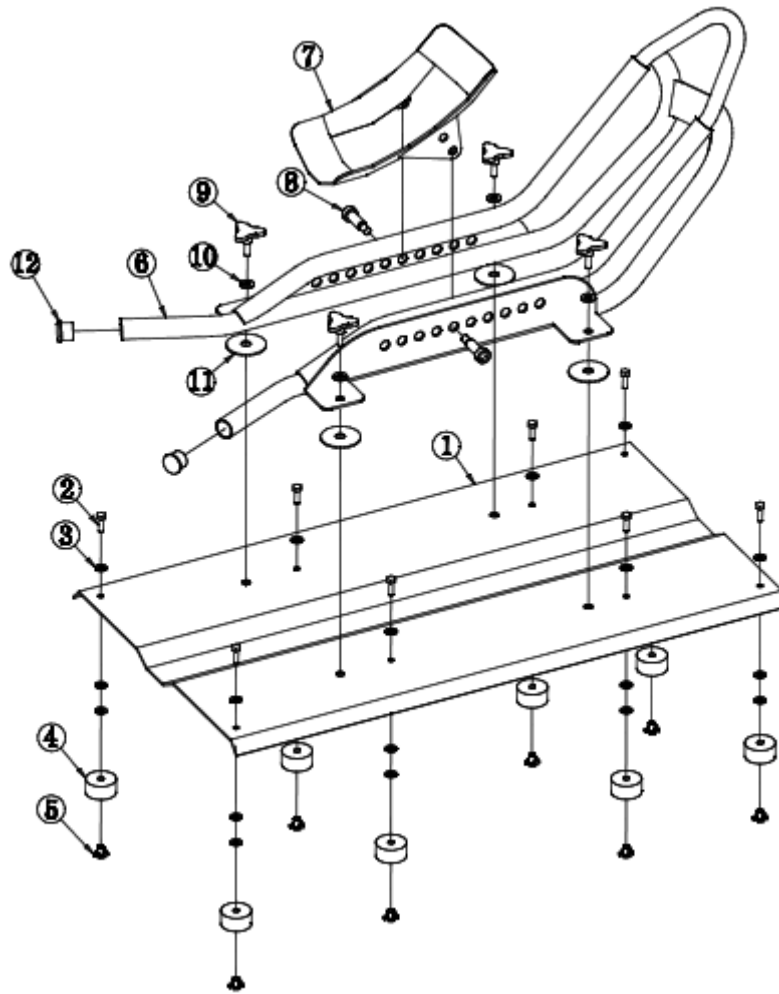

Item	Part Number	Description	Qty
1	PW-1002	PROMAX Floor-Stand Platform	1
2	10060202W	Hex Bolt M6x20mm	8
3	30060012W	Flat Washer ϕ 6mm	24
4	PW-1021	Rubber Foot Pad	8
5	43060002W	Tee Nut w/ Prongs M6mm	8
6	DT2200-7110(A)	Tubular Main Frame, PROMAX WC(A)	1
7	DT2200-7120	Pivot Cup Weldment	1
8	13121388B	Shoulder Bolt 1/2"x1-3/8", 3/8"-16x5/8"	2
9	92080202W	Three Arm Knob Screw M8x20mm	4
10	30080012W	Flat Washer ϕ 8mm	4
11	DT2200-7131	Rubber Washer	4
12	92270012B	Plastic Plug ϕ 27	2

LIMITED WARRANTY POLICY

Limited Warranty Periods

- **Hunting Equipment:** 1 Year (12 months) from the date of purchase.
- **Trailer Products:** 1 Year (12 months) from the original date of purchase.
- **Hydraulic Cylinders, Rams, Hose Assemblies, and Fittings:** 2 Years (24 months) from the date of purchase.
- **Sub-component Items:** Many sub-component items are warranted separately by the respective manufactures and are covered by warranty of their manufacturer. Examples of such items may include safety harnesses and tie-down systems, wheels, tires, axles, bearings, lights, straps, chain, hardware and like items. The sub-components original manufactures product warranty supersedes and takes precedence over this limited warranty policy.

NOTE: ALL WARRANTY CLAIMS MUST BE PREAPPROVED BY THE MANUFACTURER (THE COMPANY) TO BE VALID.

Products are warranted to be free of defects in materials and/or workmanship for the warranty period. Under this limited warranty, the Company shall be limited to repairing or replacing, at its option, for the warranty period, those parts returned to the factory, freight prepaid, which in the opinion of the Company shall prove to be defective in materials or workmanship, under normal use and service. This warranty will not apply unless the product is installed, used and maintained in accordance with the Manufacturers installation, operation and maintenance instructions.

This warranty applies to the **ORIGINAL** purchaser only, and is non-transferable. The Company warrants the products to be free of defects in material and workmanship but, does not cover normal maintenance or adjustments, damage or malfunction caused by: improper handling, installation, abuse, misuse, negligence, carelessness of operation or normal wear and tear. In addition, this warranty does not cover equipment when repairs or alterations have been made or attempted without the express written consent of the company. Product repairs not covered by the warranty, and product updates, will be provided at the prevailing rate.

The Company is not responsible for damage caused by accident, negligence, abuse, overloading, misapplication, or misuse of the products. It is solely the purchaser's responsibility to determine the suitability of these products for the particular application. **Limitations:** All other obligations or liabilities, including incidental or consequential damages or contingent liabilities arising out of the failure of any parts to operate properly are hereby excluded, including but not limited to any damages resulting from loss of use, inconvenience, loss of time, commercial loss, or any other type of damages general or specific, foreseen or unforeseen, unless applicable state law provides otherwise.

THIS WARRANTY IS EXCLUSIVE AND IS IN LIEU OF ALL OTHER WARRANTIES EXPRESSED OR IMPLIED INCLUDING ANY IMPLIED WARRANTY OR MERCHANTABILITY OR ANY IMPLIED WARRANTY OF FITNESS FROM A PARTICULAR PURPOSE, AND ALL SUCH IMPLIED WARRANTIES ARE EXPRESSLY EXCLUDED.

THE REMEDIES DESCRIBED ARE EXCLUSIVE AND IN NO EVENT SHALL THE COMPANY, NOR ANY SALES AGENT OR OTHER COMPANIES AFFILIATED WITH IT OR THEM, BE LIABLE FOR SPECIAL CONSEQUENTIAL OR INCIDENTAL DAMAGES FOR THE BREACH OF OR DELAY IN PERFORMANCE OF THIS WARRANTY. THIS INCLUDES, BUT IS NOT LIMITED TO, LOSS OF PROFIT, RENTAL OR SUBSTITUTE EQUIPMENT OR OTHER COMMERCIAL LOSS.

This warranty shall be governed by the laws of the State of Texas, and shall be subject to the exclusive jurisdiction of the Court in the State of Texas in the County of Tarrant.

RETURNS: Products may not be returned without written approval (Return Material Authorization) from the Company.

Direct Outdoor Products, Drop Tail Trailers, United Hydraulics, LLC
Rev04152008